

Contents

Select Language ▼

Powered by [Google Translate](#)

Reverse Beeper Kit

P/N 2883246

Before You Begin

Read these instructions and check to be sure all parts and tools are accounted for. Please retain these installation instructions for future reference and parts ordering information.

Application

Verify accessory fitment at [Polaris.com](#).

Kit Contents

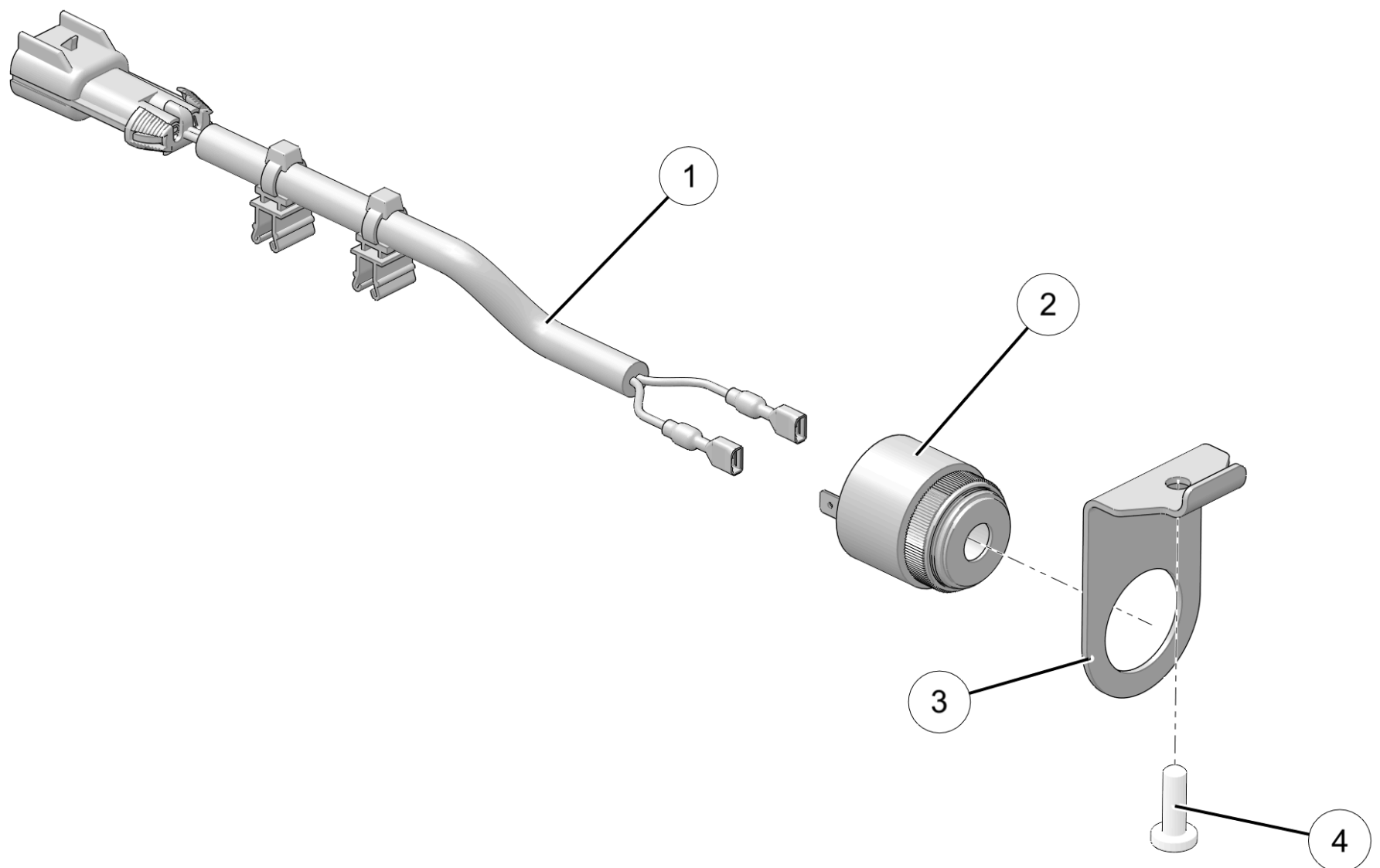

Ref	Qty	Part Description	Part Number
1	1	Harness	2414105
2	1	Reverse beeper	4013256
3	1	Bracket	5265267
4	1	Screw, Torx® Pan Head, High/Low - #14 X 0.75	7519731

Harness Detail

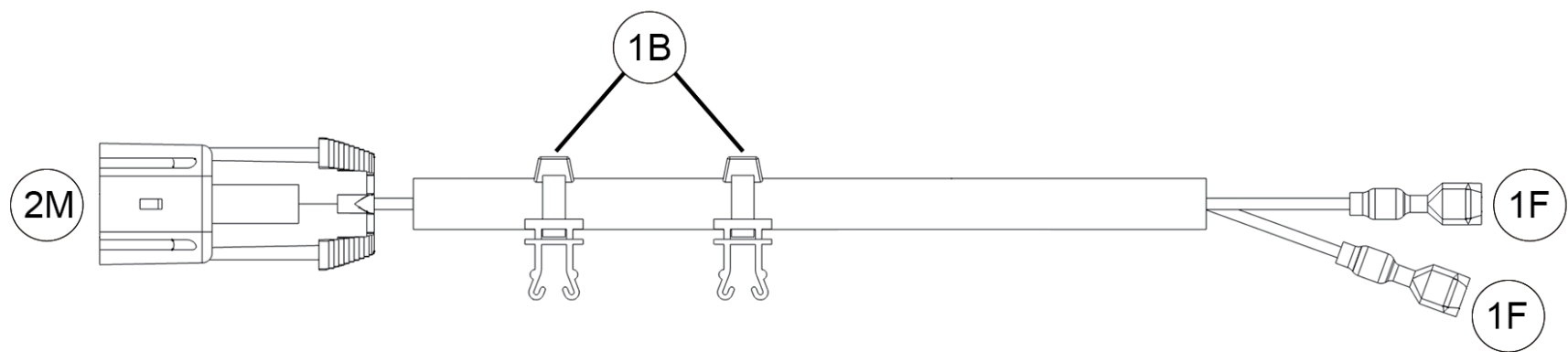

Ref	Part Description	Connects to
2M	Connector, Reverse Beeper	Main vehicle harness breakout; see instructions for detail
1B	Clip, Edge (Routing)	Vehicle structure
1F	Terminal, Blade, Reverse Beeper B+	Reverse beeper (4), positive (+) terminal
1F	Terminal, Blade, Reverse Beeper Ground	Reverse beeper (4), negative (-) terminal

Example: 16F = 16 pin, Female / 16M = 16 pin, Male (Male terminal fits inside female terminal)

Tools Required

- Safety Glasses
- Screwdriver Set, Torx®

Important

Your Reverse Beeper Kit is exclusively designed for your vehicle. Please read the installation instructions thoroughly before beginning. Installation is easier if the vehicle is clean and free of debris. For your safety, and to ensure a satisfactory installation, perform all installation steps correctly in the sequence shown.

Installation Instructions

General

1. Park vehicle on a flat surface.
2. Shift vehicle into PARK.
3. Turn key to OFF position and remove key.

Accessory Installation

1. Install bracket (3) to lower bed surface using screw (4). Do not over-tighten screw.

NOTICE

View looking up at rear of bed.

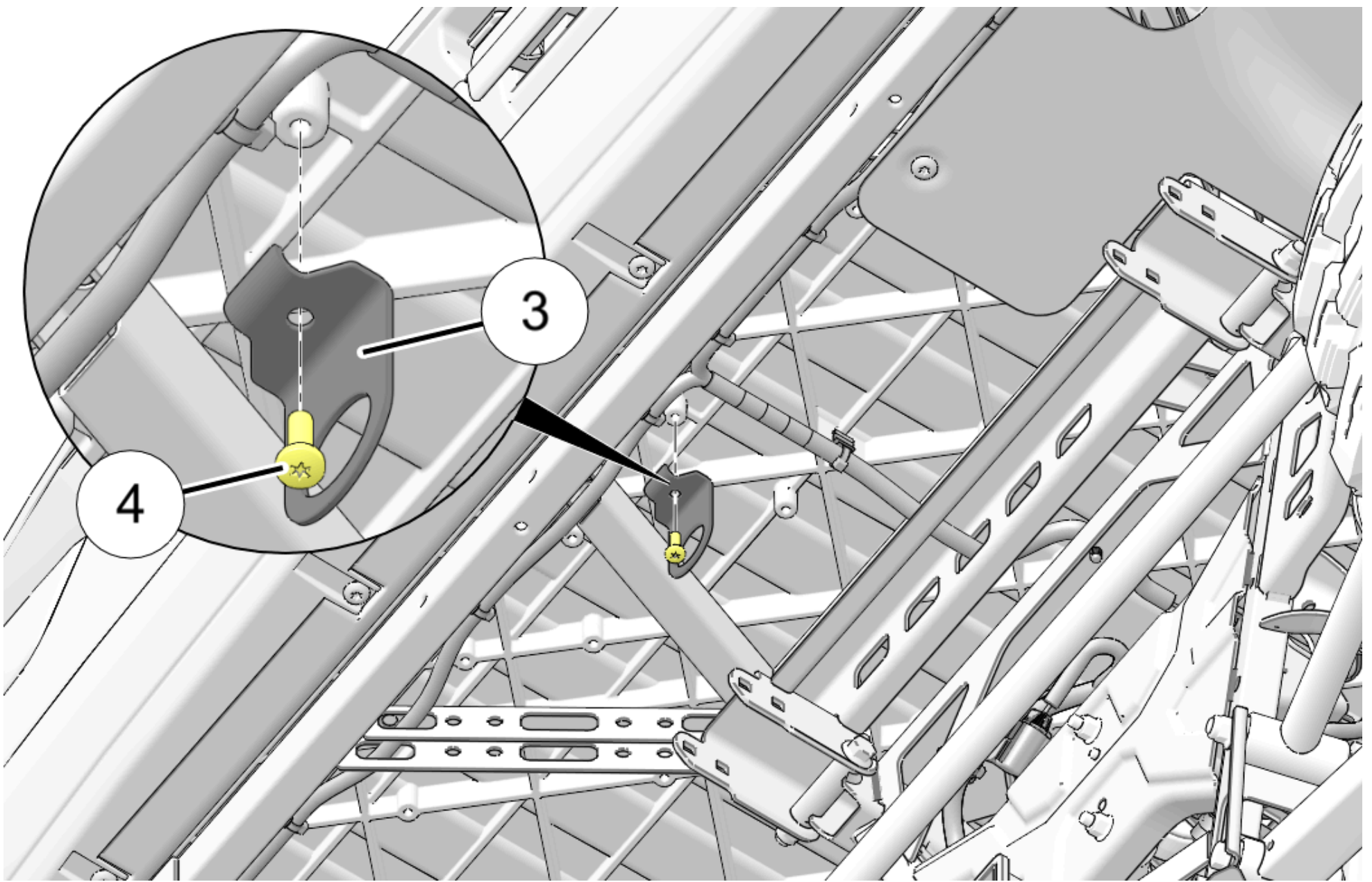

2. Connect harness ① to reverse beeper ②:

1. Connector 1F (red/blue wires) to reverse beeper positive (+) terminal
2. Connector 1F (white/black wires) to reverse beeper negative (-) terminal

NOTICE

See previous section, **HARNES DETAIL**, for connector identification.

Unlabeled (middle) terminal on reverse beeper not used.

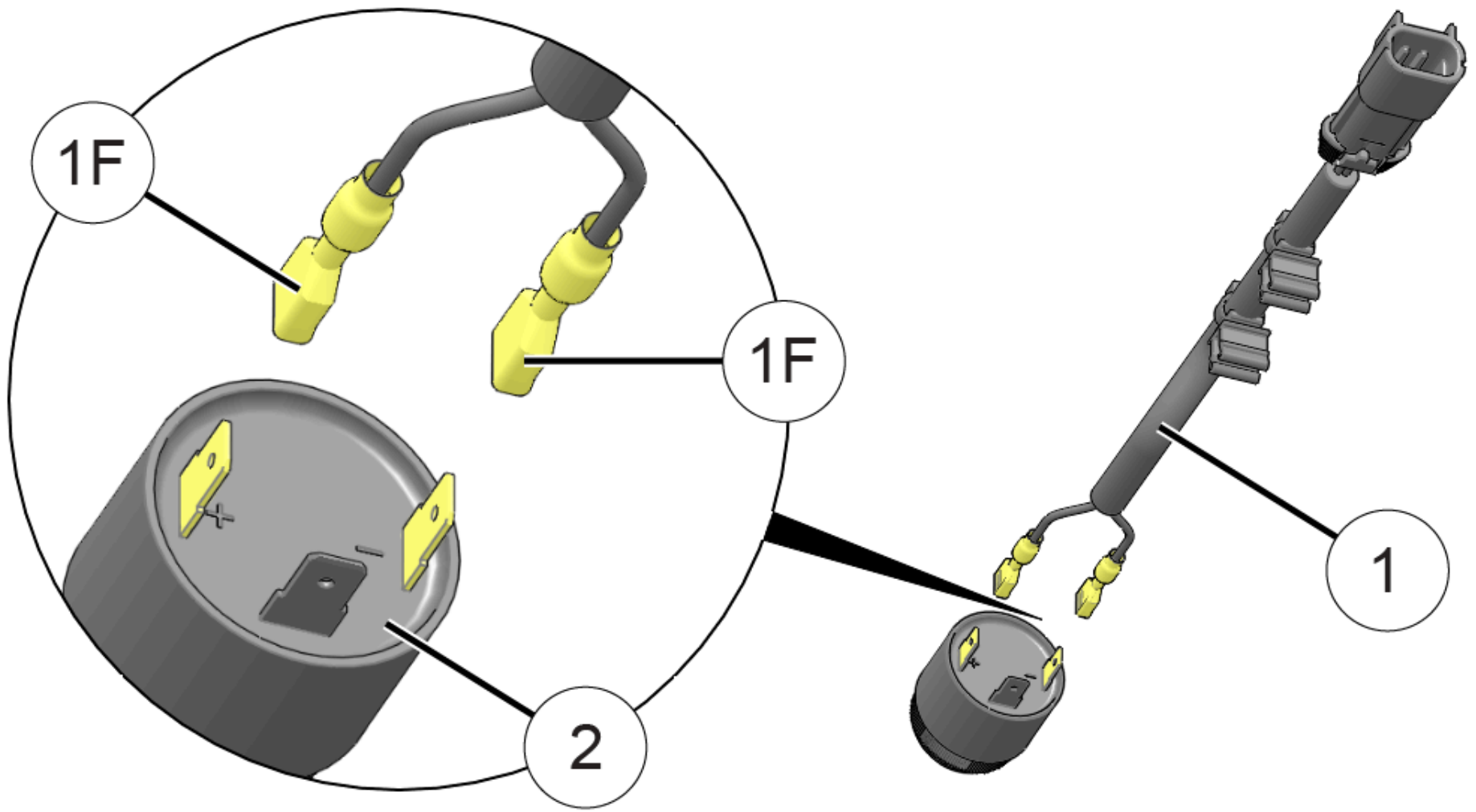

3. Remove knurled nut from reverse beeper (2), install beeper rearward through hole in bracket (3), then reinstall and tighten knurled nut.

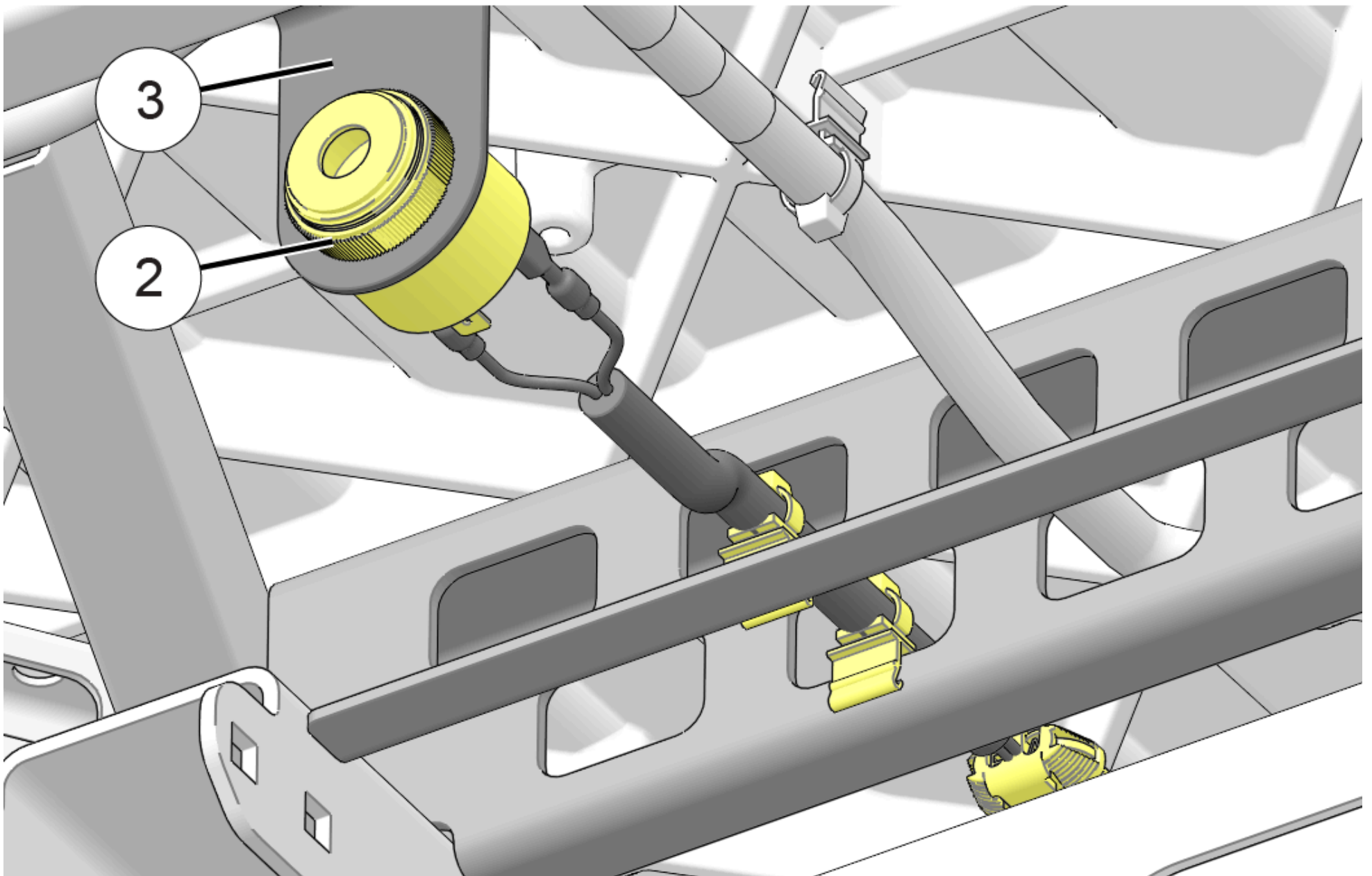

4. Route connector 2M rearward through openings in bed crossmember, then secure harness to crossmember using two edge clips 1B.

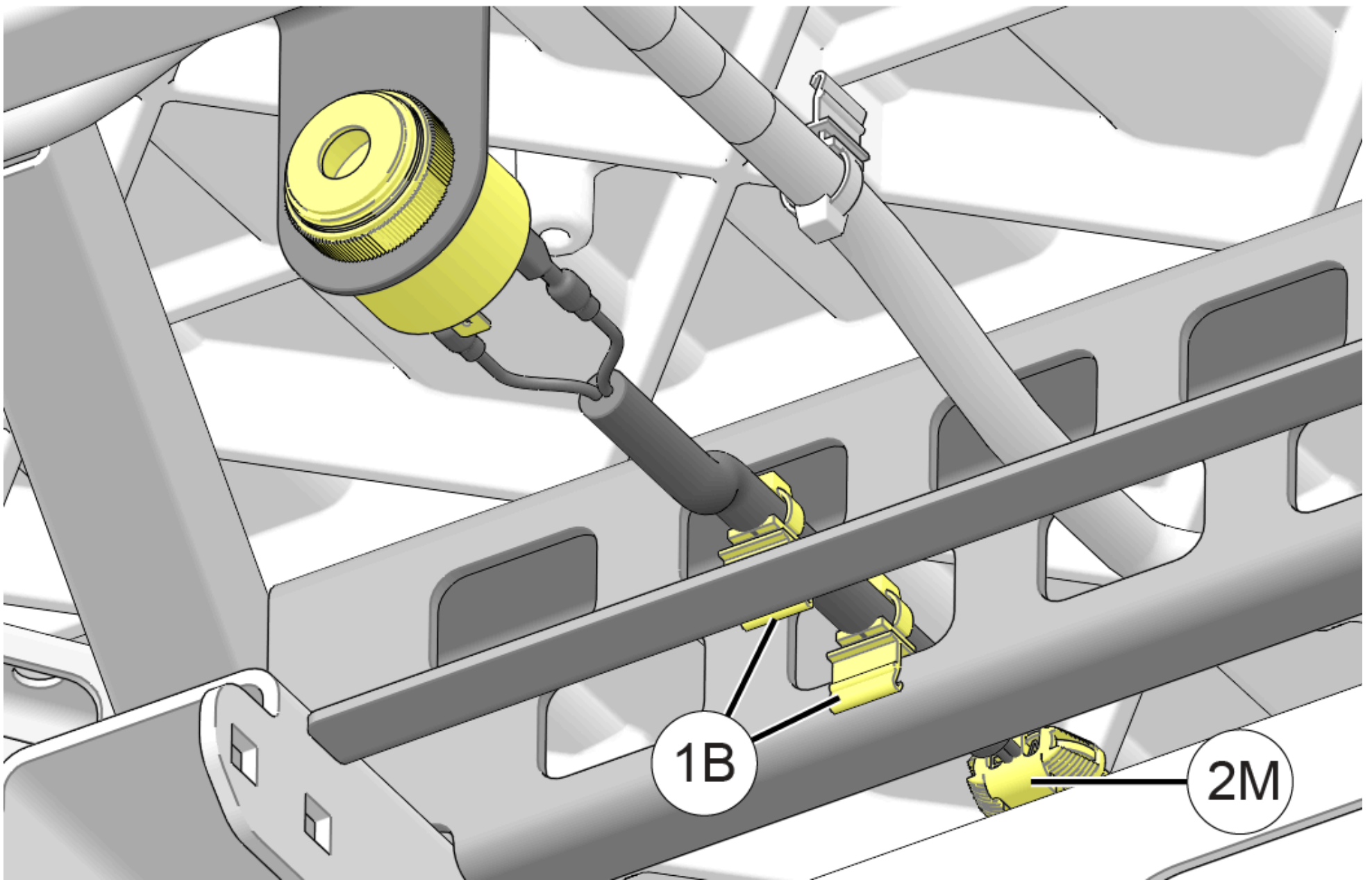

NOTICE

On Kinetic models, route connector 2M through triangle-shaped opening then connect to A. Do not route through bed crossmember. Secure harness to edge of bed crossmember using 1 edge clip, the second edge clip is not used.

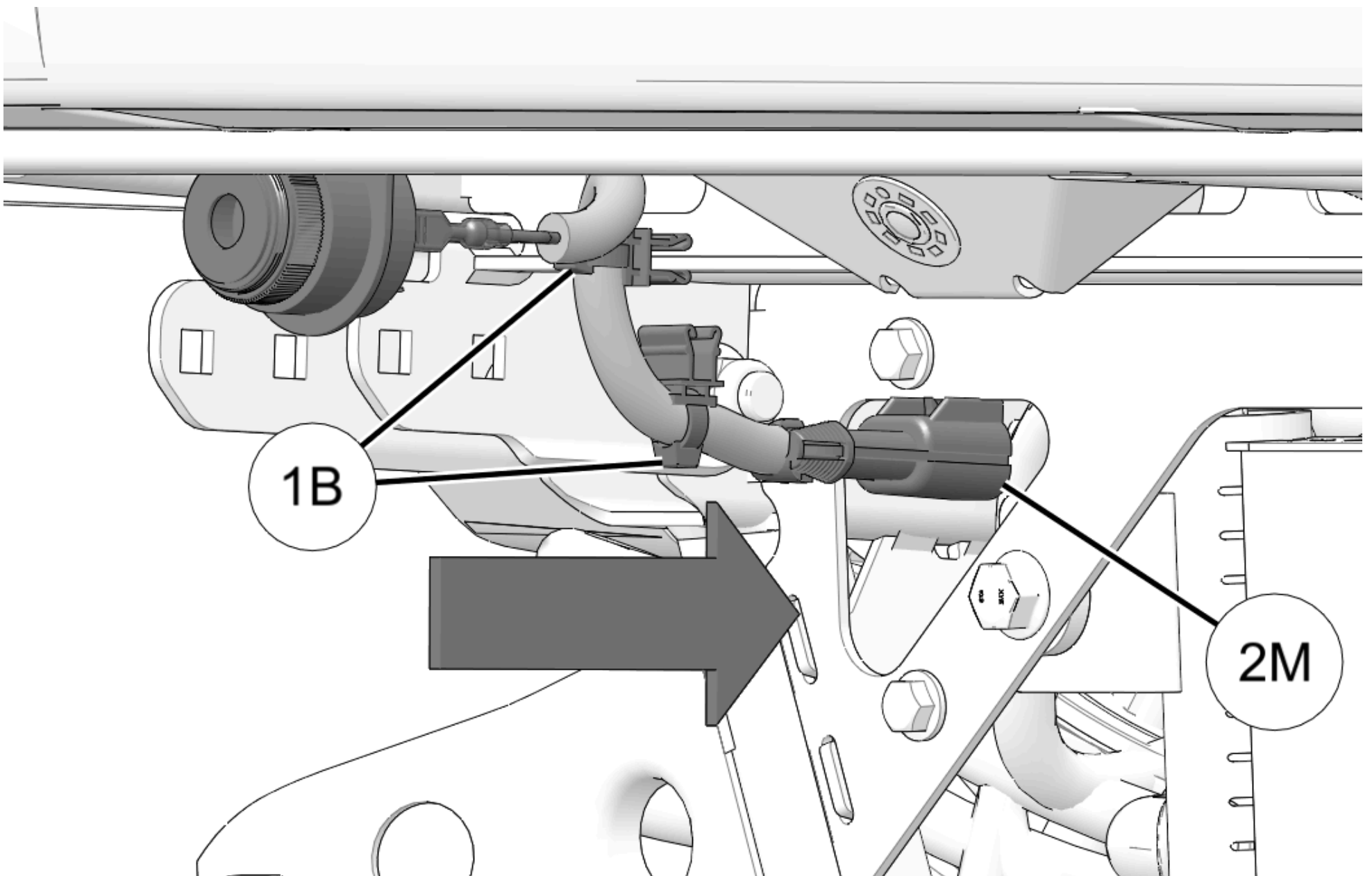

5. Locate reverse beeper connector (A) on main harness breakout. Remove connector from cap (B), then join to connector 2M to connector (A). Make sure adequate slack exists to permit full bed opening without harness tension.

NOTICE

Cap will not be used, but can remain secured to main vehicle harness with existing cable tie.

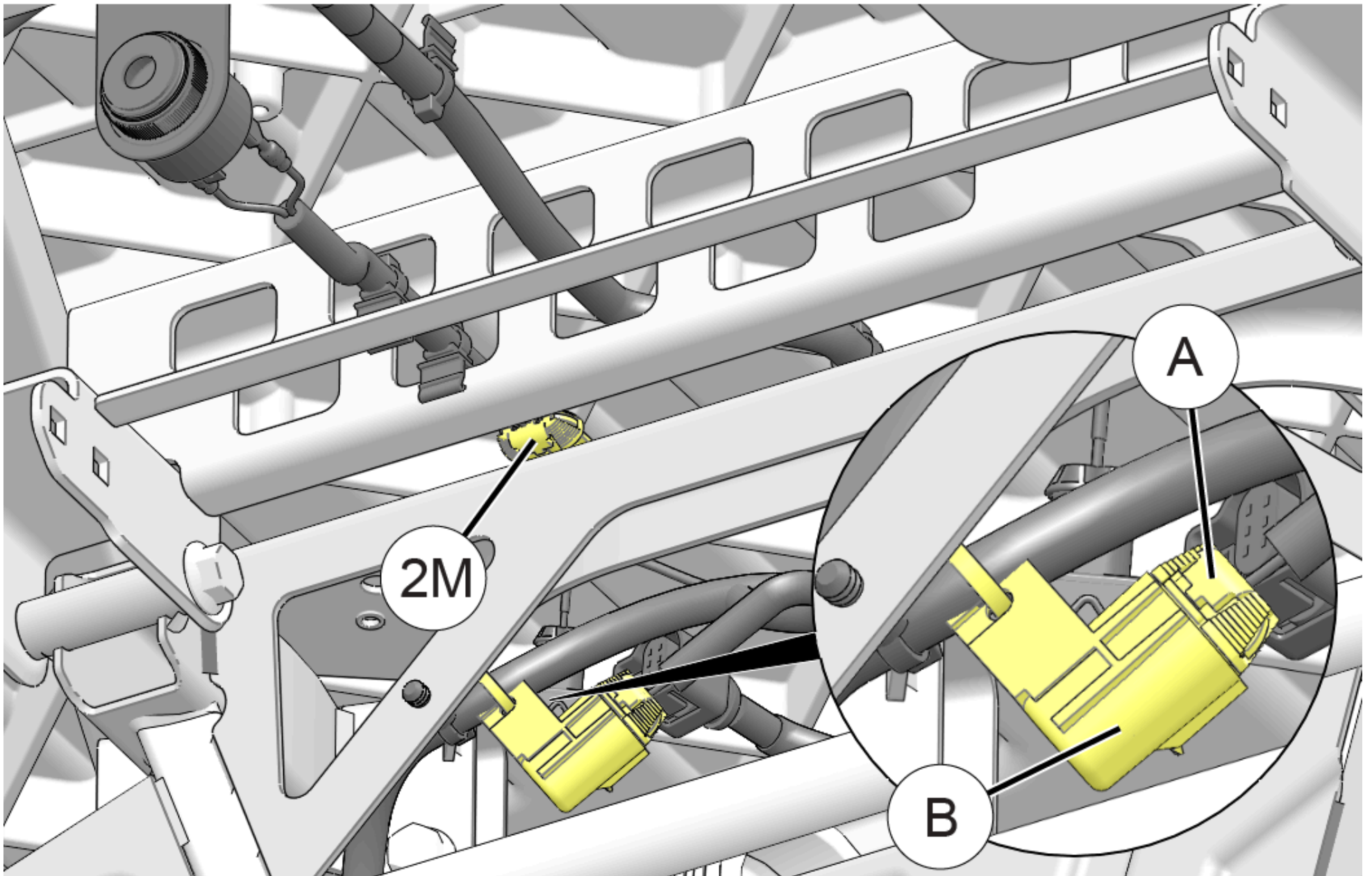

6. Slowly raise vehicle bed to ensure harness routing does not allow contact with hot components, sharp edges, or moving parts. If so, adjust routing and/or secure harnesses as required.

Feedback Form

A feedback form has been created for the installer to provide any comments, questions or concerns about the installation instructions. The form is viewable on mobile devices by scanning the QR code or by clicking [HERE](#) if viewing on a PC.



[Site Map](#)

[Privacy Policy](#)

[Accessibility](#)

© 2025 Polaris Inc.