

Contents

Select Language 

Powered by  **Translate**

Crew Roof Panel Kit

P/N 2890333

Missing or Damaged Parts

Before beginning assembly, inspect the kit and its component(s) to be sure all parts and tools are accounted for and not damaged. If missing parts or parts are damaged, please contact your Selling Dealer for assistance.

If your accessory was purchased online, please contact POLARIS® customer service at **1-800-POLARIS** (US & Canada only).

Application

Verify accessory fitment at www.polaris.com.

Kit Contents

Roof Kit Detail P/N 2890333

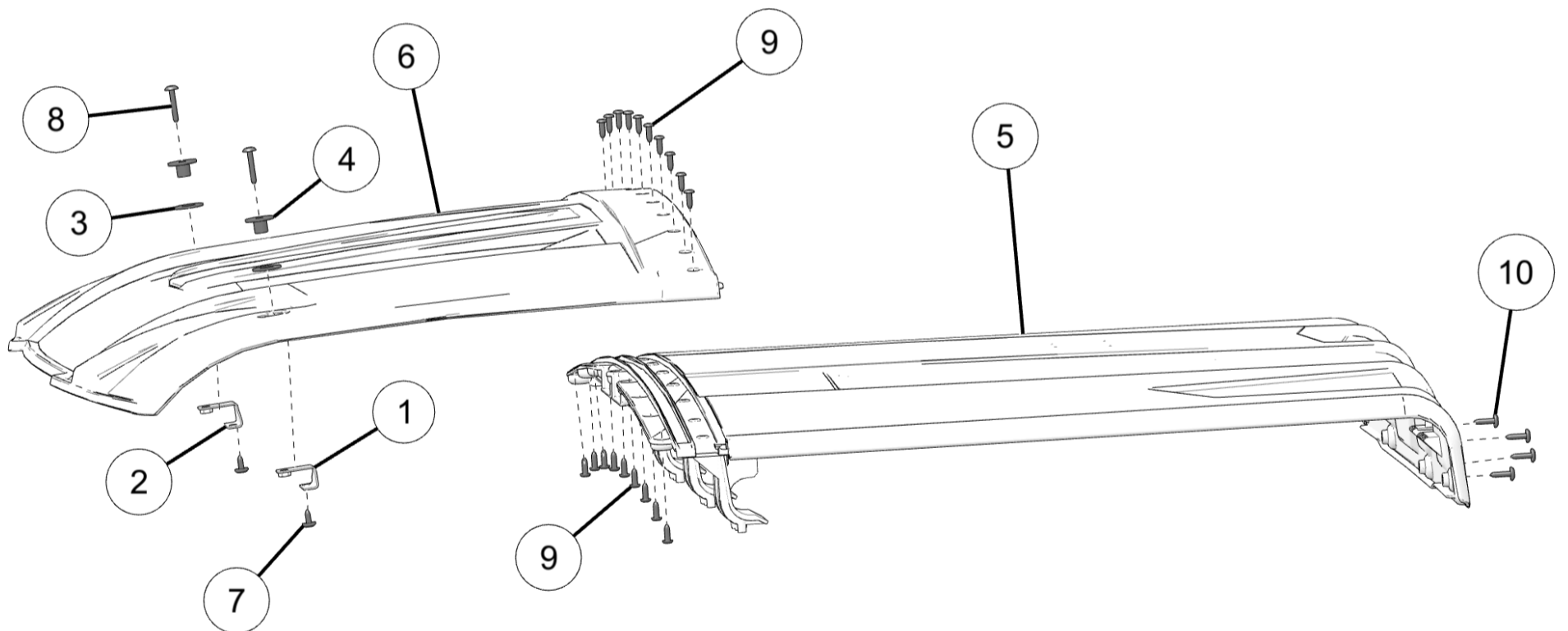

NOTICE

XXX = Polaris® color code (For example: 458 = Black)

Ref	Qty	Part Description	P/N Available Separately
1	1	Light Bar Bracket, Left	5266293-458
2	1	Light Bar Bracket, Right	5266294-458

Ref	Qty	Part Description	P/N Available Separately
3	2	Washer, Rubber Seal	5417559
4	2	Tip Spacer	5459383
5	1	Roof Panel, Rear	5459609-070
6	1	Roof Panel, Front	5459723-070
7	2	Screw, Torx® Drive, (M6 x 1 x 16 mm)	7518936
8	2	Screw, Torx® Drive, (M6 x 1 x 40 mm)	7519001
9	19	Screw, Torx® Truss Head, #14 x 3/4 in, HI/LO	7519045
10	4	Screw, Torx® Truss Head, (M6 x 1.0 x 25 mm)	7519650

Roof Seals Kit Detail P/N 2890361

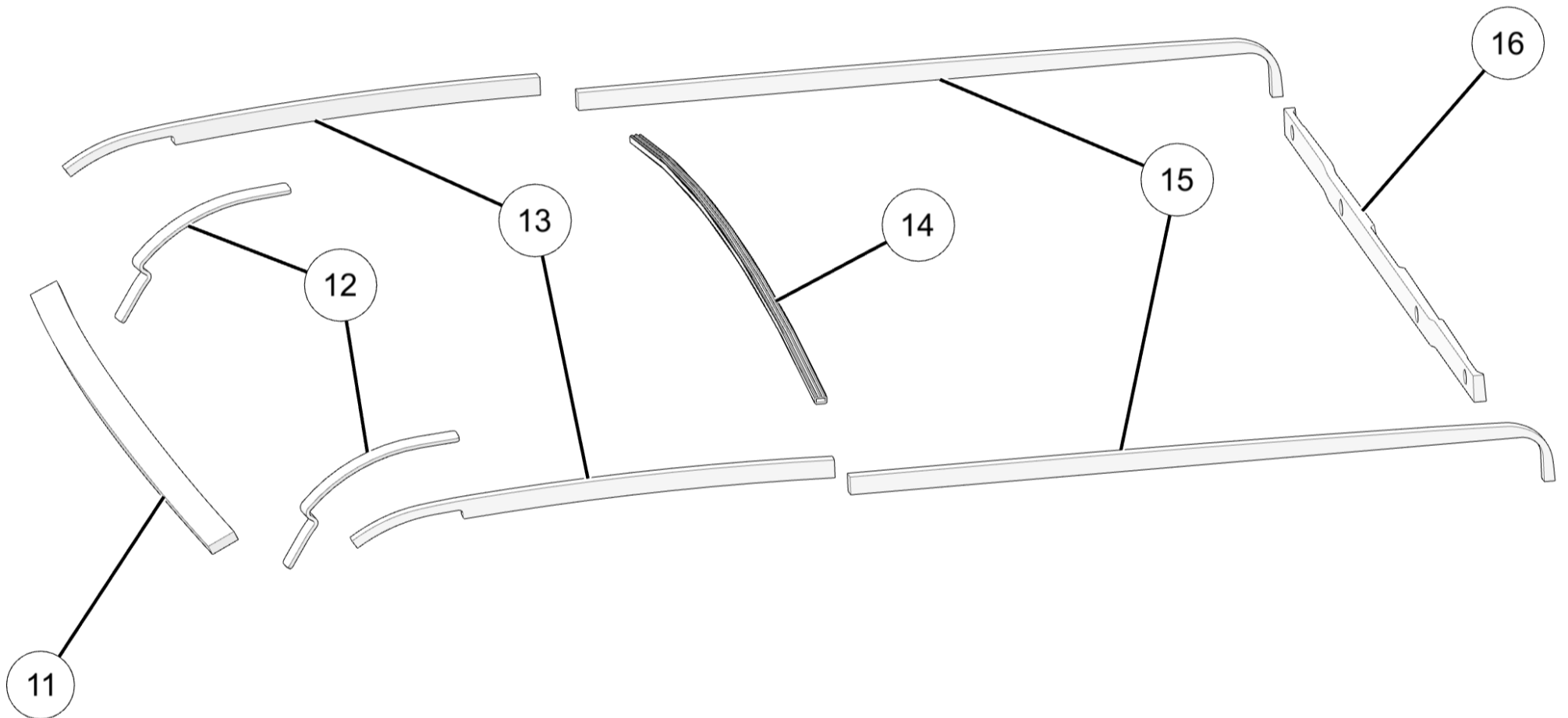

Ref	Qty	Part Description	P/N Available Separately
11	1	Roof Panel Seal, Front	5814649
12	2	ROPS Visor Seal	5814651
13	2	Roof Panel Seal, Front Sides	5814004
14	1	Roof Panel Seal, Mid-joint	5526483
15	2	Roof Panel Seal, Rear Sides	5814006
16	1	Roof Panel Seal, Rear	5813846

Tools Required

- Safety Glasses
- Screwdriver Set, Torx®
- Socket Set, Torx® Bit

- Torque Wrench

Important

Your Crew Roof Panel Kit is exclusively designed for your vehicle. Please read the installation instructions thoroughly before beginning. Installation is easier if the vehicle is clean and free of debris. For your safety, and to ensure a satisfactory installation, perform all installation steps correctly in the sequence shown.

Installation Instructions

Vehicle Preparation

General

1. Park vehicle on a flat surface.
2. Shift vehicle into PARK.
3. Turn key to OFF position and remove key.

Mid-joint Roof Seal Installation

1. Put both roof panels upside down on protective surface.
2. Clean rear edge of front roof panel (6) with isopropyl alcohol and a clean, lint free cloth.

⚠ WARNING

Isopropyl alcohol is hazardous to your health. See isopropyl alcohol packaging for proper handling instructions, including recommended personal protective equipment.

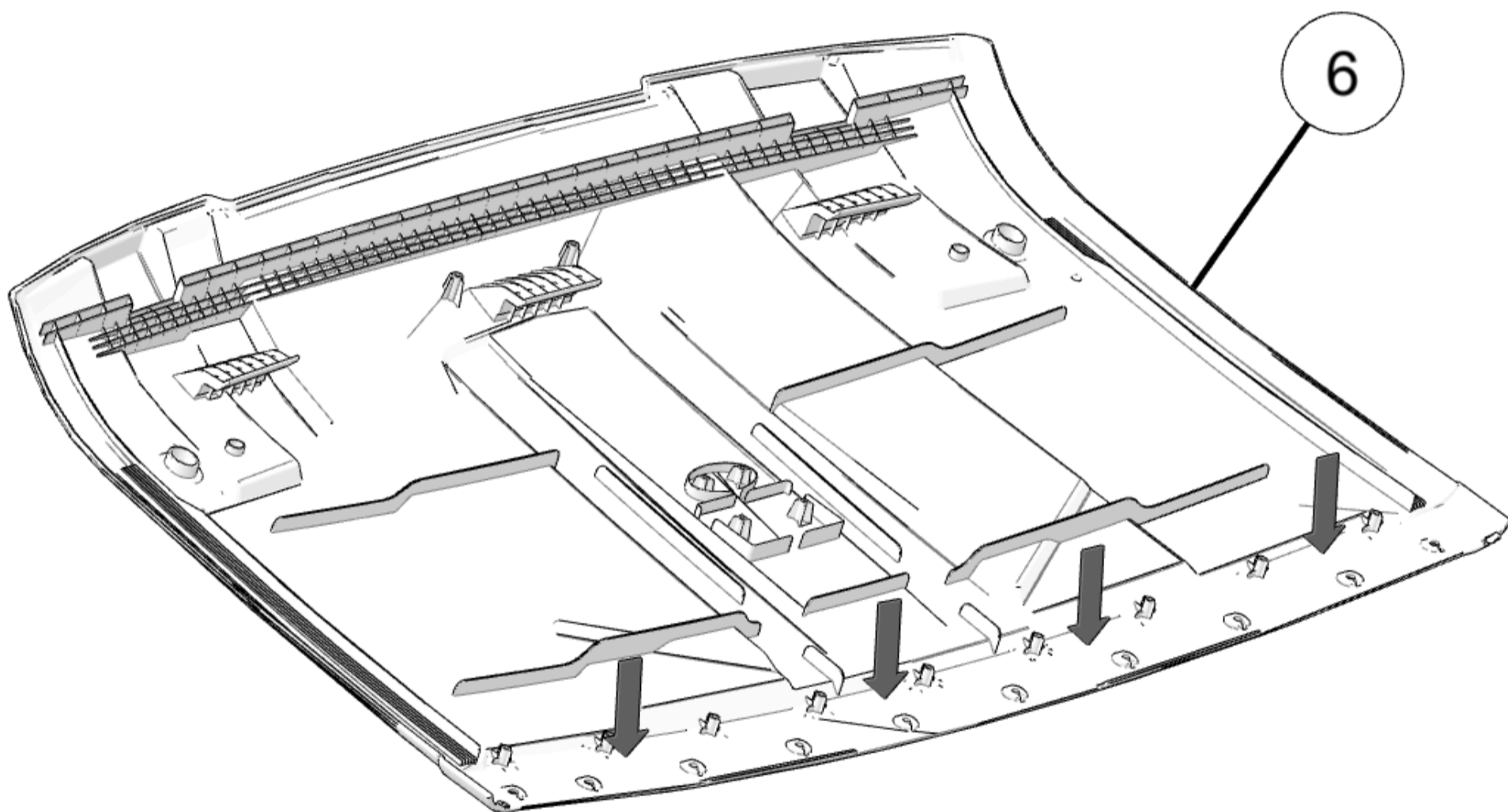

3. Remove adhesive backing from mid-joint roof seal (14).
4. Install mid-joint roof seal (14) to inside channel on roof panel (6).

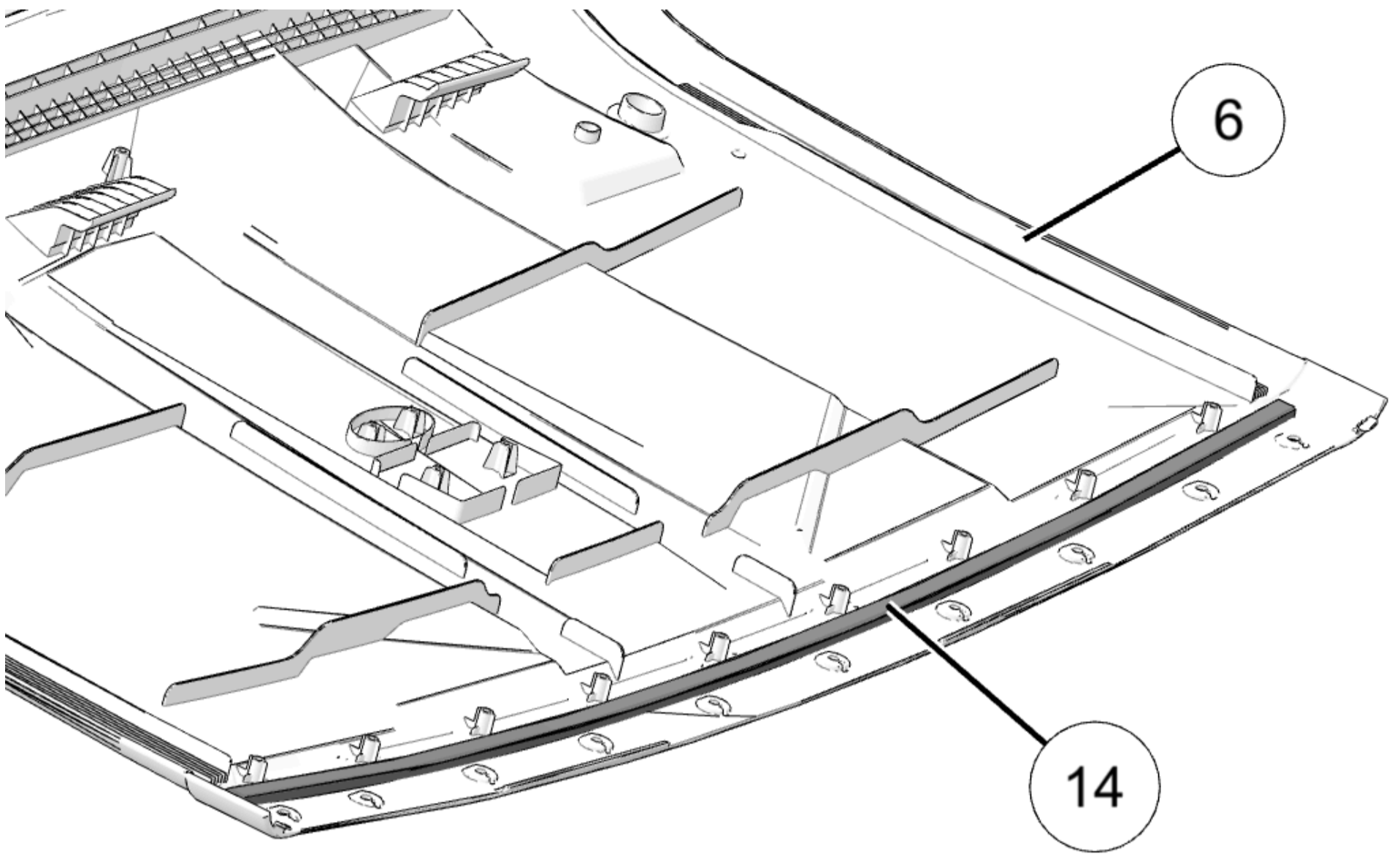

Accessory Installation

TIP

It is recommended two people install this accessory.

Roof Panel Preparation

1. Put rear edge of front roof panel ⑥ into channel on front edge of rear roof panel ⑤.

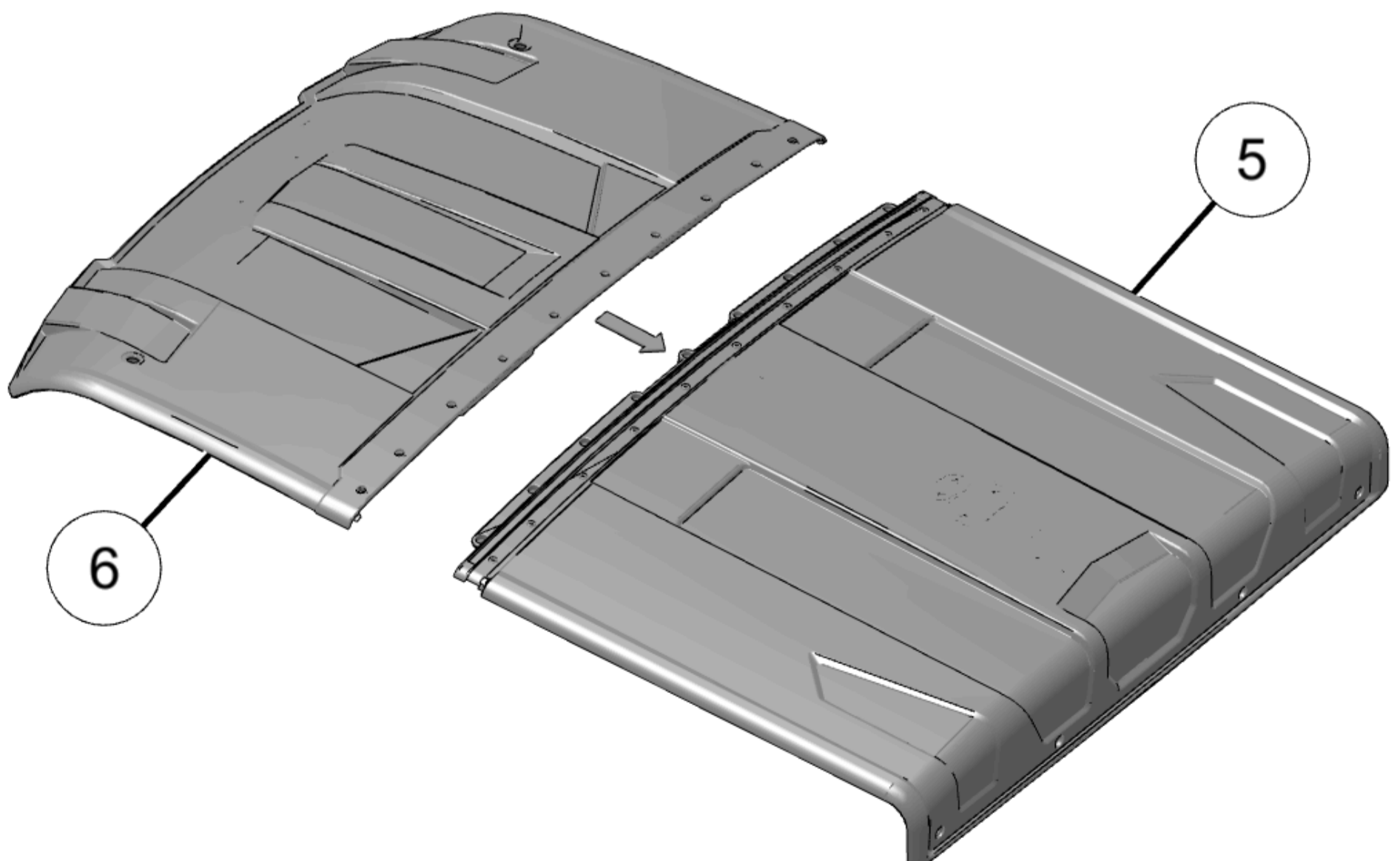

2. Attach roof panels using ten screws (9). Torque screws to specification.

TORQUE
Screws (9): 22 in-lbs (2.5 N·m)

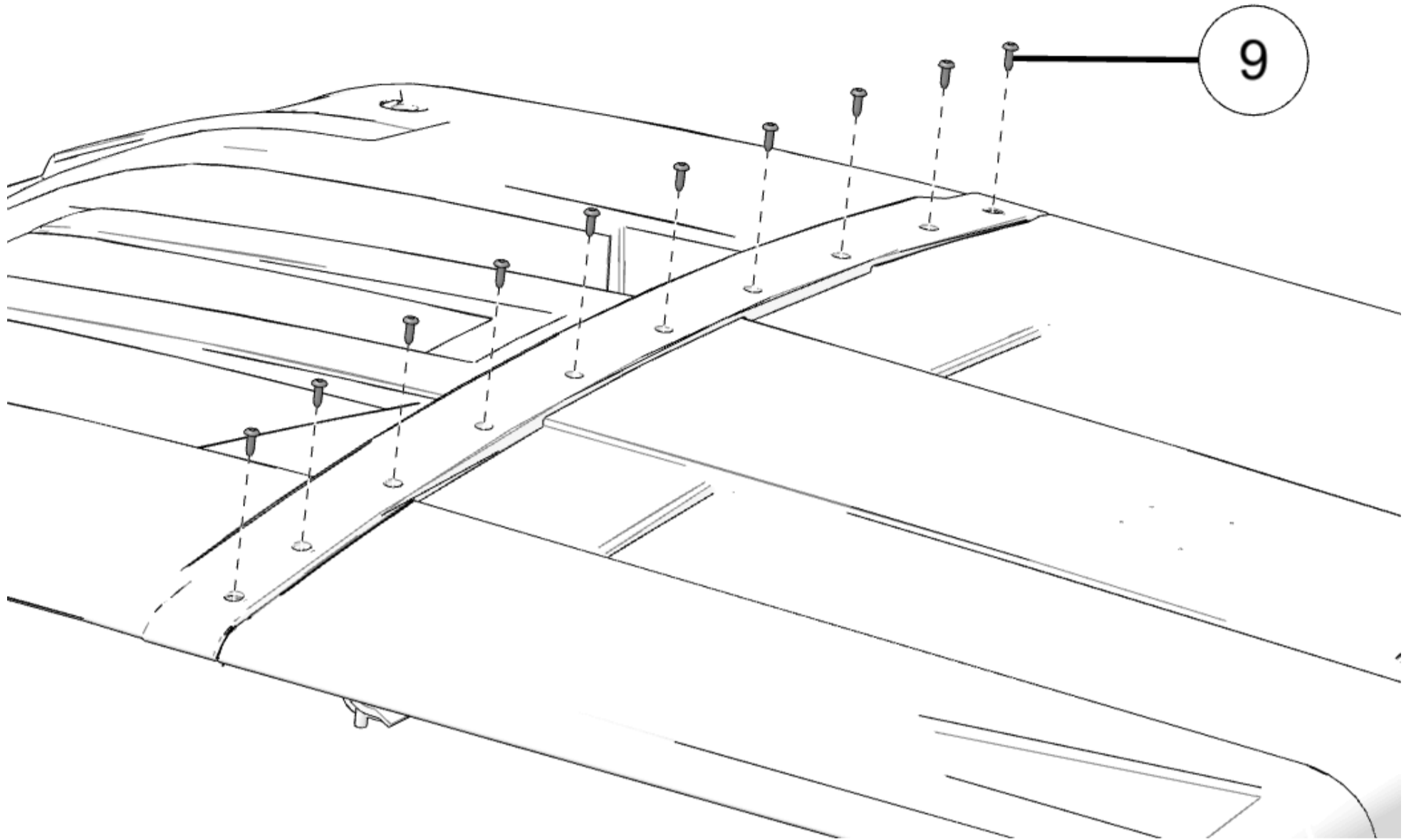

3. Turn roof panel assembly over and install nine screws (9). Torque screws to specification.

TORQUE
Screws (9): 22 in-lbs (2.5 N·m)

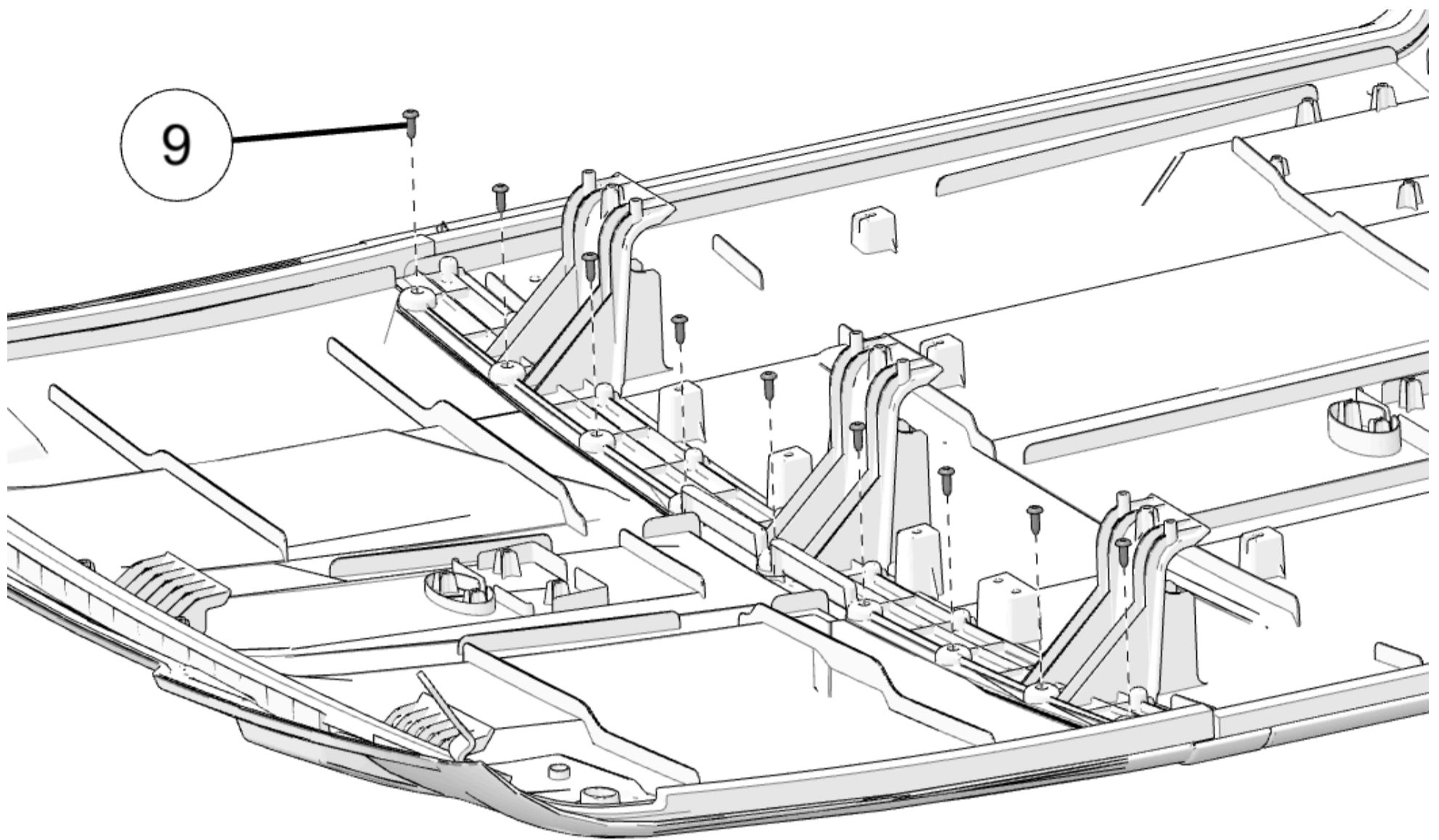

Roof Seal Kit Installation (P/N 2890361)

Front, Side, and Rear Roof Seal Installation

NOTICE

Right side shown; left side similar.

IMPORTANT

Front side seal and rear side seal will overlap near mid-joint seal.

1. Clean perimeter of interior roof panel surfaces with isopropyl alcohol and a clean, lint free cloth.

⚠ WARNING

Isopropyl alcohol is hazardous to your health. See isopropyl alcohol packaging for proper handling instructions, including recommended personal protective equipment.

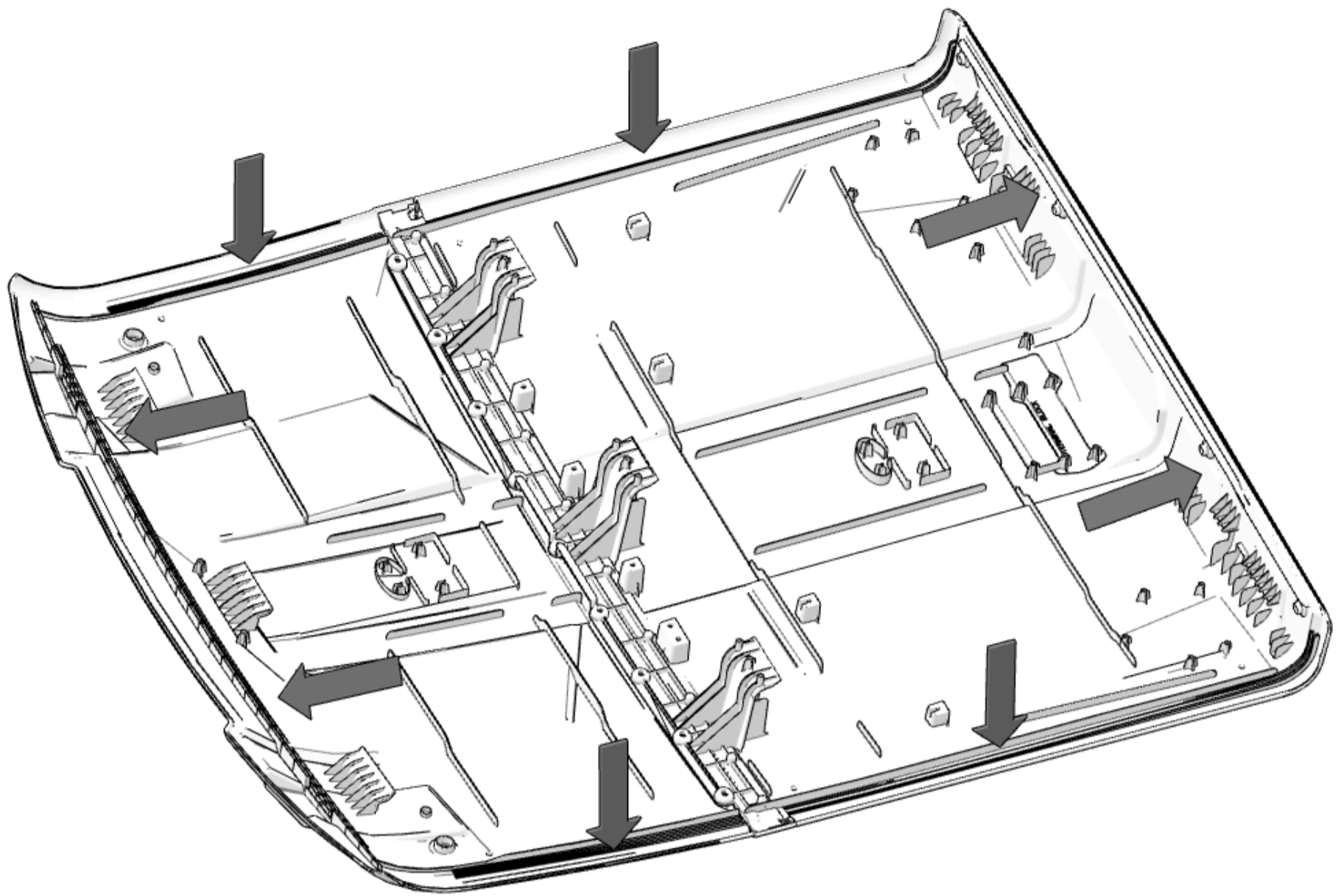

2. Remove adhesive backing from front roof seal (11).

3. Install front roof seal (11) to front edge of roof (6). Push seal firmly into place on roof.

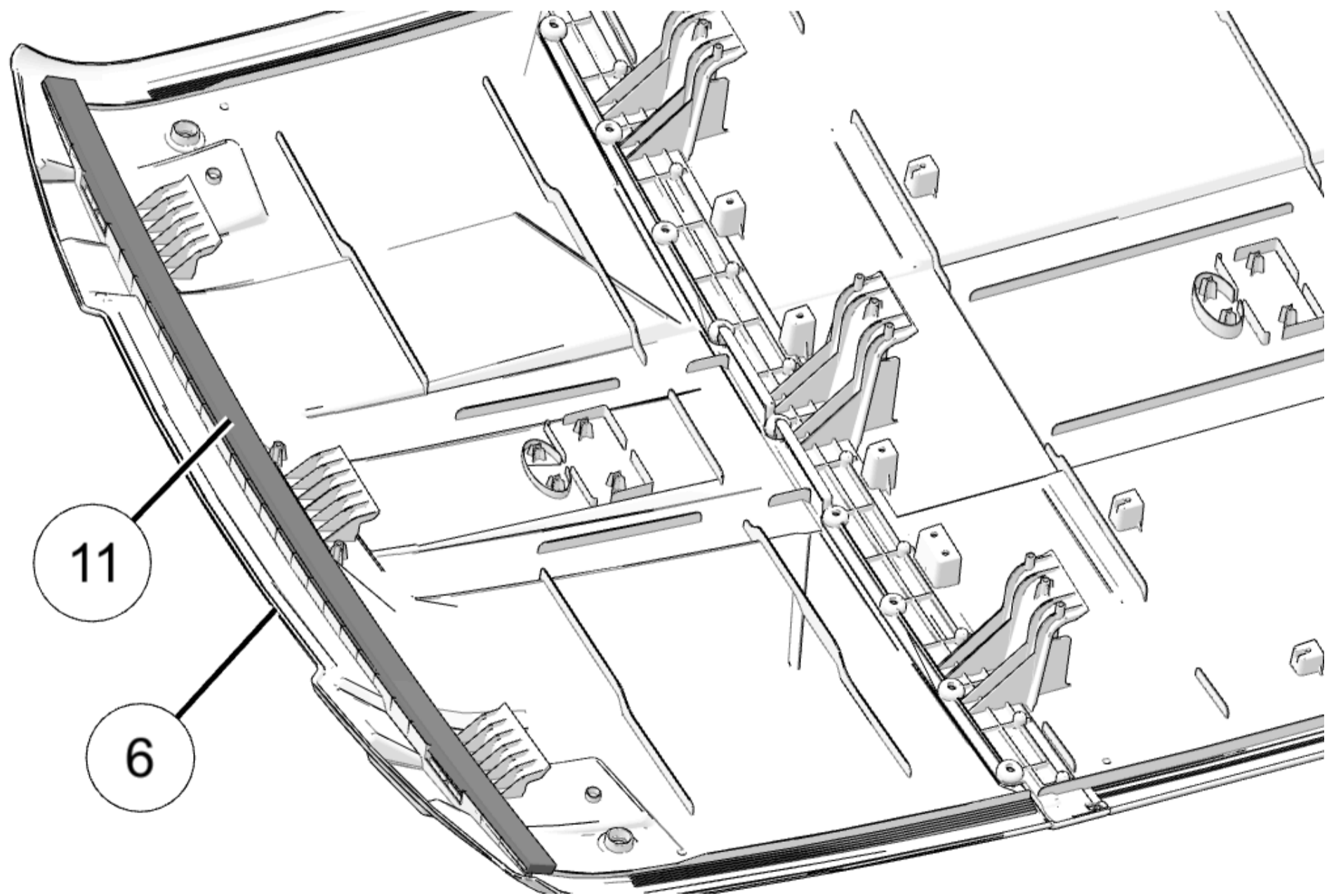

4. Remove adhesive backing from front right side roof seal (13).

5. Install front right side roof seal (13) to front right side on roof (6). Push seal firmly into place on roof.

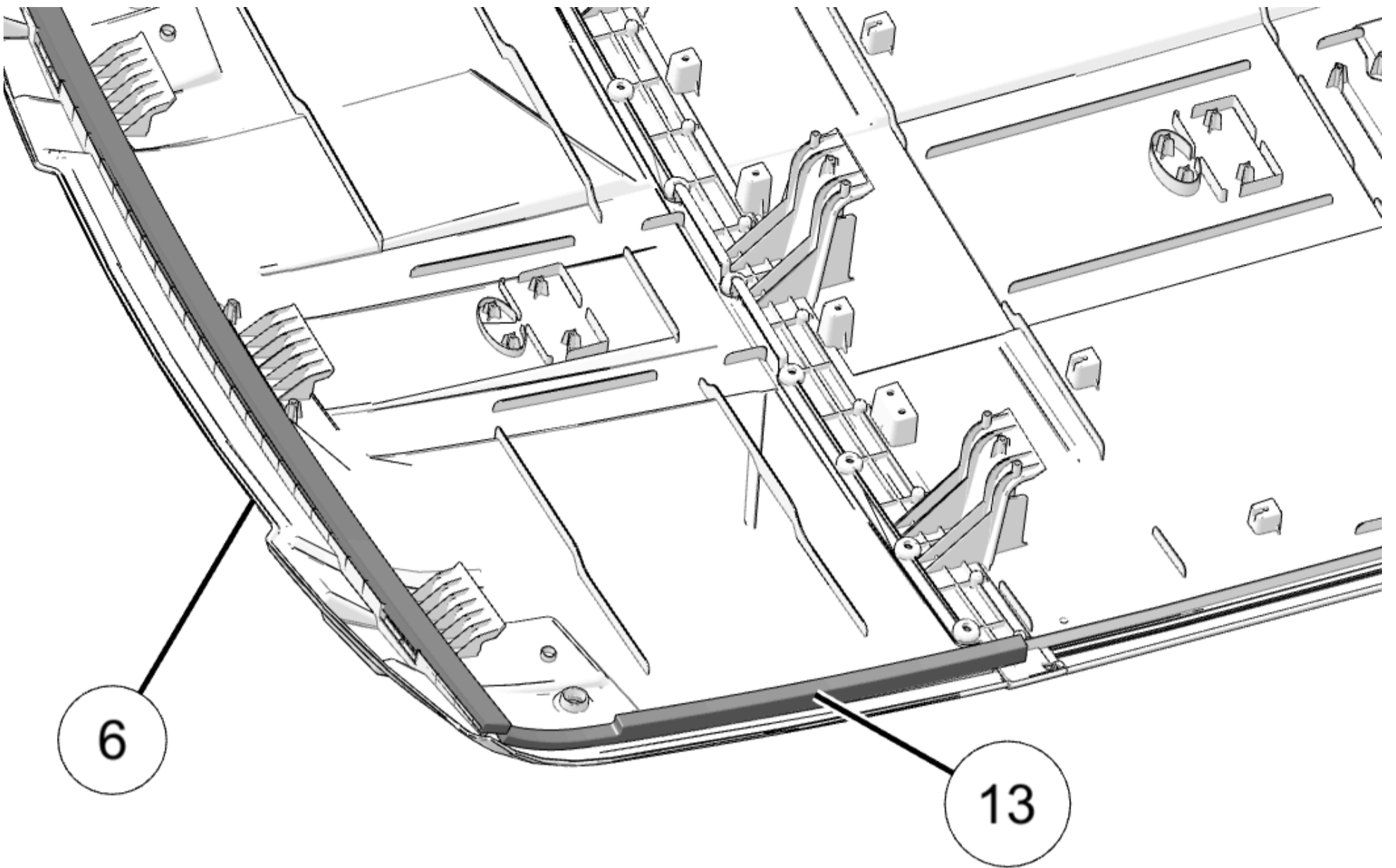

6. Remove adhesive backing from rear right side roof seal (15).

7. Install rear right side roof seal (15) to rear right side on roof (5). Push seal firmly into place on roof.

NOTICE

Make sure there are no gaps between the front side and rear side seals.

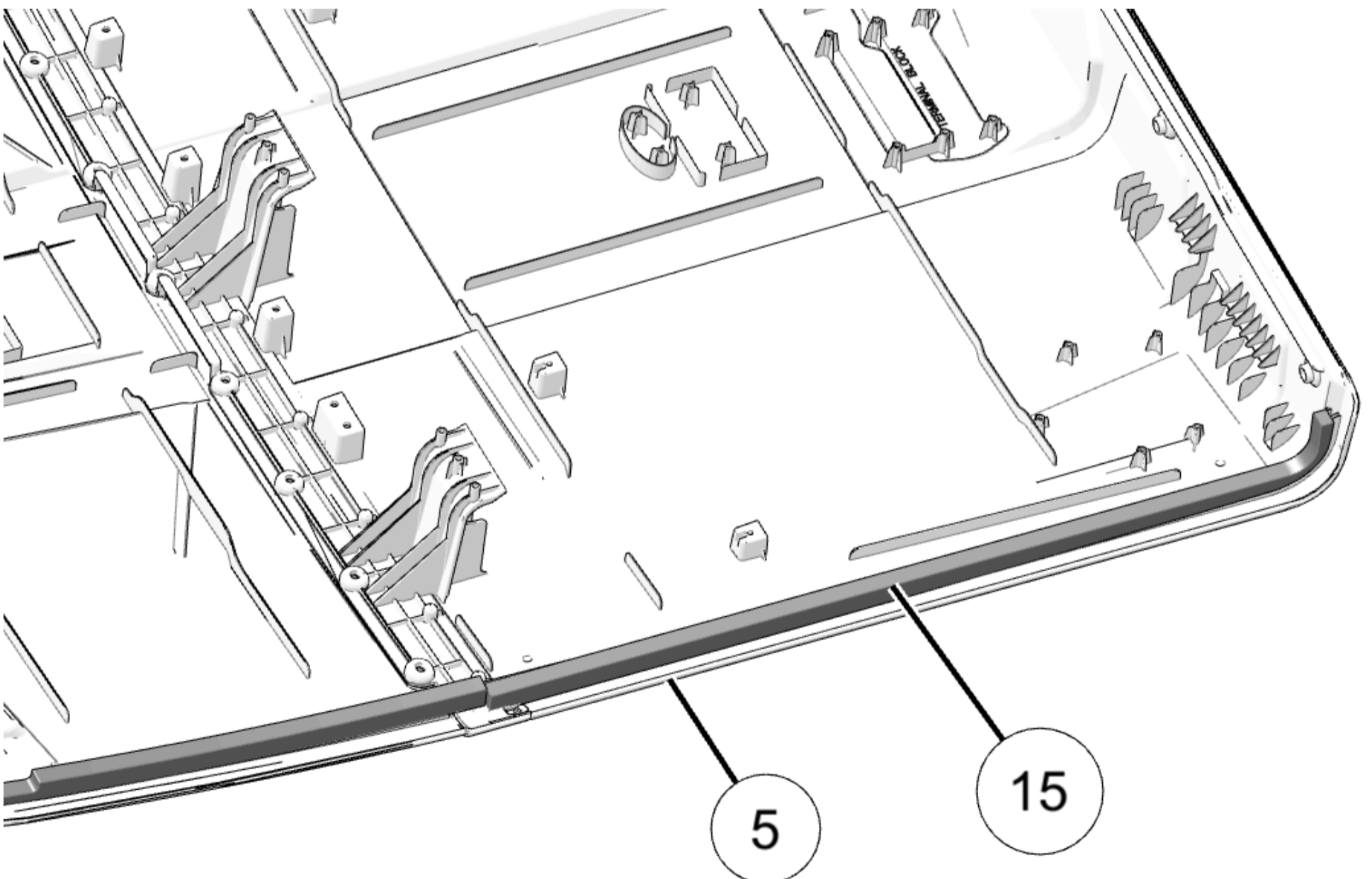

8. Remove adhesive backing from rear roof seal (16).

9. Align holes in seal (16) with fastener standoffs on roof panel (5).

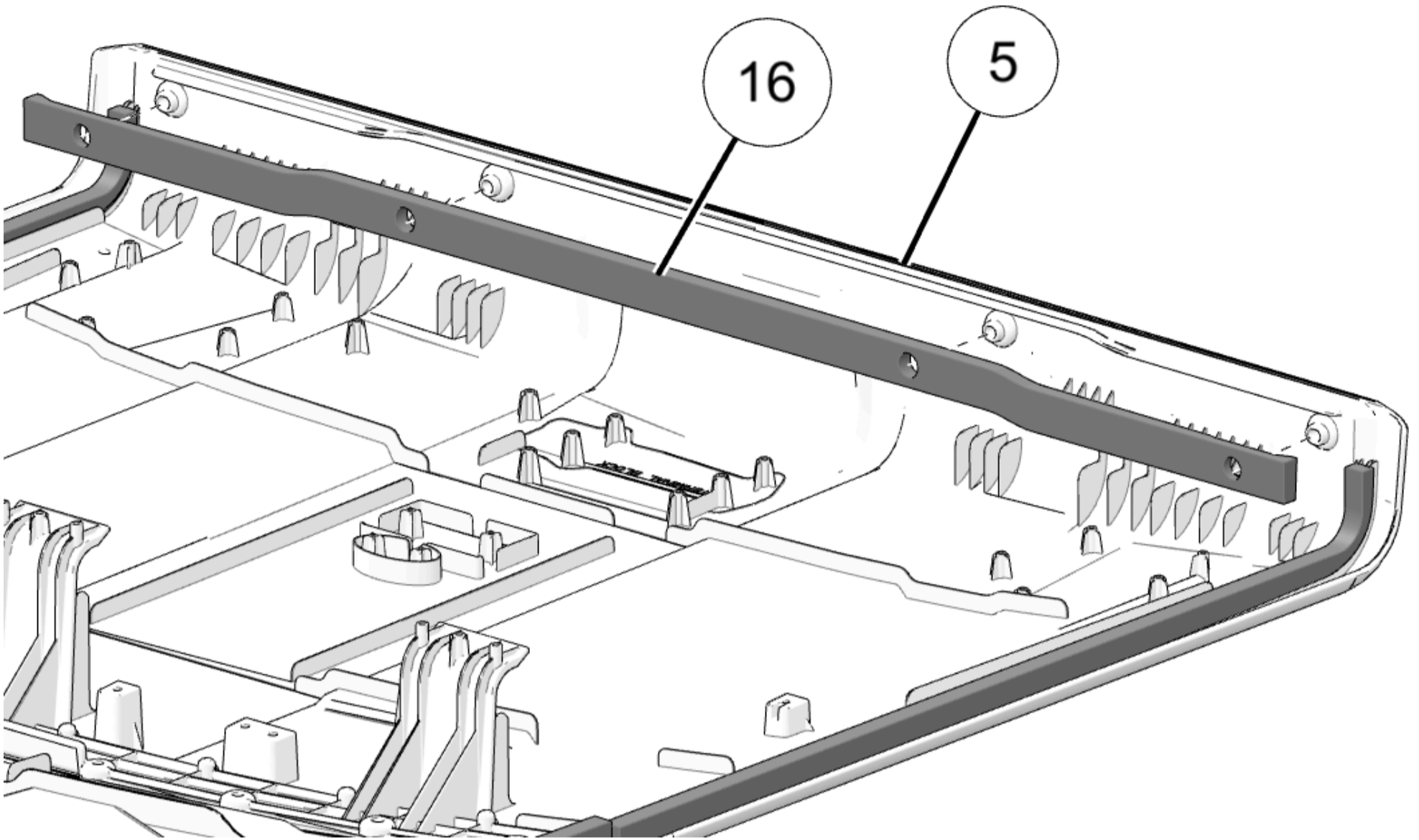

10. Install rear roof seal (16) to rear edge of roof (5). Push seal firmly into place on roof.

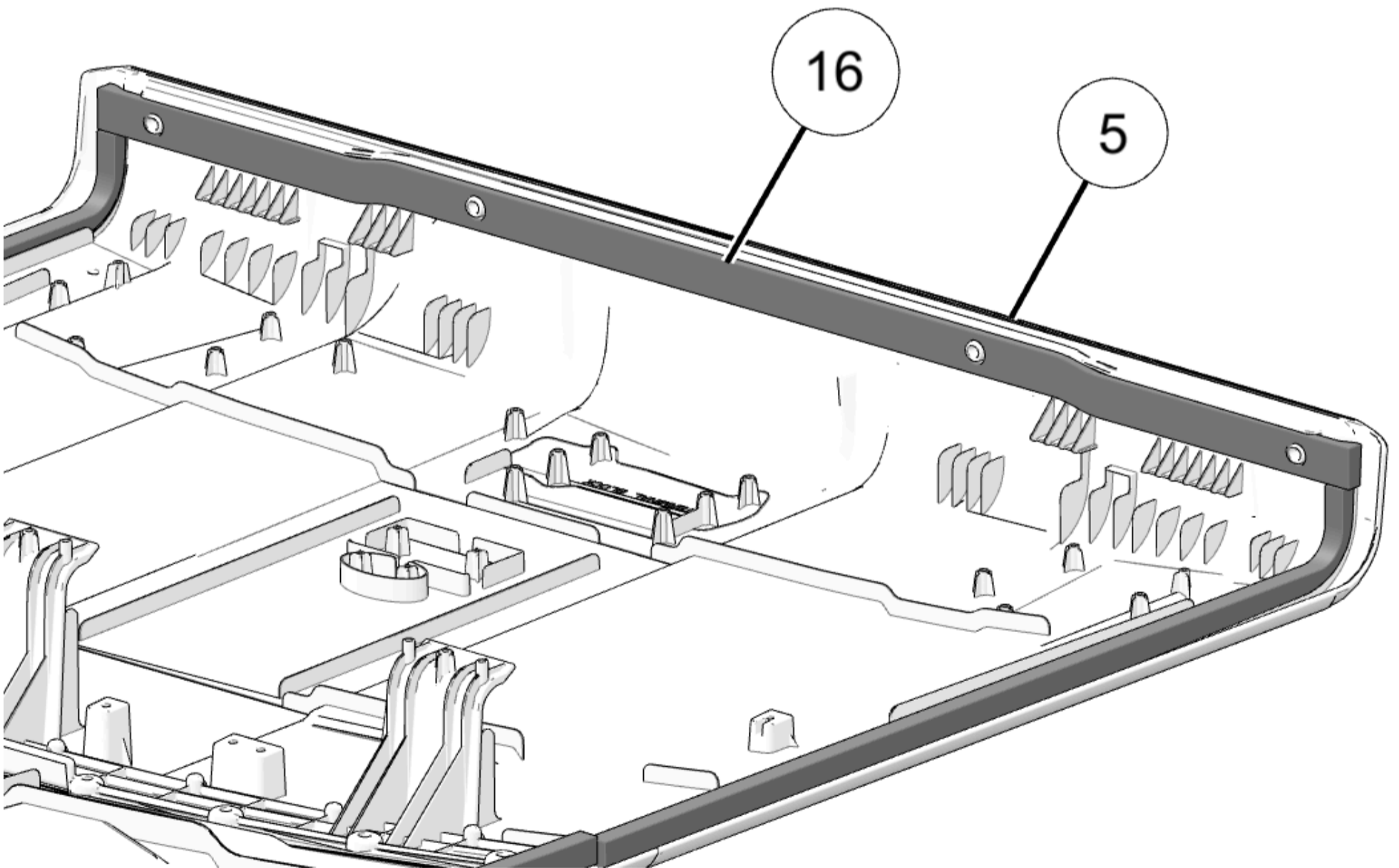

ROPS Visor Roof Seal Installation

1. Clean outer edges on upper ROPS visor with isopropyl alcohol and a clean, lint free cloth.

⚠ WARNING

Isopropyl alcohol is hazardous to your health. See isopropyl alcohol packaging for proper handling instructions, including recommended personal protective equipment.

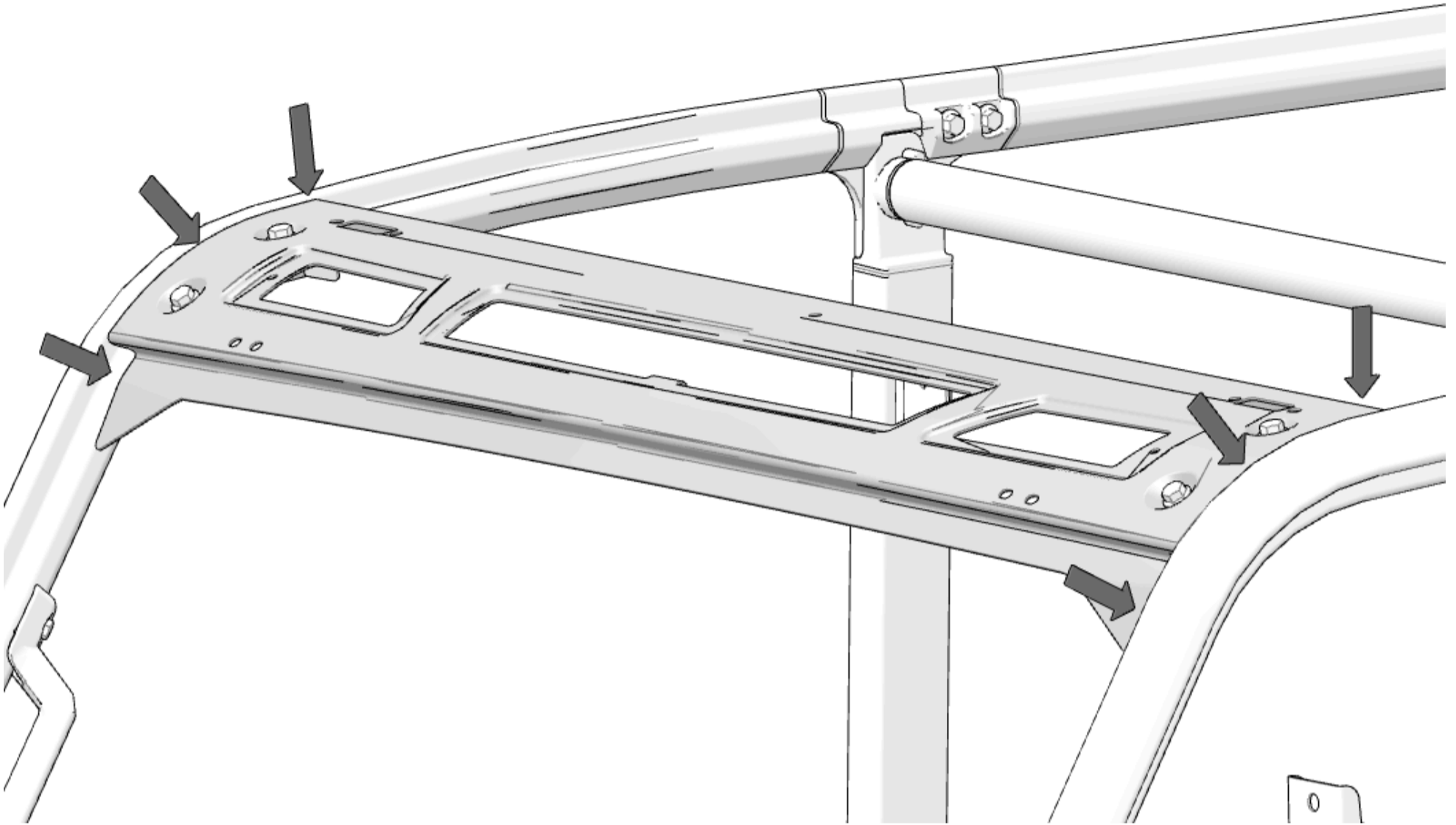

2. Remove adhesive backing from left and right ROPS roof seal (12).
3. Install left and right ROPS roof seal (12) to each end of ROPS visor.

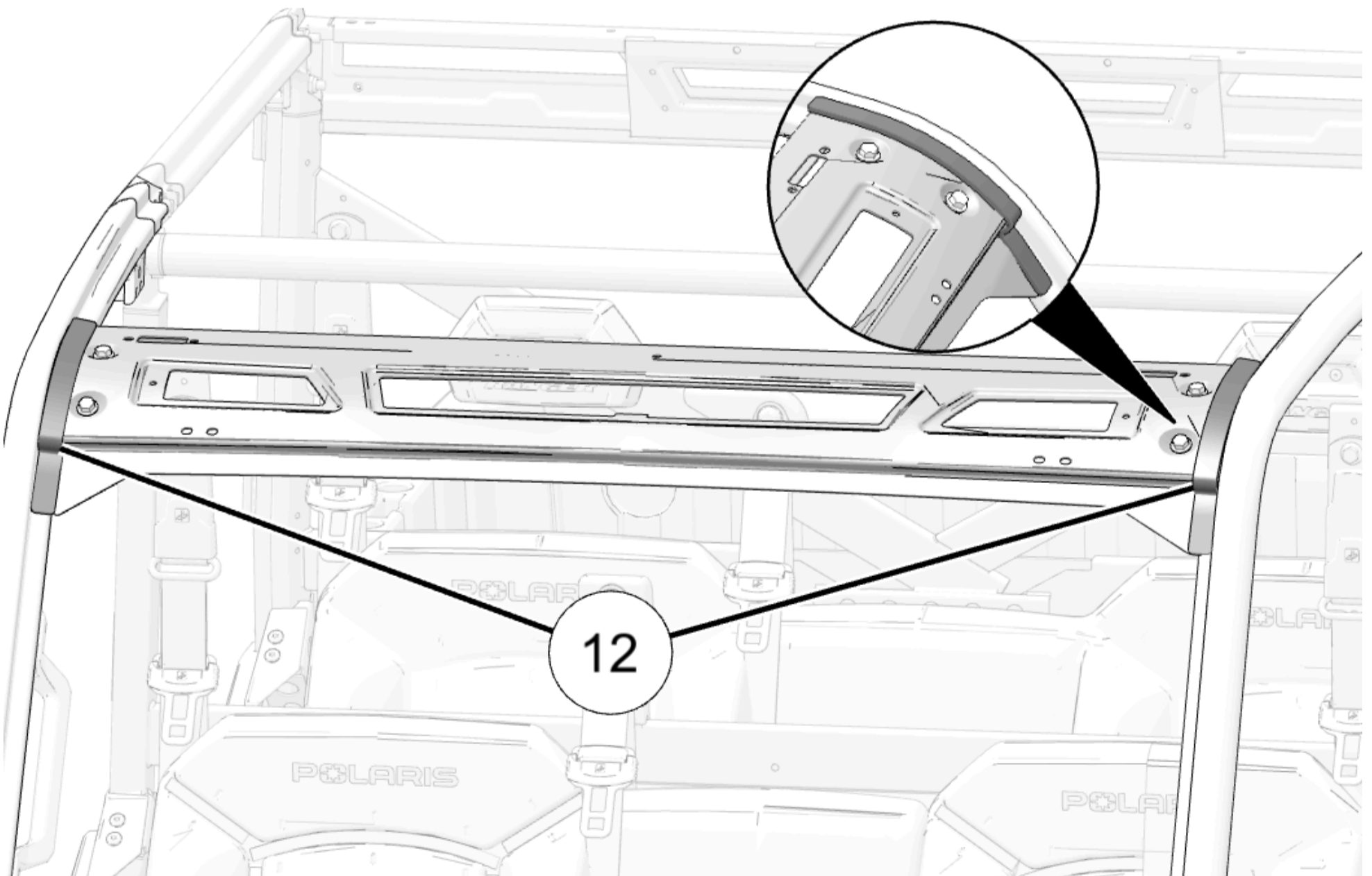

4. Push each ROPS roof seal (12) firmly into place on ROPS visor.

Light Bar Bracket Installation

1. Install left light bar bracket ① on ROPS using one screw ⑦. Make sure bracket holes are aligned with holes in ROPS.

NOTICE

Left side shown; right side similar.

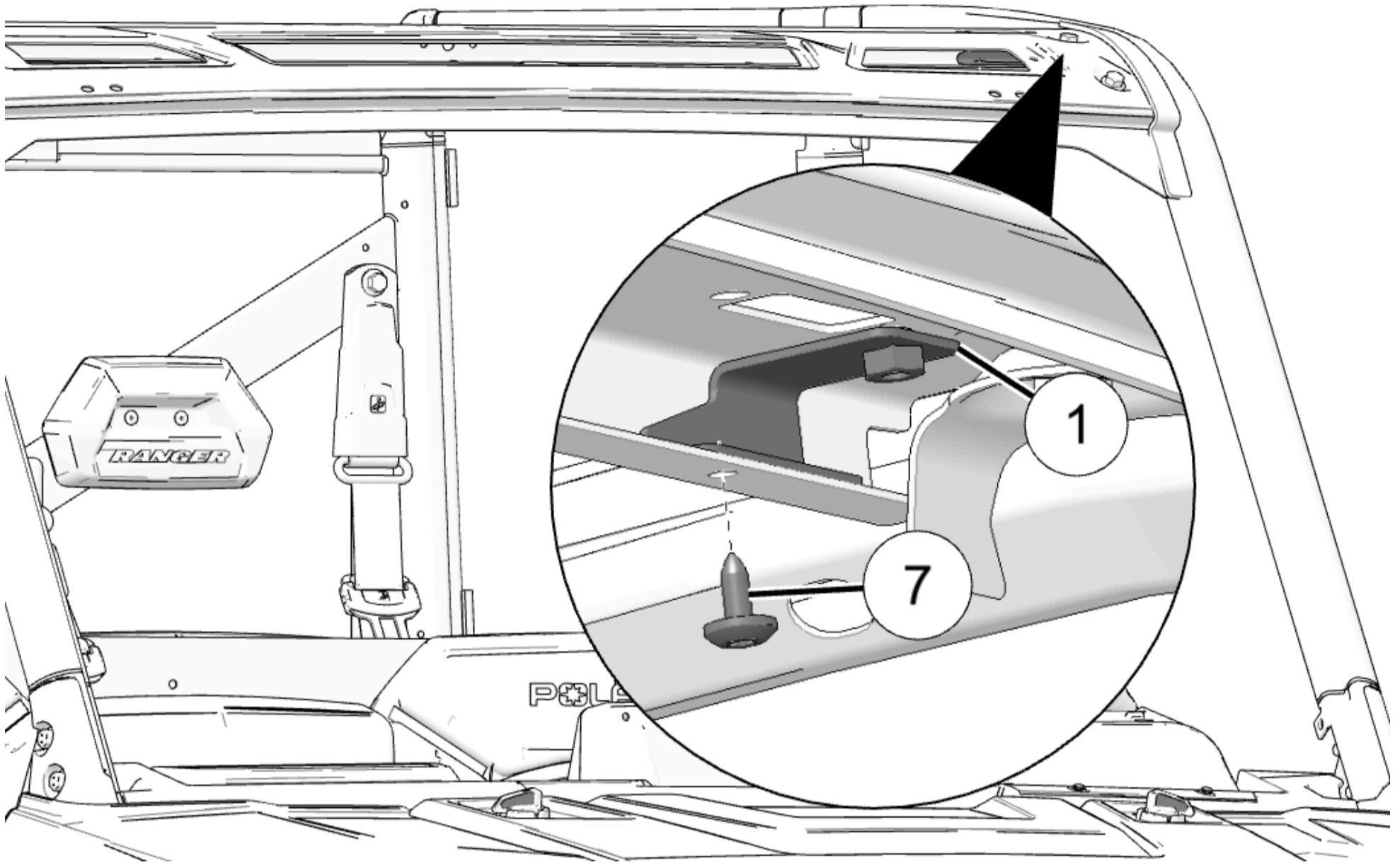

2. Torque screws to specification.

TORQUE

Screws ⑦:

44 in-lbs (5 N·m)

Roof Panel Installation

1. Install roof panel assembly onto ROPS.

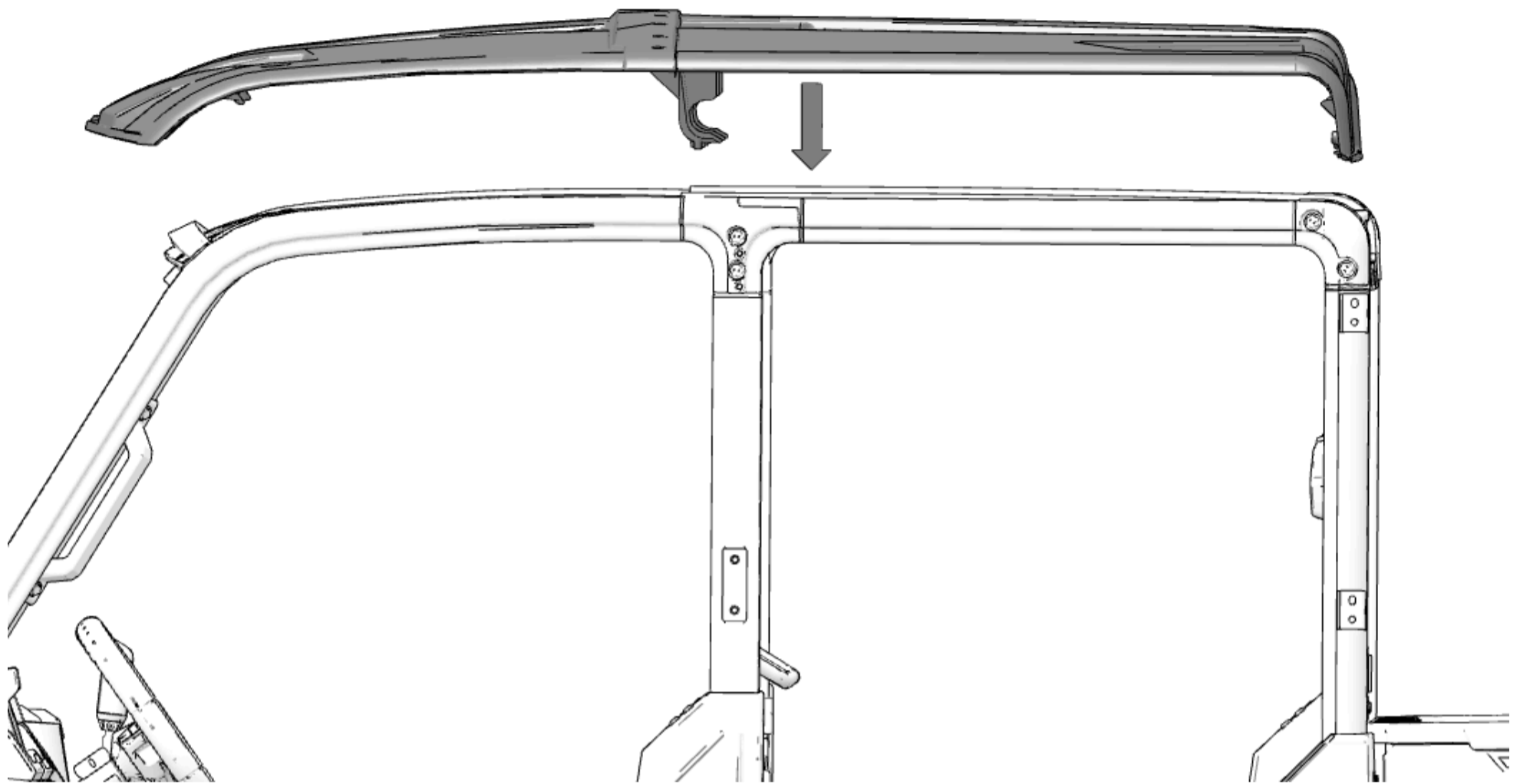

2. Attach hooks on front of roof in ROPS opening. Move front roof panel rearward until hooks lock into ROPS.

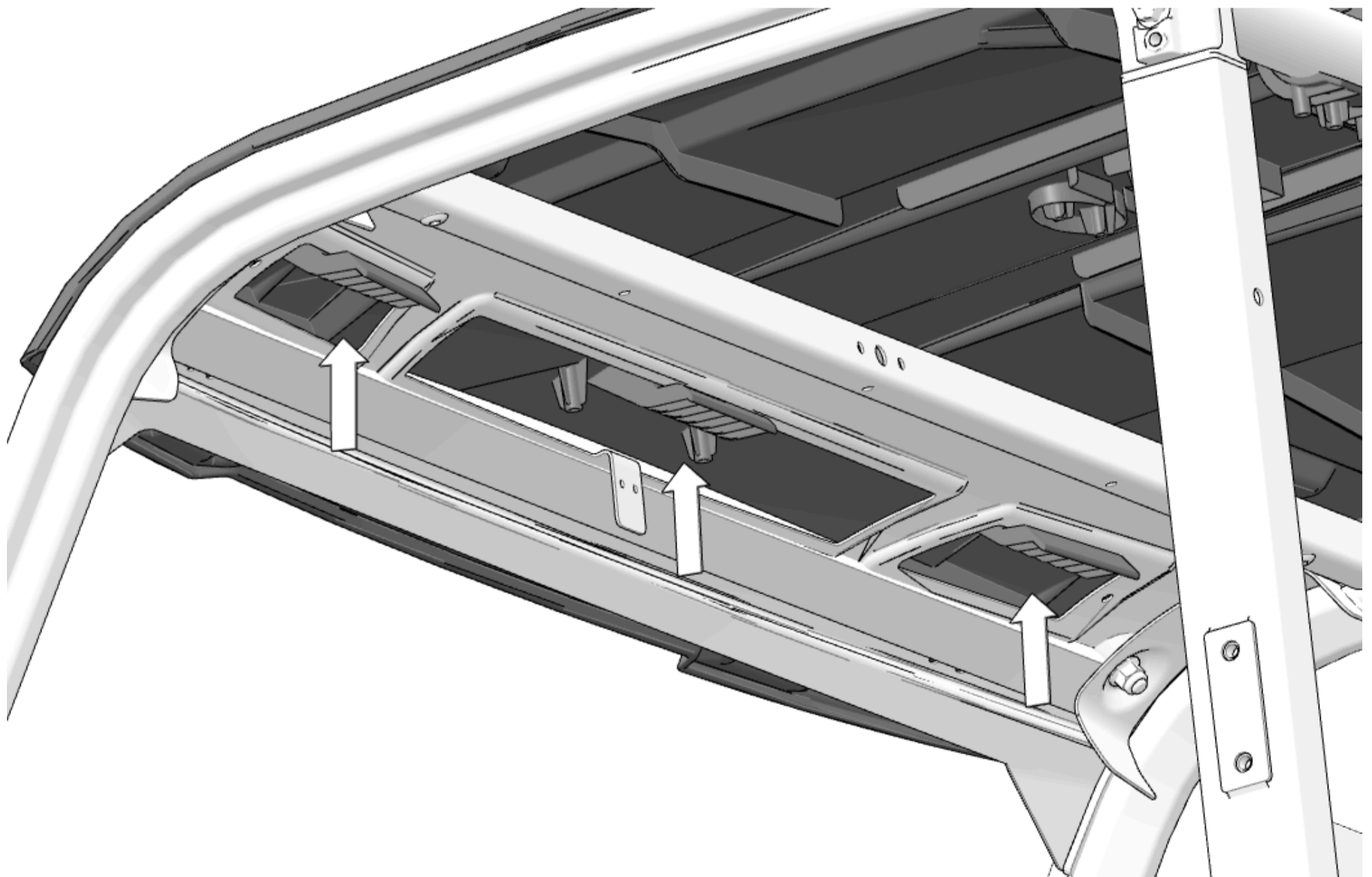

3. Push down on center of roof assembly. Attach center hooks to ROPS bar.

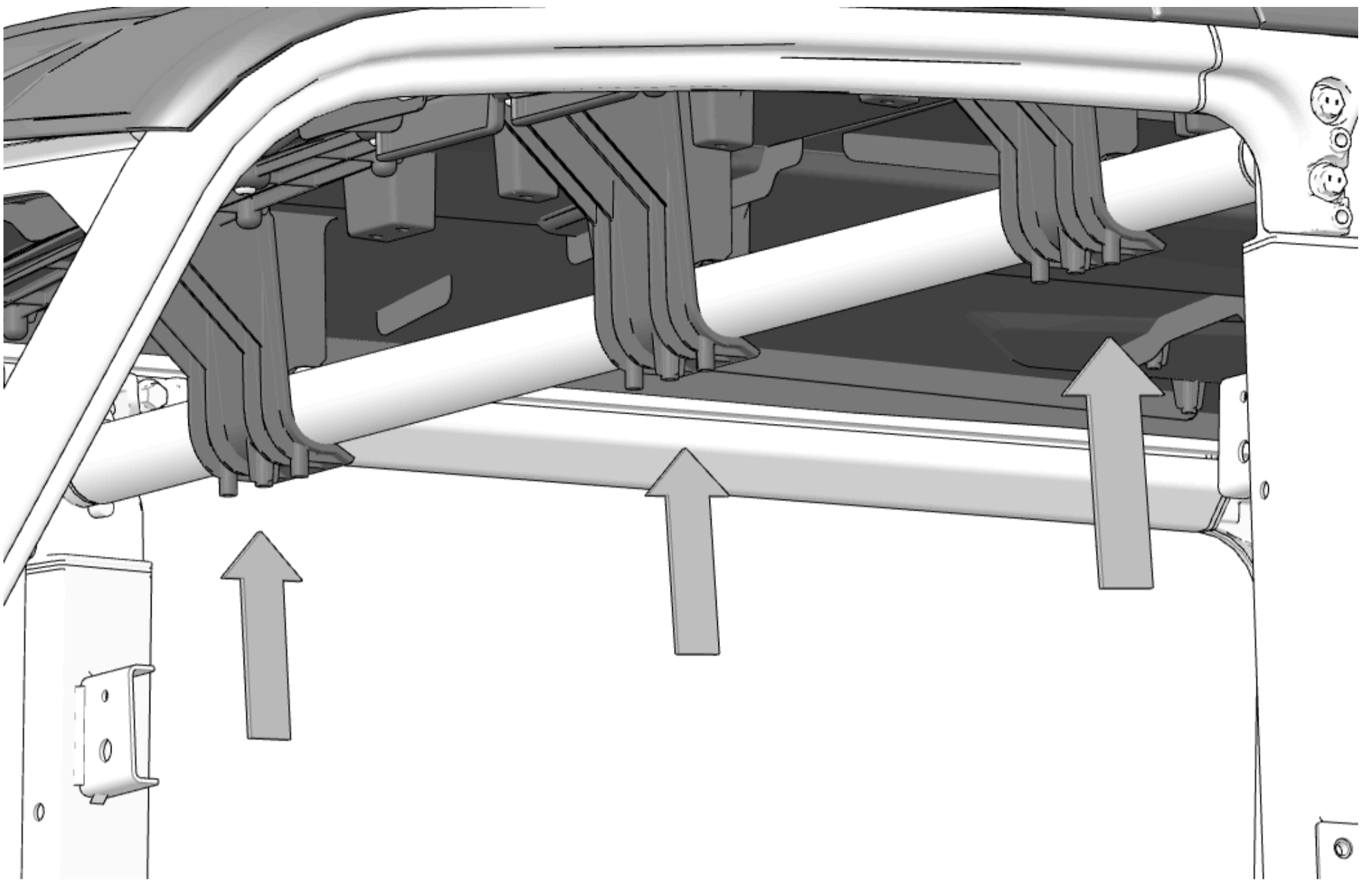

4. Pull out on rear roof assembly.

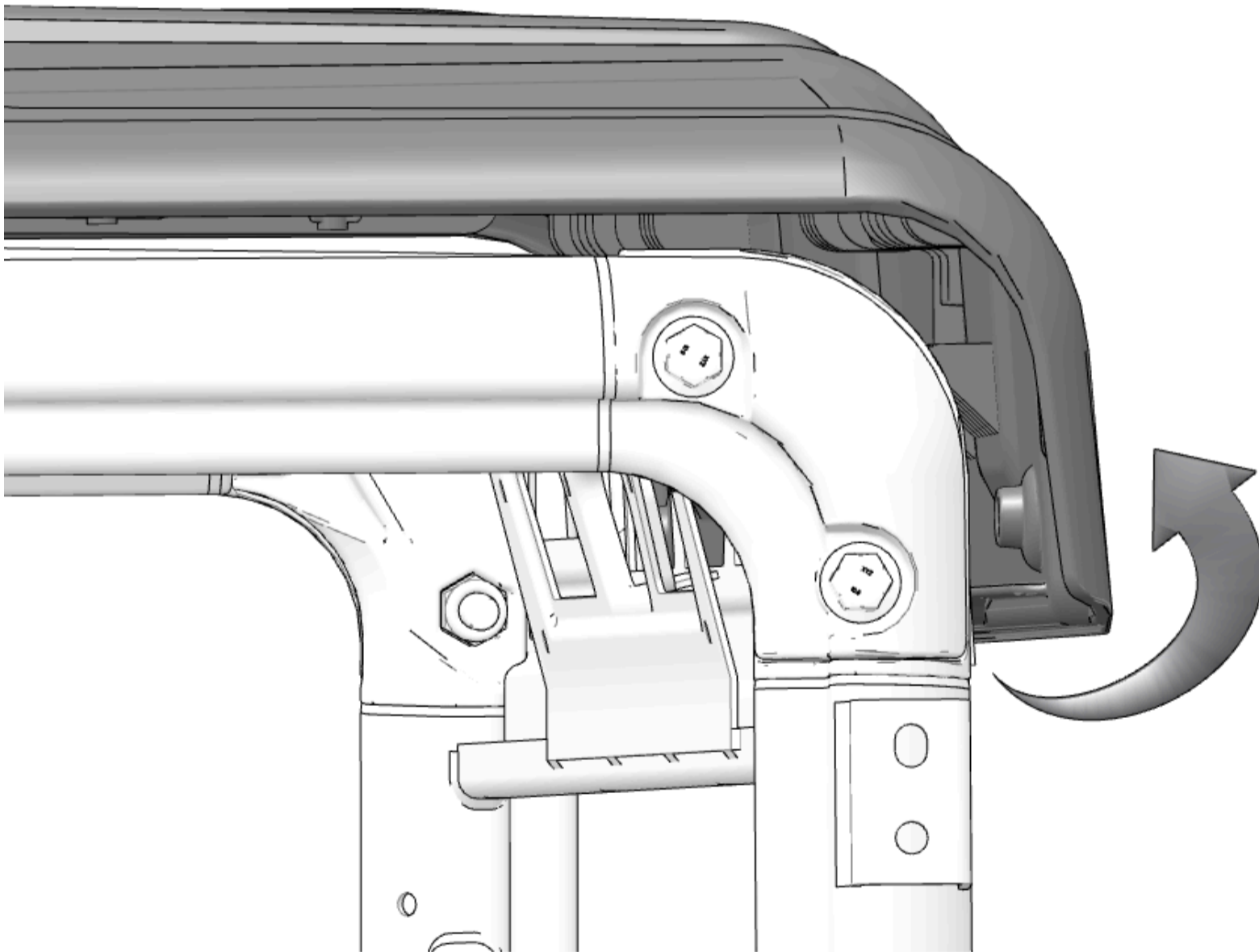

5. Push down to engage tabs in rear ROPS.

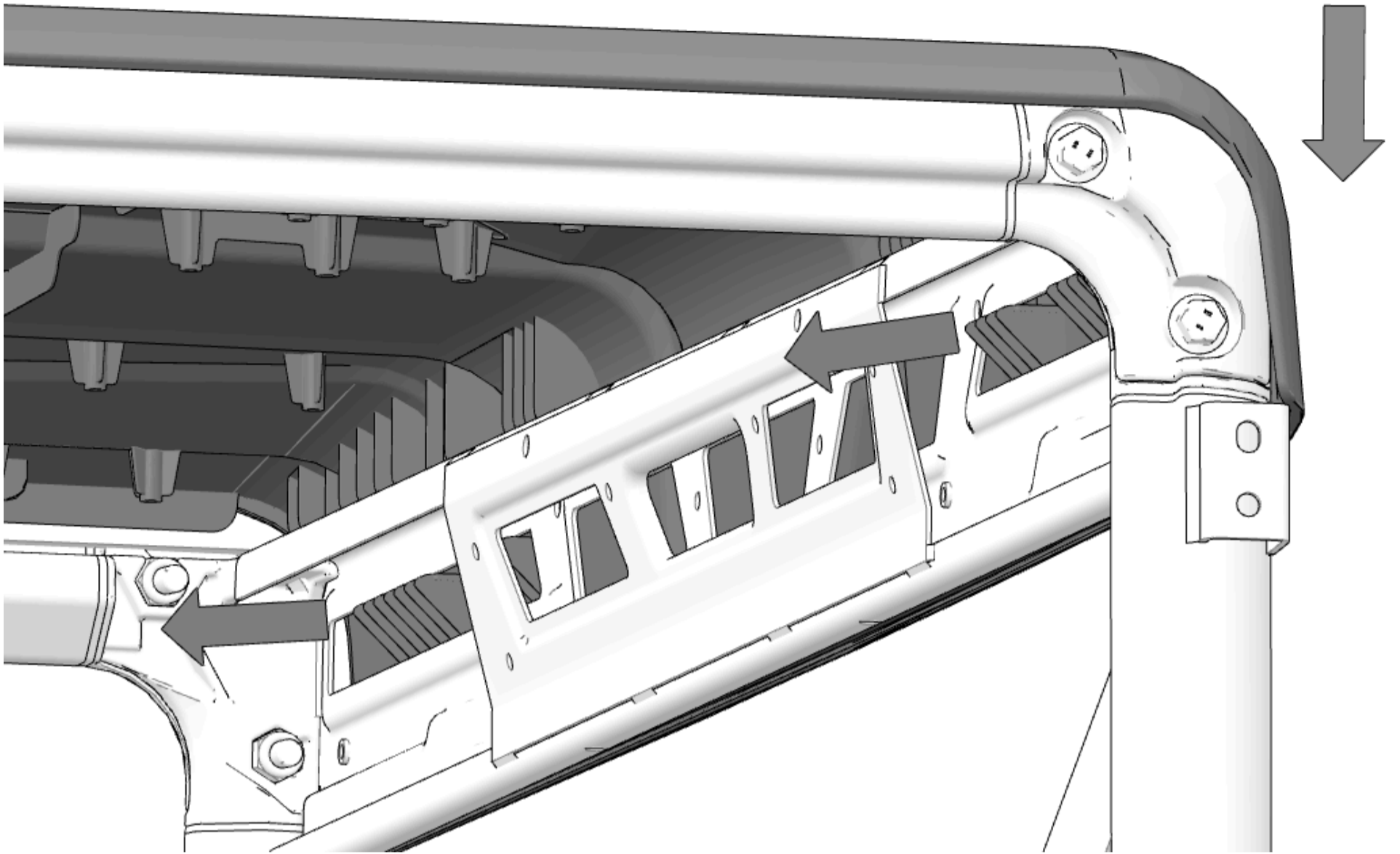

6. Attach rear roof panel to vehicle with four screws (10). Torque screws to specification.

TORQUE

Screws (10):

44 in-lbs (5 N·m)

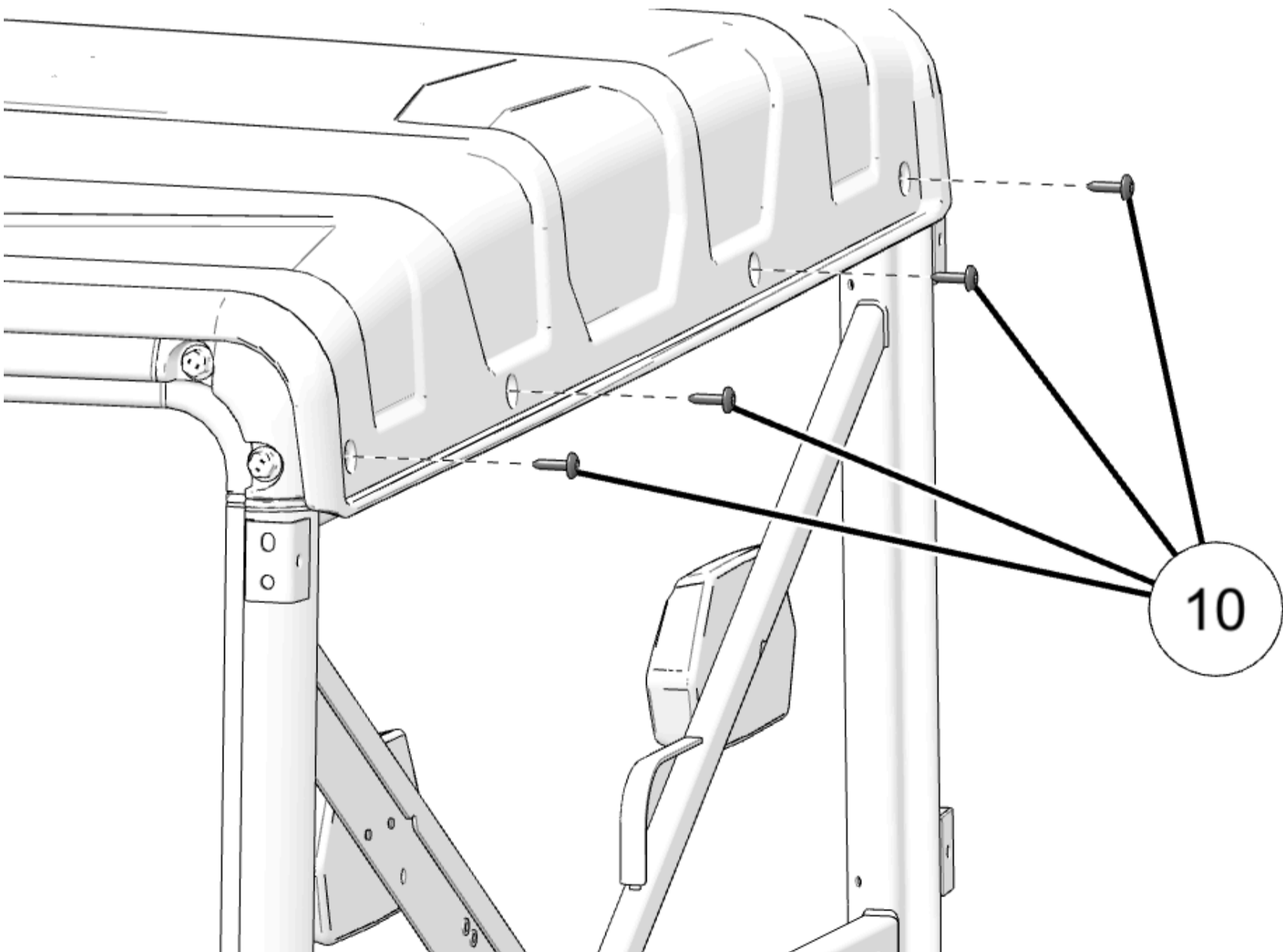

7. Attach front roof panel to vehicle with two screws (8), tip spacers (4), and washers (3). Make sure light bar brackets (1) and (2) (not shown) are aligned with screws (8).

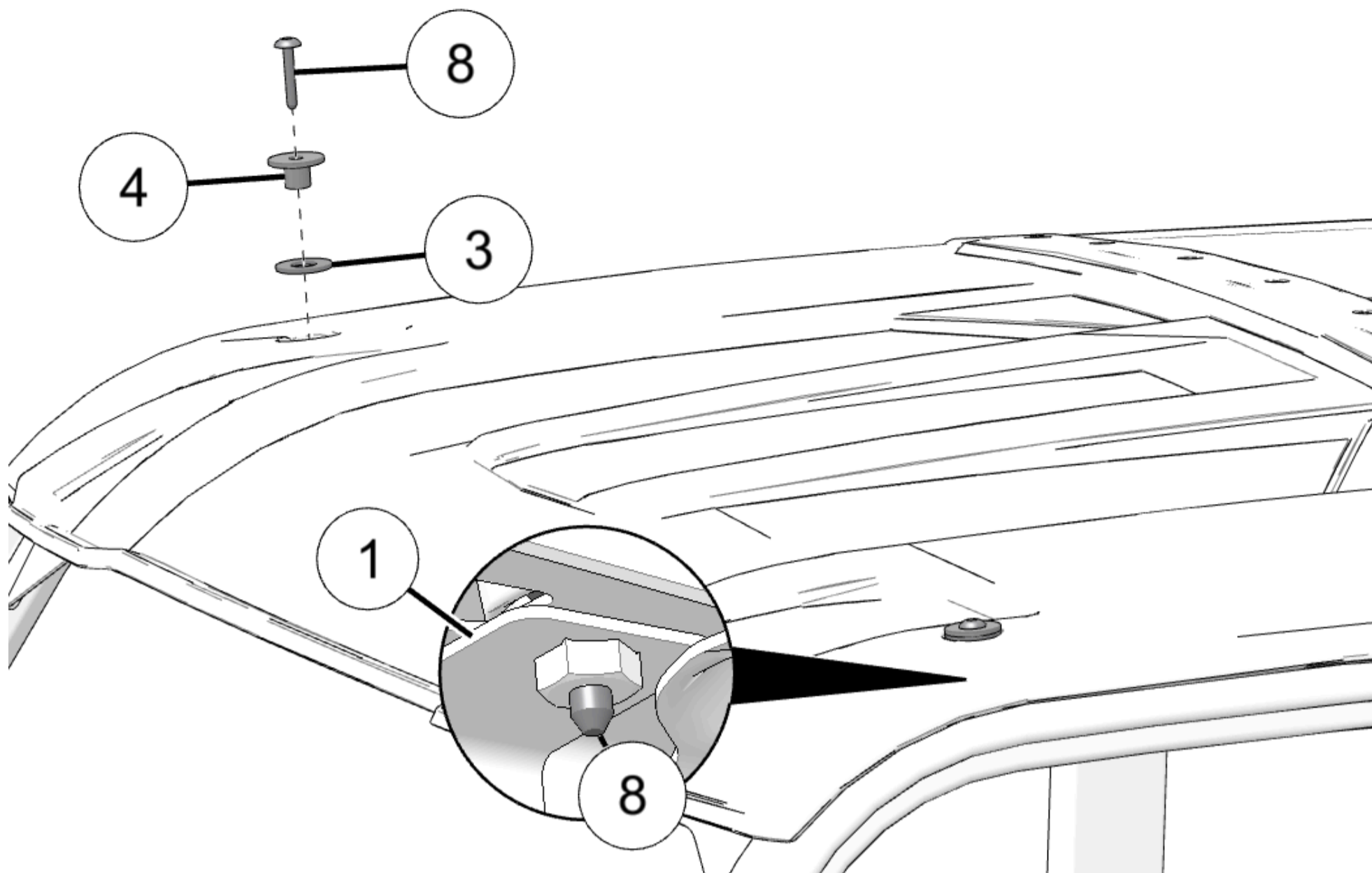

8. Torque screws to specification.

TORQUE
Screws (8):
44 in-lbs (5 N·m)