

Contents

Select Language ▼

Powered by [Google Translate](#)

ROPS Mounted Side Mirror Kit

P/N 2889243

Missing or Damaged Parts

Before beginning assembly, inspect the kit and its component(s) to be sure all parts and tools are accounted for and not damaged. If missing parts or parts are damaged, please contact your Selling Dealer for assistance.

If your accessory was purchased online, please contact POLARIS® customer service at **1-800-POLARIS** (US & Canada only).

Application

Verify accessory fitment at www.polaris.com.

IMPORTANT

Ranger and General Vehicles: ROPS Mounted Side Mirrors are NOT compatible with full doors or canvas upper doors.

Kit Contents

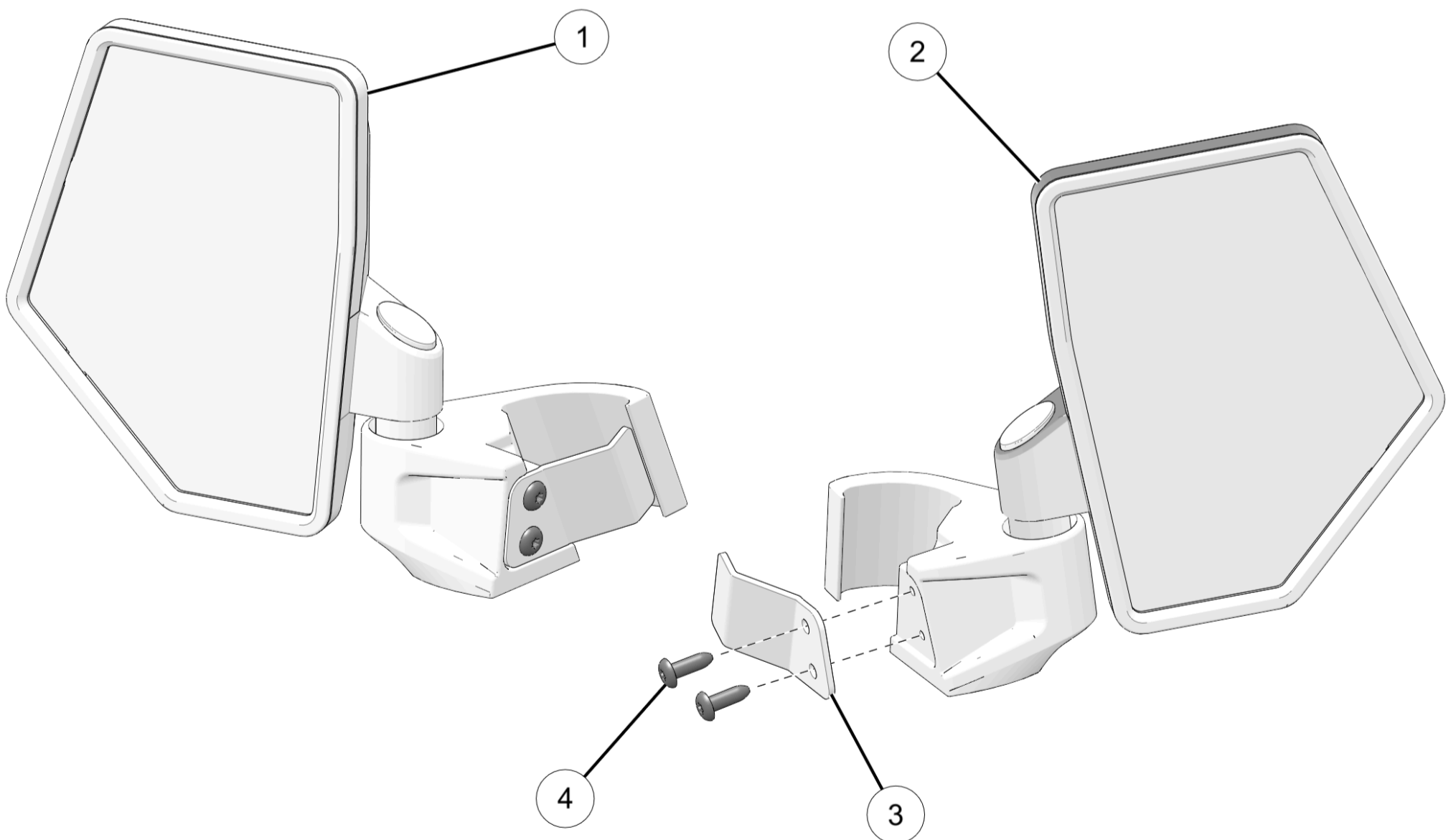

Ref	Qty	Part Description	P/N Available Separately	Available Service Kit
1	1	Assembly, Mirror, Left, ROPS	n/a	2209162
2	1	Assembly, Mirror, Right, ROPS	n/a	2209163
3	2	Assembly, Mounts, ROPS	n/a	2209165

Ref	Qty	Part Description	P/N Available Separately	Available Service Kit
4	4	Screw, Truss Head, #14 x 3/4 in	n/a	2209165

Tools Required

- Socket Set, Hex Bit, Metric
- Socket Set, Torx[®] Bit

Important

Your ROPS Mounted Side Mirror Kit is exclusively designed for your vehicle. Please read the installation instructions thoroughly before beginning. Installation is easier if the vehicle is clean and free of debris. For your safety, and to ensure a satisfactory installation, perform all installation steps correctly in the sequence shown.

Installation Instructions

Vehicle Preparation

General

1. Park vehicle on a flat surface.
2. Shift vehicle into PARK.
3. Turn key to OFF position and remove key.

Accessory Installation

NOTICE

Left side shown; right side similar.

Vehicles equipped with Lock & Ride windshield Only

1. Mark location of top edge of Lock & Ride windshield clamp.

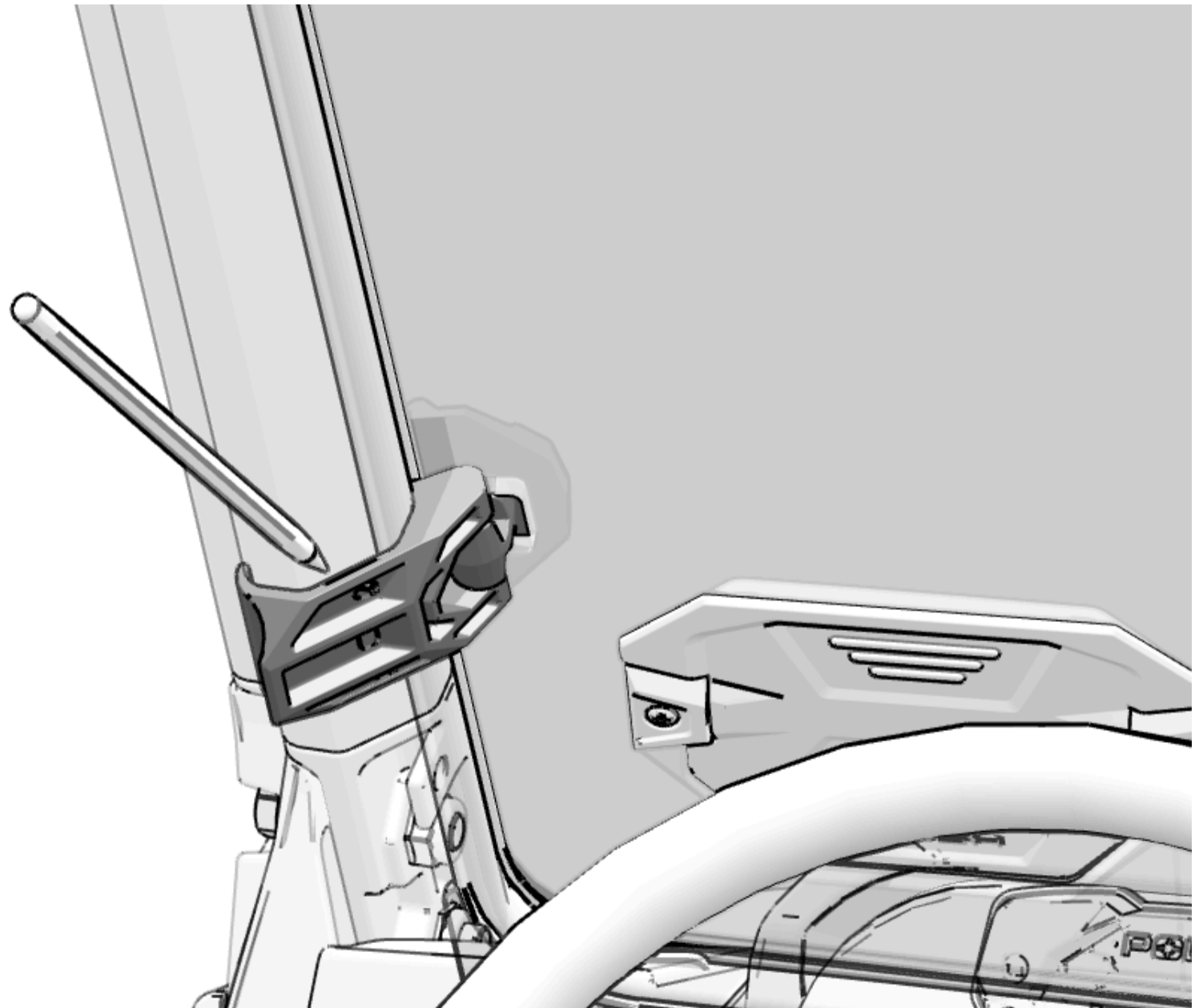

2. Remove Lock & Ride windshield.
3. Measure approximately 4 inches up from roll over protection system (ROPS) joint.

MEASUREMENT

ROPS Measurement: ~ 4 in

NOTICE

Measurement does not need to be exact. Mirror assembly clamp needs to be installed above Lock & Ride windshield clamp.

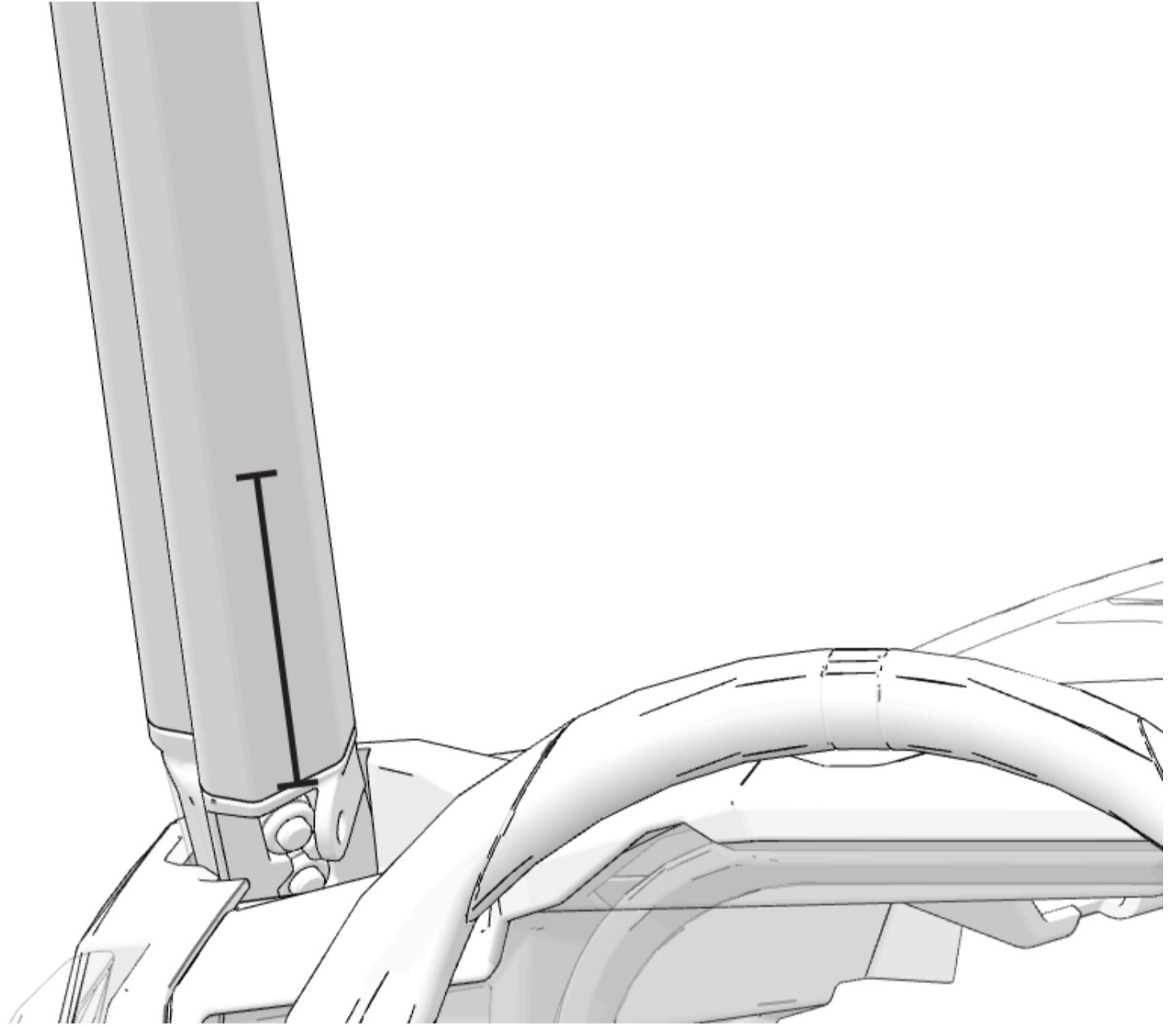

All Vehicles

1. Lock left mirror assembly ① onto driver side ROPS bar.

NOTICE

The mirror will click into place and lock onto the ROPS bar.

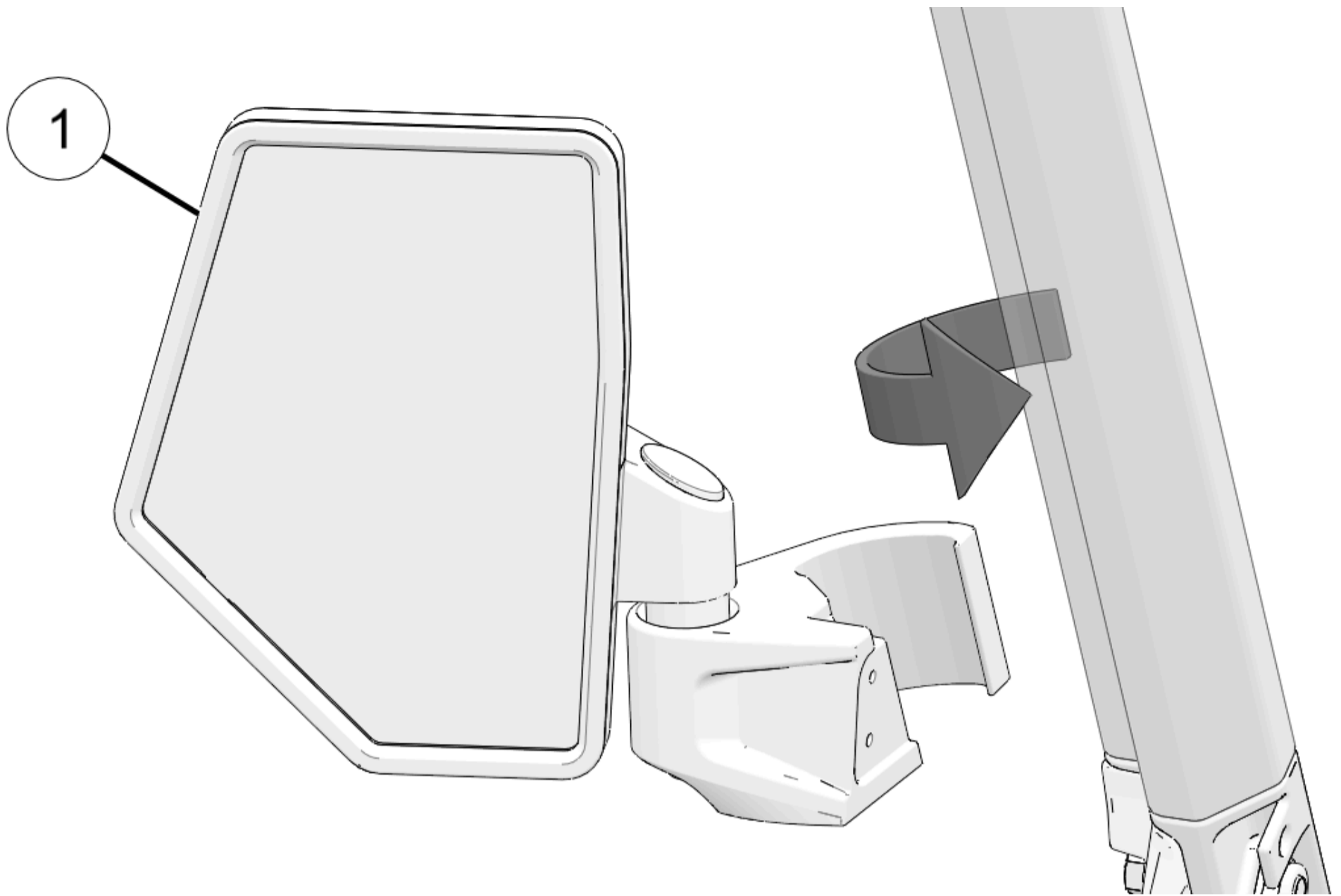

2. Install mirror plate ③ with two screws ④.

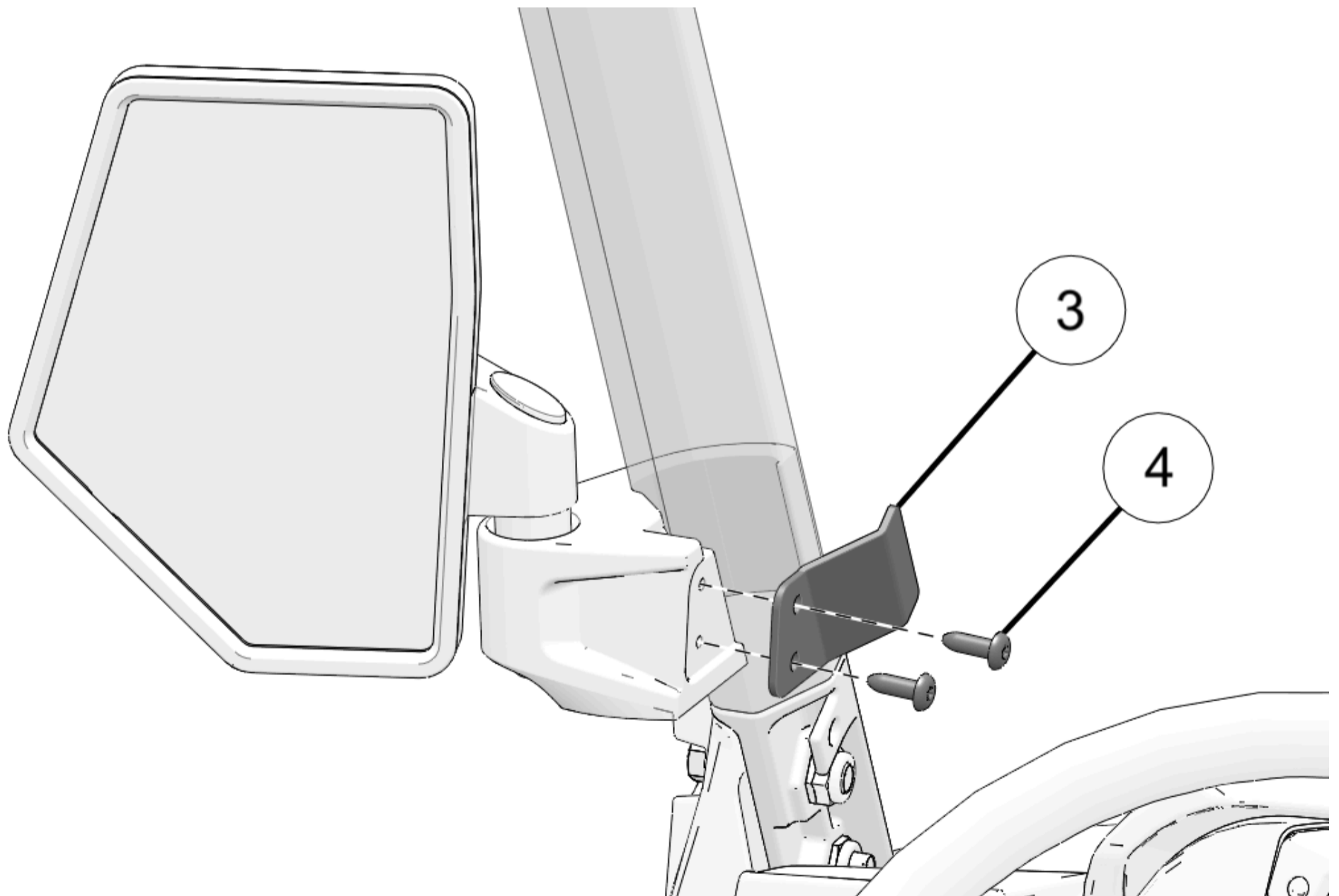

3. Tighten screws until fully seated.

Operation

1. Adjust mirrors for best visibility.
2. Tighten pivot bolt as needed.

IMPORTANT

Mirror pivot joint is designed to give way under impact to avoid potential damage. Avoid over tightening pivot bolt when in areas or situations where mirror impacts are more likely to happen. Over tightening pivot bolts could cause damage to the side mirrors in the event of an impact.

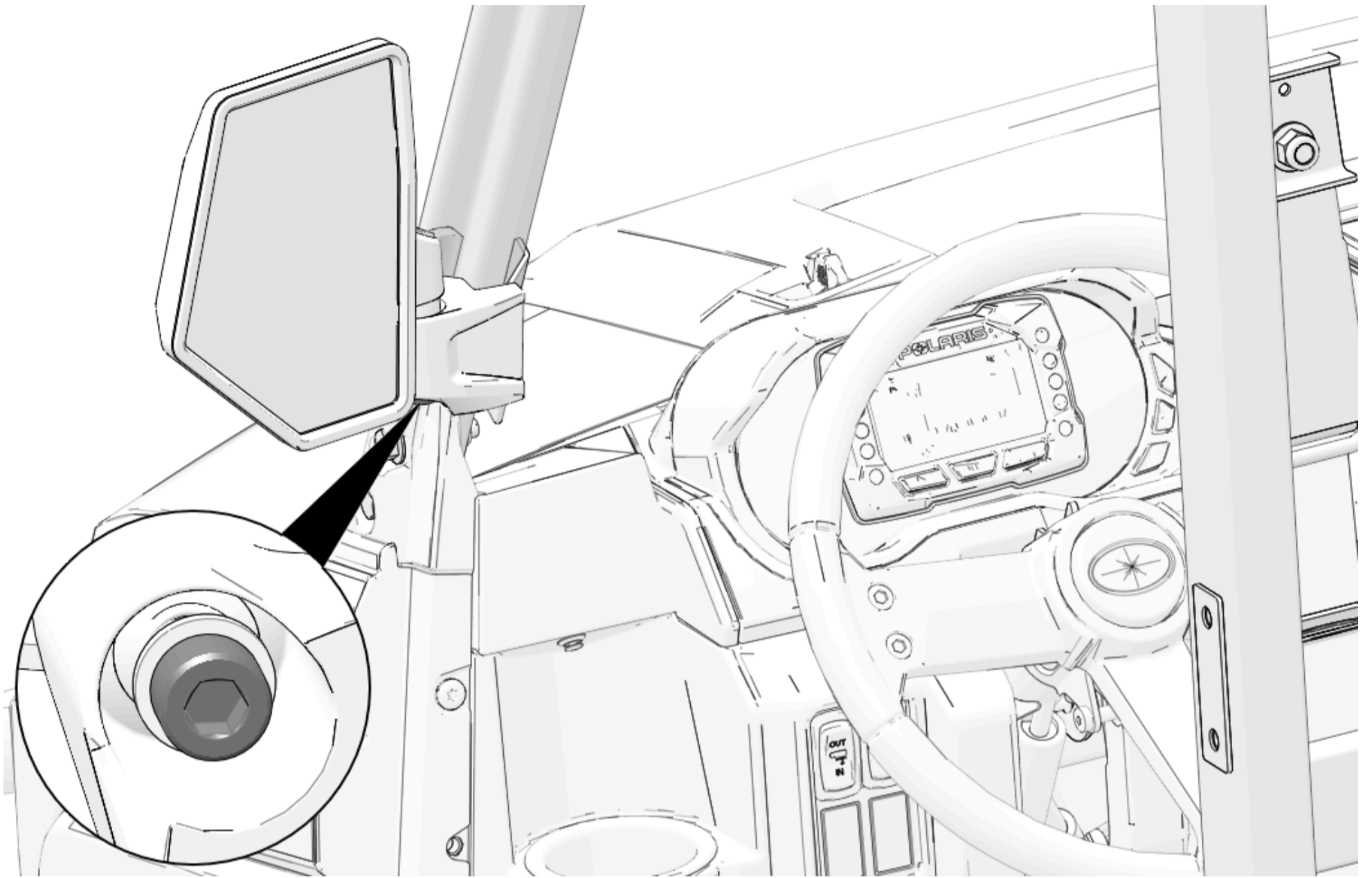

[Site Map](#)

[Privacy Policy](#)

[Accessibility](#)

© 2025 Polaris Inc.