

FOR MAINTENANCE AND SAFETY

# OWNER'S MANUAL

READ THIS MANUAL CAREFULLY. IT CONTAINS IMPORTANT SAFETY INFORMATION.  
ADULT SUPERVISION IS REQUIRED AT ALL TIMES.  
OPERATION IS PROHIBITED FOR ANYONE UNDER AGE 6.

**OUTLAW 70**

**POLARIS**

**2022**



## WARNING

Read, understand, and follow all of the instructions and safety precautions in this manual and on all product labels.

Failure to follow the safety precautions could result in serious injury or death.



## WARNING

Operating, servicing, and maintaining a passenger vehicle or off-road vehicle can expose you to chemicals including engine exhaust, carbon monoxide, phthalates, and lead, which are known to the State of California to cause cancer and birth defects or other reproductive harm. To minimize exposure, avoid breathing exhaust, do not idle the engine except as necessary, service your vehicle in a well-ventilated area and wear gloves or wash your hands frequently when servicing your vehicle.

For more information go to [www.P65Warnings.ca.gov/passenger-vehicle](http://www.P65Warnings.ca.gov/passenger-vehicle).

A card containing important ATV safety information should be attached to the owner's manual on the next page. If you cannot locate this card, or if it has been removed, please call 1-800-342-3764 for assistance.



***2022 Owner's Manual  
Outlaw 70***

## IMPORTANT SAFETY INFORMATION

Scan this QR code® with your smartphone to see an important Safety Video regarding your Polaris vehicle.

This safety video can also be found at <https://www.polaris.com/en-us/safety/>.  
If you are on the homepage of the Polaris website, click on the Rider Community heading and select “Product Safety and Training Information” from the dropdown menu to access this page.



Unless noted, all trademarks are the property of Polaris Industries Inc.

QR Code® is a registered trademark of DENSO WAVE INCORPORATED. ANSI® is a registered trademark of American National Standards Institute, Inc. NGK® is a registered trademark of NGK Spark Plug Co., Ltd.

Copyright 2021 Polaris Industries Inc. All information contained within this publication is based on the latest product information at the time of publication. Due to constant improvements in the design and quality of production components, some minor discrepancies may result between the actual vehicle and the information presented in this publication. Depictions and/or procedures in this publication are intended for reference use only. No liability can be accepted for omissions or inaccuracies. Any reprinting or reuse of the depictions and/or procedures contained within, whether whole or in part, is expressly prohibited.

The original instructions for this vehicle are in English. Other languages are provided as translations of the original instructions.

Printed in China

9940367 Rev 01



---

<b>Messages . . . . .</b>	<b>7</b>
<b>Introduction . . . . .</b>	<b>9</b>
<b>Safety . . . . .</b>	<b>17</b>
<b>Young Riders Section . . . . .</b>	<b>45</b>
<b>Features and Controls . . . . .</b>	<b>57</b>
<b>Operation . . . . .</b>	<b>65</b>
<b>Emission Control Systems . . . . .</b>	<b>87</b>
<b>Maintenance . . . . .</b>	<b>89</b>
<b>Specifications . . . . .</b>	<b>155</b>
<b>Polaris Products . . . . .</b>	<b>159</b>
<b>Troubleshooting. . . . .</b>	<b>163</b>
<b>Warranty . . . . .</b>	<b>169</b>
<b>Maintenance Log . . . . .</b>	<b>189</b>

---





## MESSAGES

### **DEAR PARENTS / SUPERVISING ADULTS:**

We believe young operators should have the opportunity to enjoy the POLARIS riding experience along with you. We've provided this owner's manual to assist you and your children / young operators in learning about safe operation and care of your new ATV.

*A POLARIS ATV is not a toy and can be hazardous to operate. Make sure any child who will operate the ATV takes a training course before operating the ATV. Make sure all operators understand and follow all of the instructions and warnings contained in this owner's manual.*

*Never allow a child under the age of 16 to operate an ATV without adult supervision. Children differ in skills, physical abilities and judgement. Some children may not be able to operate an ATV safely. Permit continued use only if you determine that your child / young operator has the ability and maturity to operate the ATV safely.*

*For your child's / young operator's safety, be sure your child / young operator can reach and operate all ATV controls, including handlebars, brake levers, throttle lever and engine stop switch.*

The preventive maintenance program outlined in this manual is designed to ensure that all critical components on your child's / young operator's ATV are thoroughly inspected at specific intervals. Follow all of the instructions and recommendations in this manual.

---

## MESSAGES

---

### **DEAR YOUNG OPERATORS:**

Before you ride your new POLARIS ATV, there are some important things that you need to know. You must learn how to keep yourself and those around you safe while you're riding. Your parents / supervising adult and Polaris want you to enjoy riding your new ATV, and that's why you need to read and understand the information in your owner's manual. You must also take an ATV training course before you begin riding.

Ask your parents / supervising adult to explain anything you don't understand and pay close attention to the warnings and instructions you read. Your safety and the safety of others is the most important thing to think about at all times. Never drive your ATV alone. Always make sure an adult is watching you when you ride.

Drive safely and enjoy riding your new POLARIS ATV!

---

## INTRODUCTION

### SAFETY SYMBOLS AND SIGNAL WORDS

The following signal words and symbols appear throughout this manual and on your vehicle. Your safety is involved when these words and symbols are used. Become familiar with their meanings before reading the manual.



DANGER indicates a hazardous situation that, if not avoided, **will** result in death to the operator, bystanders or person(s) inspecting or servicing the vehicle.



CAUTION indicates a potential hazard that may result in minor personal injury or damage to the vehicle.

# INTRODUCTION

---

## WARNING

WARNING indicates a hazardous situation that, if not avoided, **may** result in death to the operator, bystanders or person(s) inspecting or servicing the vehicle.

## NOTICE

NOTICE provides key information by clarifying instructions.

## IMPORTANT

IMPORTANT provides key reminders during disassembly, assembly, and inspection of components.

The Prohibition Safety Sign indicates an action NOT to take in order to avoid a hazard.



The Mandatory Action Sign indicates an action that NEEDS to be taken to avoid a hazard.



# INTRODUCTION

---

## VEHICLE IDENTIFICATION NUMBERS

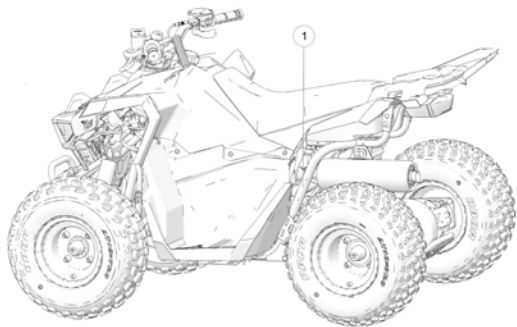

① Vehicle Identification Number (VIN)

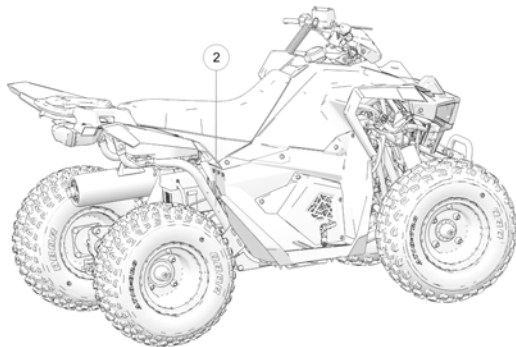

② Model Number

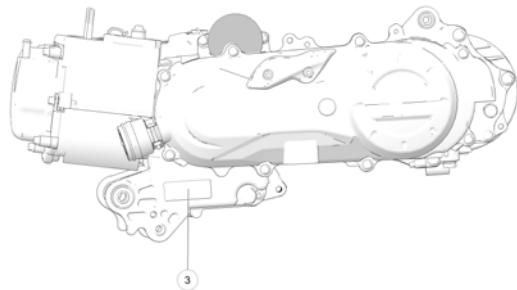

③ Engine Serial Number

Record your vehicle's identification numbers in the spaces provided. Remove the spare key and store it in a safe place. An ignition key can be duplicated only by ordering a POLARIS key blank and mating it with one of your existing keys. The ignition switch must be replaced if all keys are lost.

Vehicle Identification Number (VIN):	
Vehicle Model Number:	
Engine Serial Number:	

## INTRODUCTION

---

### WARNING

Failure to follow the warnings and safety precautions contained in this manual can result in severe injury or death. A POLARIS ATV is not a toy and can be hazardous to operate. This vehicle handles differently than other vehicles, such as motorcycles and cars. A collision or rollover can occur quickly, even during routine maneuvers like turning, or driving on hills or over obstacles, if you fail to take proper precautions.

- Read this owner's manual. Understand all safety warnings, precautions and operating procedures before operating a POLARIS ATV. Keep this manual with the ATV.
- Never operate an ATV without proper instruction. Take a training course. See page 35 for details on how to access a training course.
- For your child's safety, be sure your child can reach and operate all ATV controls, including handlebars, brake levers, throttle lever and engine stop switch.
- Always follow the age guidelines for your vehicle. Y-10+ models are designed for children not less than 10 years of age and Y- 6+ models are designed for children not less than 6 years of age. No child under the age of 16 should ride any ATV designed and sold for an adult.
- Never permit a guest to operate the ATV unless the guest has read this manual and all product labels and has completed a certified safety training course.



# POLARIS

Polaris Sales Europe Sdn  
Private (Intradita 2  
1190 Row, Switzerland  
Telephone: +41 21 212 04 700

## DECLARATION OF CONFORMITY

June 1, 2021  
Rome, Switzerland  
Polaris Sales Europe Sdn, declares that the vehicle(s) listed below conforms to the essential requirements applicable to all European countries.  
This Declaration of Conformity is issued under the sole responsibility of the Manufacturer.



### APPLICABLE EUROPEAN DIRECTIVES

2004/100/EC (EMC)  
2006/42/EC (Machinery)  
2014/53/EU (RED)  
2014/0039 (RVD)  
2014/0039 (RVD)  
2014/0039 (RVD)

### APPLICABLE HARMONISED STANDARDS

EN 12512:2010 (EMC)  
EN 12512:2010 (EMC)  
EN 12512:2010 (EMC)  
EN 12512:2010 (EMC)

### APPLICABLE UK REGULATIONS

Electromagnetic Compatibility Regulations 2016  
Machinery Regulations 2008  
Radio Equipment Regulations 2017

### APPLICABLE UK DESIGNATED STANDARDS

MODEL	TRADE NAME	VEHICLE SERIAL NUMBER
AZ, H1850/PH	Outlaw 707	

### European Community Authorized Representative:

Polaris (Europe) Ltd  
Polaris (Europe) Ltd  
Whiston 12, 85-837 Opole, POLAND

### European Community Person Authorized to Compile the Technical File

Ulrich Zwick, Product Homologation Specialist  
Polaris (Europe) Ltd  
Whiston 12, 85-837 Opole,  
Poland

Authorized Manufacturer Signatory Empowered  
to Draw Up the EC Declaration of Conformity

Rima Basal  
Vice-President EMCA

# POLARIS

Polaris Sales Europe Sdn  
Private (Intradita 2  
1190 Row, Switzerland  
Telephone: +41 21 212 04 700

### SUPPLEMENT TO THE OWNER'S MANUAL REGARDING EMISSION OF AIRBORNE NOISE AND VIBRATION PRODUCED BY THE MACHINERY AND CARBON DIOXIDE (CO<sub>2</sub>) EMISSION

A Weighted Sound Pressure at Operator's Ear dB (A) 70	C Weighted Sound Pressure Level (CP) 56	A Weighted Sound Pressure Level (AP) N/A
Weighted Speed-Axle Vibration Level (m/s <sup>2</sup> ) 1.8	Weighted Seat Vibration Level (m/s <sup>2</sup> ) 0.2	
Carbon Dioxide (CO <sub>2</sub> ) Emission (g/kWh)		
N/A		

This CO<sub>2</sub> measurement results from testing over a fixed test cycle under laboratory conditions as per (standard) engine representative of the engine type (single engine) and does not imply or guarantee any guarantee of the performance of a particular engine.

This document is setting out the contents of the EC Declaration of Conformity.  
The particulars of machinery may differ for specific models.



# SAFETY

## EUROPEAN VIBRATION AND NOISE

The driver-perceived noise and hand/arm and whole body vibration levels of this machinery is measured per EN 15997.

TYPE	MEASUREMENT	OUTLAW 70
Noise	A-Weighted Sound Pressure Level at Rider's Ear	79 dB(A) (uncertainty 3dB)
	C-Weighted Sound Pressure Level at Rider's Ear	99 dB(C) (uncertainty 3dB)
	A-Weighted Sound Power Level	Not applicable
Vibrations	Weighted Hand-Arm Vibration Level	1,6 m/s <sup>2</sup>
	Weighted Seat Vibration Level	0,2 m/s <sup>2</sup>

The operating conditions of the machinery during testing:

- Vehicles were in like-new condition.
- Environment was controlled as indicated by the test procedure(s).

# SAFETY

---

The uncertainty of vibration exposure measurement is dependent on many factors, including:

- Instrument and calibration uncertainty
- Variations in the machine such as wear of components
- Variation of machine operators such as experience or physique
- Ability of the worker to reproduce typical work during measurements
- Environmental factors such as ambient noise or temperature

---

## SAFETY WARNINGS

 **WARNING**

Failure to operate this vehicle properly can result in a collision, loss of control, accident or rollover, which may result in serious injury or death. Heed all safety warnings outlined in this section of the owner's manual and in the safety DVD provided with your vehicle.

Be sure to read all of the following warnings about driving hazards and how to avoid them. These warnings are provided for your child's safety. Be sure to explain to your young driver that the hazards outlined in this section of this owner's manual **MUST** be avoided at all times. See the OPERATION section of this owner's manual for proper operating procedures.

**FOR MORE INFORMATION ABOUT SAFETY call POLARIS at 1-800-342-3764.**

# SAFETY

---

## OPERATING WITHOUT INSTRUCTION

Operating this vehicle without proper instruction increases the risk of an accident. The operator and the supervising adult must understand how to operate the vehicle properly in different situations and on different types of terrain.

All operators must read and understand this owner's manual and all warning and instruction labels before operating the vehicle. Never allow a guest to operate this vehicle until the guest has read this manual and all product labels.



## AGE RESTRICTIONS

This vehicle is for recreational use by young operators under adult supervision ONLY. Operation is prohibited for anyone under 6 years of age.



## HANDLING GASOLINE

Gasoline is highly flammable and explosive under certain conditions.

- Never allow a child to refuel or handle gasoline.
- Always exercise extreme caution whenever handling gasoline.
- Always refuel with the engine stopped, and outdoors or in a well ventilated area.
- Do not smoke or allow open flames or sparks in or near the area where refueling is performed or where gasoline is stored.
- Do not overfill the tank. Do not fill the tank neck.
- If gasoline spills on your skin or clothing, immediately wash it off with soap and water and change clothing.

## EXPOSURE TO EXHAUST

Engine exhaust fumes are poisonous and can cause loss of consciousness or death in a short time. Never start the engine or let it run in an enclosed area.

The engine exhaust from this product contains chemicals known to cause cancer, birth defects or other reproductive harm. Operate this vehicle only outdoors or in well-ventilated areas.

# SAFETY

---

## FAILURE TO INSPECT BEFORE OPERATING

Failure to inspect and verify that the vehicle is in safe operating condition before operating increases the risk of an accident. Always inspect the vehicle before each use to make sure it's in safe operating condition.

Always follow the inspection and maintenance procedures and schedules described in this owner's manual.

## PROTECTIVE APPAREL

Operating this ATV without wearing an approved helmet increases the risk of a serious head injury in the event of an accident. Operating without eye protection could increase the chance of a serious injury in the event of an accident. Always wear an approved helmet that fits properly.

Always wear eye protection (goggles or face shield), gloves, boots, a long-sleeved shirt or jacket and long pants.





---

## USING ALCOHOL OR DRUGS

Riding in this vehicle after consuming alcohol or drugs could adversely affect operator judgment, reaction time, balance and perception. Never consume alcohol or drugs before or while operating or riding in this vehicle.



## CARRYING A PASSENGER

Carrying a passenger greatly reduces the operator's ability to balance and control the ATV, which may result in an accident or overturn. Never carry a passenger on this ATV.



# SAFETY

---

## OPERATING ON PAVEMENT

Operating an ATV on paved surfaces (including sidewalks, paths, parking lots and driveways) may adversely affect the handling of the ATV and could result in loss of control and accident or overturn.

Avoid operating the ATV on pavement. ATV tires are designed for off-road use. If it's unavoidable, travel slowly and avoid sudden turns or stops.



## OPERATING ON PUBLIC ROADS

Operating this ATV on public streets, roads or highways could result in a collision with another vehicle. Never operate the ATV on any public street, road or highway, including dirt and gravel roads. In many states it's unlawful to operate ATVs on public streets, roads and highways.



## OPERATING AT EXCESSIVE SPEEDS

Operating the ATV at excessive speeds increases the operator's risk of losing control. Always operate at a speed that's appropriate for the terrain, visibility, operating conditions, and your riding experience.



## TURNING IMPROPERLY

Turning improperly could cause loss of traction, loss of control, accident or rollover. Always follow proper procedures for turning as described in this owner's manual.

Never turn abruptly or at sharp angles. Never turn at high speeds. Practice turning at slow speeds before attempting to turn at faster speeds.

# SAFETY

---

## PHYSICAL CONTROL OF THE ATV

Removing a hand from the handlebars or feet from the footrests during operation can reduce your ability to control the vehicle or cause loss of balance and ejection from the ATV.

If the operator's foot is not firmly planted on the footrest, it could also contact the rear wheels. Never remove your hands from the handlebars while operating, and always keep both feet on the footrests.



## JUMPS AND STUNTS

Attempting wheelies, jumps and other stunts increases the risk of an accident or overturn. Never attempt wheelies, jumps, or other stunts. Avoid exhibition driving.



---

## DESCENDING HILLS IMPROPERLY

Improperly descending a hill could cause loss of control or overturn.

### NOTICE

A special technique is required when braking while traveling downhill. See page 78.

- Always follow proper procedures for traveling down hills as described in the owner's manual.
- Always check the terrain carefully before descending a hill.
- Shift your weight rearward.
- Never travel down a hill at high speed.
- Avoid traveling down a hill at an angle, which would cause the vehicle to lean sharply to one side. Travel straight down the hill when possible.

## OPERATING ON STEEP HILLS

Operating on excessively steep hills could cause an overturn. Never operate on hills too steep for the ATV or for your abilities. **Never operate the ATV on hills steeper than 15 degrees.**

# SAFETY

---

## IMPROPER HILL CLIMBING

Improper hill climbing could cause loss of control or overturn. Always follow proper procedures for climbing hills as described in the owner's manual. See page 27.



## CROSSING HILLSIDES

Driving on a sidehill is not recommended. Improper procedure could cause loss of control or overturn. Avoid crossing the side of any hill unless absolutely necessary. If crossing a hillside is unavoidable, always follow proper procedures as described in the owner's manual. See page 77. Never attempt to turn the ATV around on any hill until you've mastered the turning technique (on level ground) as described in the owner's manual. See the Turning Around on a Hill section for details.



---

## STALLING WHILE CLIMBING A HILL

Stalling, rolling backwards or improperly dismounting while climbing a hill could cause an overturn. Always maintain a steady speed when climbing a hill. If you lose all forward speed: Keep your weight uphill. Apply the brake lever gradually. When fully stopped, lock the parking brake.

*If the ATV begins rolling downhill:* Keep weight uphill. Never apply engine power. Never apply the foot brake while rolling backwards. Apply the hand brake lever slowly. When fully stopped, lock the parking brake. Dismount on uphill side, or to either side if pointed straight uphill. Turn the ATV around and remount, following the procedure described in the Owner's Manual. See page 79 for details.

## OPERATING OVER OBSTACLES

Improperly operating over obstacles could cause loss of control or overturn.

Before operating in a new area, check for obstacles. Avoid operating over large obstacles such as rocks and fallen trees. If unavoidable, use extreme caution and always follow proper operating procedures as outlined in this manual.



# SAFETY

---

## OPERATING IN UNFAMILIAR TERRAIN

Failure to use extra caution when operating on unfamiliar terrain could result in an accident or overturn. Unfamiliar terrain may contain hidden rocks, bumps, or holes that could cause loss of control or overturn.

Travel slowly and use extra caution when operating on unfamiliar terrain. Always be alert to changing terrain conditions.



## OPERATING ON SLIPPERY TERRAIN

Failure to use extra caution when operating on excessively rough, slippery or loose terrain could cause loss of traction, loss of control, accident or overturn.

Do not operate on excessively rough, slippery or loose terrain until you've learned and practiced the skills necessary to control the ATV on such terrain. Always use extra caution on rough, slippery or loose terrain.





## **IMPROPER VEHICLE MODIFICATIONS**

Improper installation of accessories or modification of the ATV may cause changes in handling, which could cause loss of control or an accident.

Never modify the ATV through improper installation or use of accessories. All parts and accessories added to the vehicle must be genuine POLARIS Industries Inc. or equivalent components designed for use on this ATV and should be installed and used according to approved instructions. An authorized dealer can assist.

## **SKIDDING OR SLIDING**

Skidding or sliding can cause loss of control or overturn (if tires regain traction unexpectedly). On slippery surfaces such as ice, travel slowly and use extra caution to reduce the chance of skidding or sliding.

## **IMPROPER TIRES AND MAINTENANCE**

Operating this vehicle with improper tires or with improper or uneven tire pressure could cause loss of control, accident or rollover.

Always use the size and type of tires specified for your vehicle. Always maintain proper tire pressure as described in this owner's manual and on safety labels.

---

## SAFETY

---

### **OPERATING ON FROZEN BODIES OF WATER**

Operating on frozen bodies of water may result in serious injury or death if the ATV and/or the operator fall through the ice. Never operate the ATV on a frozen body of water.

### **OPERATING THROUGH DEEP WATER**

Operating the ATV through deep or fast-flowing water could cause the tires to float, causing loss of control or overturn.

Avoid operating the ATV through deep or fast-flowing water. If it's unavoidable to enter water that exceeds the recommended maximum depth (see the Driving Through Water section for details):

- Travel slowly.
- Balance your weight carefully.
- Avoid sudden movements.
- Maintain a slow and steady forward motion. Do not make sudden turns or stops, and do not make sudden throttle changes.
- Wet brakes may have reduced stopping ability. After leaving water, test the brakes. Apply them lightly several times while driving. The friction will help dry out the pads.

## **IMPROPER CARGO LOADING**

Overloading the ATV or carrying/towing cargo may cause changes in handling, which could cause loss of control or an accident. Never tow or pull an object behind the ATV. A wagon, sled or other towed object does not have brakes or steering. The object may overturn or collide with other objects.

Never exceed the stated load capacity for this ATV. See page 43 for specific load capacity of this vehicle.

## **OPERATING A DAMAGED ATV**

Operating a damaged ATV can result in an accident. After any overturn or accident, have a qualified service dealer inspect the entire machine for possible damage, including (but not limited to) brakes, throttle and steering systems.

## **UNAUTHORIZED USE OF THE ATV**

Leaving the keys in the ignition can lead to unauthorized use of the vehicle, which could result in an accident or overturn. Always remove the ignition key when the vehicle is not in use.

# SAFETY

---

## PHYSICAL SKILLS

Safe operation of this rider-active vehicle requires good judgement and physical skills. Persons with cognitive or physical disabilities who operate this vehicle have an increased risk of overturn and loss of control.

## HOT EXHAUST SYSTEMS



Exhaust system components are very hot during and after use of the vehicle. Hot components can cause burns and fire. Do not touch hot exhaust system components. Always keep combustible materials away from the exhaust system.

Use caution when traveling through tall grass, especially dry grass and when traveling through muddy conditions. Always inspect the underside of the vehicle and areas near the exhaust system after driving through tall grass, weeds, brush, other tall ground cover, and muddy conditions. Promptly remove any grass, debris or foreign matter clinging to the vehicle and pay particular attention to the exhaust system area.

## SAFETY TRAINING

ATV safety training is a top priority for POLARIS. POLARIS strongly encourages you and any family members who will be riding the ATV to take a training course.

If you purchased a new POLARIS ATV in the United States, your dealer provided information about the authorized ATV *RiderCourse*<sup>SM</sup> that is available to you and your eligible family members. This training is included in the purchase price of your ATV.

In addition, you were provided with printed material and a video or DVD that instructs operators on safe operating procedures. You should review this information with your child / young operators on a regular basis. Do not allow other children to ride this ATV unless they have read the manual, seen the instructional video or DVD and taken and completed an approved ATV safety training course.

If you purchased a used POLARIS ATV in the United States, you can enroll in the ATV *RiderCourse*<sup>SM</sup> for a fee. Call ATV Enrollment Express at (800) 887-2887 or visit [www.atvsafety.org](http://www.atvsafety.org).

If you purchased a POLARIS ATV outside the United States, please contact your dealer or local law enforcement agencies for information about safety training.

**FOR MORE INFORMATION ABOUT ATV SAFETY in the United States, call the Consumer Product Safety Commission at 1-800-638-2772, or visit [www.cpsc.gov](http://www.cpsc.gov), visit [www.atvsafety.org](http://www.atvsafety.org), or call POLARIS at 1-800-342-3764.**

---

### EQUIPMENT MODIFICATIONS

Your POLARIS vehicle is designed to provide safe operation when used as directed.



Modifying this vehicle in any way can change the top speed, stability and handling performance of this vehicle. Modifications that increase speed, decrease stability or change performance may present a greater risk to inexperienced or younger operators and could result in loss of control and serious injury or death. Use only POLARIS-approved accessories to modify this vehicle. Review all vehicle changes with your child prior to operating.

The POLARIS limited warranty on your POLARIS vehicle will be terminated if any non-POLARIS-approved equipment and/or modifications have been added to the vehicle that increase speed or power.

## SAFE RIDING GEAR

Always wear the right kind of clothing and safety gear when riding your ATV.

- ① A helmet
- ② Eye protection
- ③ Long sleeve shirt
- ④ Gloves
- ⑤ Long pants
- ⑥ Over-the-ankle boots



# SAFETY

---

## HELMET

Wearing a helmet can prevent a severe head injury. Whenever riding this POLARIS vehicle, always wear a helmet that meets or exceeds established safety standards. Always buckle and pull straps tight to ensure the helmet is secured.

Parents and supervising adults should verify that the provided helmets fit properly. If a helmet doesn't fit, a new one should be obtained in the proper size.

Approved helmets in the USA and Canada bear a U.S. Department of Transportation (DOT) label.

Approved helmets in Europe, Asia and Oceania bear the ECE 22.05 label. The ECE mark consists of a circle surrounding the letter E, followed by the distinguishing number of the country which has granted approval. The approval number and serial number will also be displayed on the label.

## EYE PROTECTION

Do not depend on eyeglasses or sunglasses for eye protection. Whenever riding this POLARIS vehicle, always wear shatterproof goggles or use a shatterproof helmet face shield. POLARIS recommends wearing approved Personal Protective Equipment (PPE) bearing markings such as VESC 8, V-8, Z87.1, or CE. Make sure protective eye wear is kept clean.



### **CLOTHING**

Wear long sleeves and long pants to protect arms and legs.

### **GLOVES**

Wear gloves for comfort and for protection from sun, cold weather and other elements.

### **BOOTS**

Wear sturdy over-the-ankle boots for support and protection. Never ride a POLARIS vehicle with bare feet or sandals.

### **SAFETY LABELS AND LOCATIONS**

Warning labels have been placed on the vehicle for your protection. Read and follow the instructions of the labels on the vehicle carefully. If any of the labels depicted in this manual differ from the labels on your vehicle, always read and follow the instructions of the labels on the *vehicle*.

If an informational or graphic label becomes illegible or comes off, contact your POLARIS dealer to purchase a replacement. Replacement *safety* labels are provided by POLARIS at no charge. The part number is printed on the label.

## GENERAL ALERT

The General Alert label ① is located behind the front, left wheel well.



Before you operate this vehicle, read the owner's manual. Always use an approved helmet and protective gear. Never use with drugs or alcohol. This vehicle is not approved for use on public roads. Never operate this ATV on HILLS **steeper than 15 degrees**. NEVER carry fuel or other flammable liquids on this vehicle.

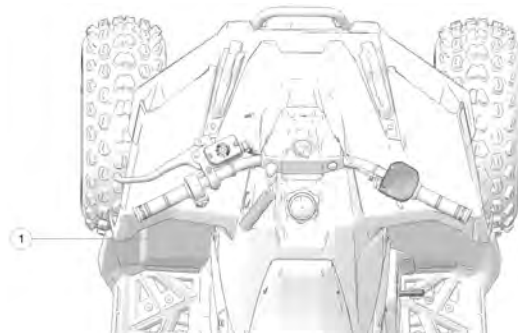

# SAFETY

## AGE / TIRE PRESSURE / LOAD ALERT

The Age / Tire Pressure / Load Alert label ② is behind the front right wheel well.

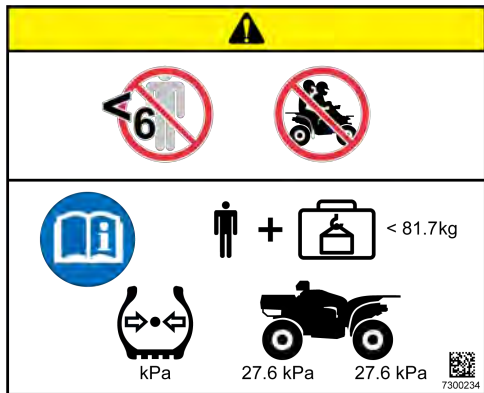
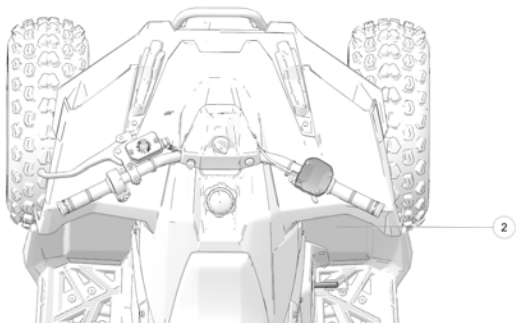

Children under age 6 are not allowed to operate this vehicle. NEVER carry a passenger. Read owner's manual before operation. Maximum weight capacity: 81.7 kg. Front and rear tire pressure: 27.6 kPa.

## RACK ALERT

The rear rack alert ③ is located on the top-facing edge of the rear rack.

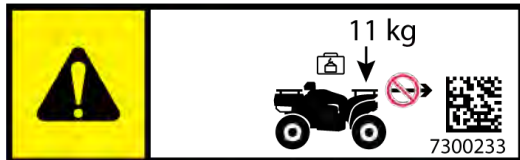

- DO NOT TOW FROM RACK OR BUMPERS. Vehicle damage or tip over may result causing severe injury or death.
- Max Rear Rack Load: 11 kg

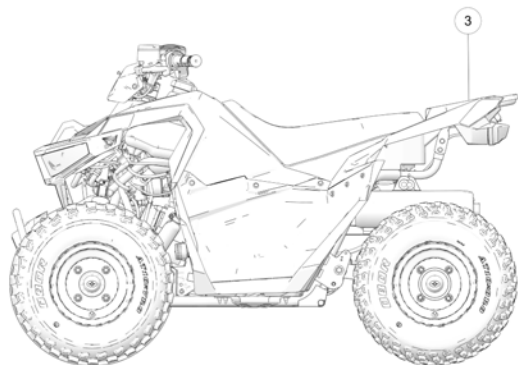

## SAFETY

### CLUTCH COVER WARNING

The clutch cover warning label ④ is located on the vehicle's clutch cover.

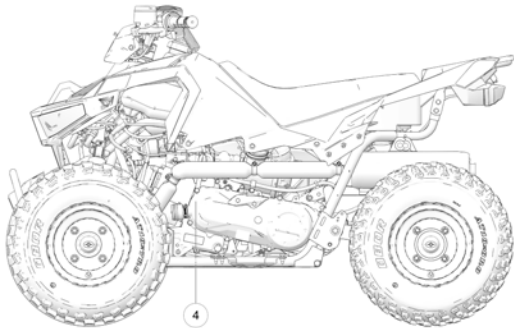

- Moving parts hazard under belt-clutch guard. To prevent serious injury, do not operate vehicle with guard removed.
- Do not modify engine or clutch. Doing so can cause part failure, possible imbalance, and excessive engine RPM which can result in serious injury or death.

## YOUNG RIDERS SECTION

### KNOW YOUR ATV

**PARENTS / SUPERVISING ADULT:** POLARIS Youth ATVs are equipped with a speed control system, allowing adults to limit vehicle speed according to rider's skill and experience. More information on speed limiting functionality can be found on page . These units are not designed for adult use. Serious vehicle damage may occur if maximum rider weight capacity is exceeded. See the vehicle specifications section for your ATV's weight capacity.

**YOUNG OPERATORS:** Before riding your new POLARIS ATV, there are important things you need to know. Safety is the most important thing to think about at all times. As the driver of the ATV, you must learn how to keep yourself, and those around you, safe while you ride.

 **WARNING**



This is the safety alert symbol. When you see this symbol on your ATV or in this manual, it means **PAY ATTENTION**. Inattention to instructions could result in serious injury or death.

## YOUNG RIDERS SECTION

---

Before an adult starts the engine for you for the first time, let's learn about the controls on your new ATV.

- ① **Engine Stop Switch:** When the engine is running, press the right-side of the switch to shut the engine off quickly. Before restarting, press the left-side of the switch to the engine start position.
- ② **Horn:** Press the horn button to sound the horn.
- ③ **Throttle Control:** Press the throttle lever with your thumb when you want your ATV to move forward. Always be sure the throttle control does not stick before you drive your ATV. Read more about this on page 51.

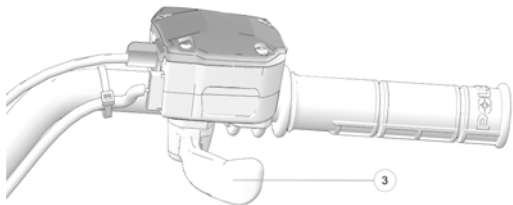
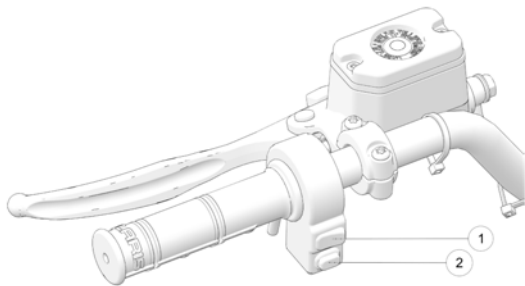



④ **Foot Brake:** The foot brake is on the right side of the ATV. Read about how to use the foot brake on page 61.

 **WARNING**

Never apply the foot brake without also squeezing the hand brake. Using the foot brake alone could cause you to lose control of the ATV and be seriously injured. Always take your thumb off the throttle when engaging brakes.

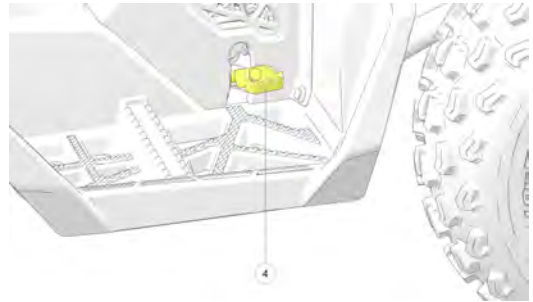

## YOUNG RIDERS SECTION

---

⑤ **Gas Cap:** The gas cap must be removed when an adult puts gas in your ATV. Never take off the gas cap. Make sure it is closed tightly.



**WARNING**

Always have an adult put gas in your ATV.  
Never try to do it yourself.

⑥ **Seat:** Remove seat by pulling firmly upward on back edge of the seat. Slide seat backward to detach front tab from the chassis. Replace seat by re-inserting the front tab into the chassis and pressing firmly down on the back of the seat to secure the grommets. Ensure seat is properly locked in place before riding.

⑦ **Hand Brake Lever:** Squeeze the brake lever toward the handlebar to slow down or stop the ATV.

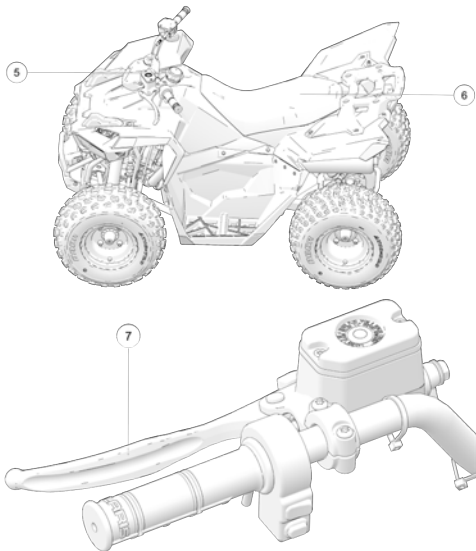

⑧ **Tether Cord and Switch** - The tether cord must always be clipped to your person and to the ATV every time you drive. If you fall off your ATV, the tether cord will pull away from the switch and the engine will stop.

 **WARNING**

Never ride without the tether cord securely attached to your clothing and to your ATV. Be careful not to let the cord get tangled around the handlebars or any part of your body.

⑨ **Ignition Switch** - Use the ignition switch to start your vehicle. The brake lever must be engaged in order to start the engine. You can also use this key to turn off the engine.

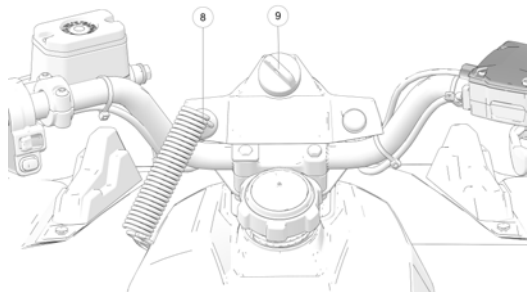

## YOUNG RIDERS SECTION

---

**Let's review the three ways to stop the engine of your ATV.**

1. Press the right side of the engine stop switch.
2. Pull the tether cord off the ATV.
3. Turn the key off.

---

## PRE-RIDE CHECK

We're almost ready to have an adult start your ATV. But before the ATV is started for the first time, you must do a Pre-Ride Check. In fact, every time you want to ride you must have an adult help you check some things on your ATV before starting it. Let's learn about these things now.

1. **Make sure the throttle doesn't stick.** Check this by pushing the throttle lever toward the handlebar and then letting go. The lever should come right back to where it was before you pushed it. If it comes back slowly or stays close to the handlebar, the ATV has a sticky throttle. This means that something is wrong or broken and must be fixed before you can ride your ATV safely.



### WARNING

Never start the engine if you have a sticky throttle. You could be seriously hurt if you ride with a sticky throttle. Have an adult or your POLARIS dealer fix the throttle before you ride.

2. **Make sure the brakes don't stick.** Check the brake lever by squeezing it toward the handlebar and then letting go. It should come right back to where it were before you squeezed. If it goes back slowly or stays close to the handlebar, your ATV has sticky brakes. The brakes must be fixed before you can ride your ATV safely.

## YOUNG RIDERS SECTION

---

### WARNING

Never start the engine if your ATV has sticky brakes. You could be seriously hurt if you ride with sticky brakes. Have an adult or your POLARIS dealer fix the sticky brakes before you ride.

- 3. Have an adult check to see if your ATV needs more gas.** Children must never fill gasoline. It must always be done by an adult. Before gas is added to your ATV, have an adult read the instructions and warnings on page 19.

### WARNING

Always have an adult put gas in your ATV. Never try to do it yourself.

- 4. Make sure seat is secure.** If you used the storage area under the seat, make sure the seat is secured in place.
- 5. Check the oil.** Have an adult check the oil level when the engine is cold. If the engine has been running, it is hot and can burn your skin, if touched. Children must never check the oil alone. An adult is responsible for keeping gas and oil levels at full marks.
- 6. Check all engine stop methods.** Perform this last check with the engine running. Verify all three ways to shut off the engine of your ATV are working properly. Do you remember what they are? If you can't remember the three ways to stop the engine, go back to the Know Your ATV section and review. Have an adult help you start the engine. Practice stopping the engine all three ways.

## RIDING RULES

Now you're ready to learn about riding your POLARIS ATV. There are some things you can do and some things you must never do. Rules are very important when you're driving an ATV. Adults have riding rules, too. Rules help keep us safe when we ride.

### NOTICE

The adult with you is your teacher. Always pay attention to what your teacher says so you can learn how to drive safely.



### WARNING

Always follow the safe riding rules found in the next few pages. You, or those around you, could be seriously hurt if safe riding rules are not followed.

## RIDING GEAR

### NOTICE

Always wear proper clothing and safety gear when riding your ATV.

**Helmet:** Your helmet is very important for safe riding. Helmets prevent severe head injuries.

**Eye Protection:** Always wear shatterproof goggles or helmet face shield. Always keep them clean so you can see where you're driving.

**Gloves:** Wear gloves to protect your hands from sun and wind. Gloves also protect your hands from possible scrapes and scratches.

**Boots:** Wear sturdy over-the-ankle boots to keep feet dry. Boots protect your feet and ankles from possible scrapes and scratches.

## YOUNG RIDERS SECTION

---

**Clothing:** Make sure your clothing fits properly. If too small, it could keep you from moving easily when shifting your weight. If too big, it could hang down and get caught in your ATV's moving parts. Wear long sleeves and long pants to protect arms and legs from injury.

### RULES TO REMEMBER

- Always attach the tether cord to your clothing and to the ATV before riding.
- Always know where you're going to drive before you start your ATV. Make sure your ATV's surrounding area is safe.
- Your ATV is designed for one rider. Never carry a passenger. A passenger will make the ATV harder to drive. You could lose control and hurt yourself and your passenger.
- Always remain seated while driving your ATV. Keep both hands on the handlebars and both feet on the footrests.
- Always be alert and pay attention to where you're driving. Pay attention to other drivers, and take more care around them because you cannot predict what they're going to do.
- Never follow another ATV too closely. You need plenty of time and space to stop your ATV.
- Never tow or pull an object behind the ATV.
- Never ride without adult supervision. An adult should always be watching in case you need help. Always drive within the sight of an adult.
- Never ride on public trails.
- Never ride your ATV on roads or over railroad tracks. Your ATV makes noise that may prevent you from hearing cars, trucks or trains that may be coming toward you.



- Never ride at night. Your ATV is not equipped with lights that are safe for driving in the dark.
- Learn where lakes, rivers, ponds and ditches are located in your driving area. Stay away from them.
- Never ride on frozen water. Driving on ice could result in serious injury or death. All ice can be dangerous!
- Only ride your ATV in safe areas where you have permission to drive. Be careful of things around you.
- Always be a polite driver. (Don't drive through the flower garden or over the little trees you planted!).
- Always do your best to help take care of nature.

**Respect your ATV.**

**Respect your environment.**

**You will earn the respect of everyone.**

**Enjoy riding your new POLARIS ATV!**



## FEATURES AND CONTROLS

### SWITCHES / BUTTONS

#### IGNITION SWITCH

To start engine, turn key clockwise to RUN position ③. Once the engine starts, release pressure on the key and allow the key to rest in the ON position ②. To avoid draining the battery, always turn key to OFF position ① when engine is not running. Always remove ignition key when vehicle is not in use.

#### IMPORTANT

Always remove the key from the ignition when trailering or transporting the ATV.

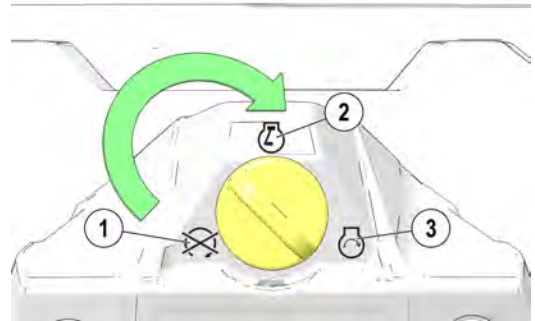

## FEATURES AND CONTROLS

---

### ENGINE STOP SWITCH

When the right-side of the engine stop switch ① is pressed down (OFF position), the engine will not start or run and all electrical power is cut off to the vehicle. In case of stuck throttle, emergency, or to stop the engine quickly, press down on the right-side of the stop switch.

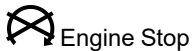

### HORN

The horn button ② is located on the left handlebar control.

Press the horn button  to sound the horn.

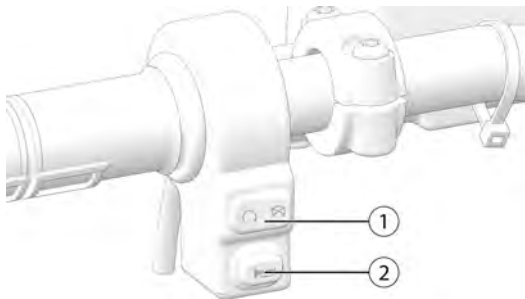

### THROTTLE CONTROLS

 **WARNING**

Operating an ATV with sticking or improperly operating throttle controls could cause an accident and lead to severe injury or death.

Never start or operate an ATV with a sticking or improperly operating throttle. Always contact your dealer or other qualified person for service if throttle problems arise.

Failure to check or maintain proper operation of the throttle system can result in an accident if the throttle lever sticks during operation.

Always check the lever for free movement and return before starting the engine. Also check occasionally during operation. The throttle release switch limits engine speed in the event of a throttle system malfunction.

Modifications to the throttle release switch could result in failure to perform as designed, which could result in an accident. Do not attempt to modify the throttle control system or replace it with any after market throttle mechanism.

Always ensure that the throttle cable is installed and properly routed to the throttle control.

## FEATURES AND CONTROLS

---

### THROTTLE LEVER

The throttle lever is located on the right handlebar. Press the throttle lever ① toward the handlebar to increase engine speed and vehicle movement. Engine speed returns to idle when the lever is released.

This ATV is equipped with a throttle release switch, which is designed to reduce the risk of a frozen or stuck throttle. If the throttle cable should stick in an open position when the operator releases the lever, engine speed will be limited to idle speed.

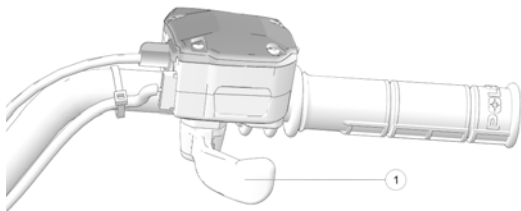

#### NOTICE

Idle RPM is preset by the manufacturer. If the engine idle speed is not satisfactory, please see your POLARIS dealer or other qualified service facility for adjustment.

### BRAKES

#### HAND BRAKE

The hand brake lever ① controls both front and rear brakes. Squeeze the brake handle toward the handlebar to apply the front brakes.

#### FOOT BRAKE

The foot brake ② controls the rear brakes only. Step down on the brake pedal to apply rear brakes.



Applying only the foot brake could cause loss of control and result in serious injury or death. If using the foot brake, apply both brake levers at the same time.

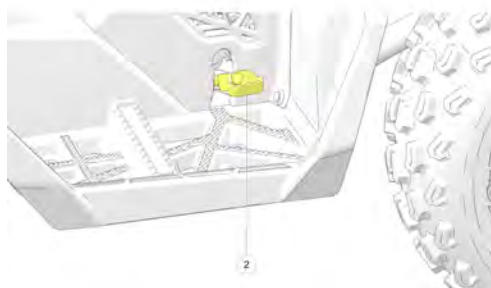
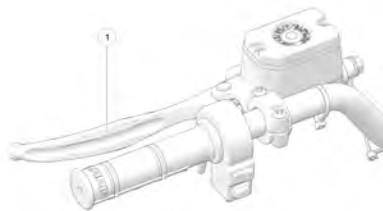

## FEATURES AND CONTROLS

### PARKING BRAKE

Always lock the parking brake whenever the vehicle is left unattended. To engage the parking brake, follow these steps:

1. Squeeze the left brake lever.
2. Push the parking brake lock ③ to the second notch to lock the brake lever in place.
3. Release the brake lever.

To release the parking brake, squeeze and release the brake lever. The parking brake will release automatically.

#### WARNING

Operating the ATV while the parking brake is engaged could cause an accident resulting in serious injury or death. It could also result in driveline or engine damage. Always be sure to disengage the parking brake before operating the ATV.

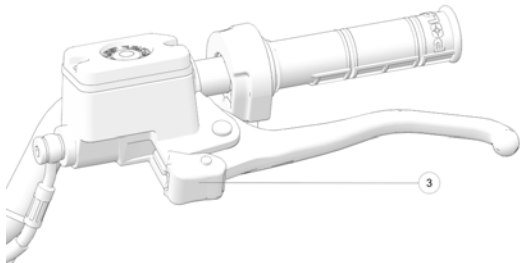



### INDICATOR LIGHT

Polaris Youth ATVs are not equipped with lights designed for driving in the dark. Do not operate this ATV after dark. Use caution and drive at reduced speeds in conditions of reduced visibility. This ATV is designed for off-road use only. Do not operate this ATV on streets or highways.

① **Check Engine:** A flashing light indicates an overheated engine. The system will automatically reduce engine power. A solid light indicates an EFI-related fault has occurred. Do not operate the ATV if light is on. Serious engine damage could result. Your POLARIS dealer or other qualified technician can assist.

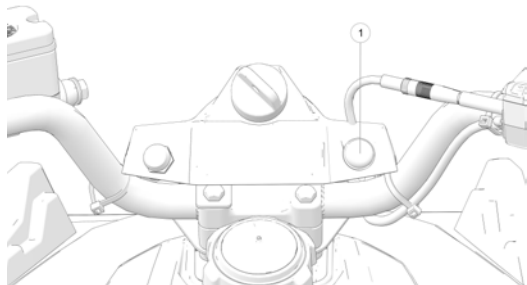

## FEATURES AND CONTROLS

### FUEL SYSTEM

#### GAS CAP

The fuel tank filler cap ① is located directly below the handlebars.

#### NOTICE

This ATV is not equipped with a low fuel indicator light. The fuel indicator gauge is located on top of the fuel cap. Always check fuel indicator to ensure proper levels before riding.

Use unleaded gasoline with a minimum pump octane number of 87=(R+ M/2) octane. Non-ethanol fuel is recommended.

*Do not use fuel with ethanol content greater than 10 percent, such as E-85 fuel.*

Refer to the Specifications chapter for fuel tank capacity.

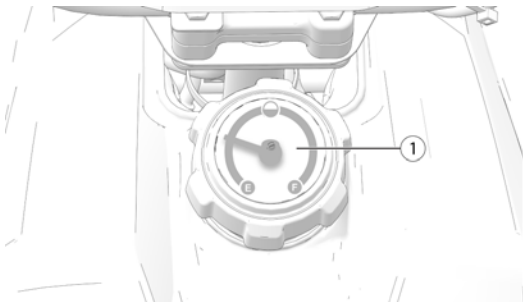

Unleaded Gasoline  
**Minimum 87 Octane Rating**

---

## OPERATION

 **WARNING**

Failure to operate the vehicle properly can result in a collision, loss of control, accident or rollover, which may result in serious injury or death. Read and understand all safety warnings outlined in the safety section of this owner's manual.

### **VEHICLE BREAK-IN PERIOD**

The break-in period for your new Polaris vehicle is defined as the first ten hours of operation, or the time it takes to use the first two full tanks of gasoline.

No single action on your part is as important as a proper break-in period. Careful treatment of a new engine and drive components will result in more efficient performance and longer life for these components. Perform the following procedures carefully.

## OPERATION

---

1. Fill the fuel tank with gasoline. Always exercise extreme caution whenever handling gasoline. Never allow a child to handle gasoline.
2. Check the oil level. See page 104. Add the recommended oil as needed to maintain the oil level in the safe operating range.
3. Drive slowly at first. Select an open area that allows room to familiarize yourself with operation and handling.
4. Vary throttle positions. Do not operate at sustained idle.
5. Perform regular checks on fluid levels, controls and areas outlined on the daily pre-ride inspection checklist. See page 67.

### *NOTICE*

Excessive heat build-up during the first three hours of operation will damage close-fitted engine parts and drive components. Do not operate at full throttle or high speeds during the first three hours of use. Mixing brands or using a non-recommended oil may cause serious engine damage. Always use the recommended oil. Never substitute or mix oil brands.

## PRE-RIDE INSPECTION



**CAUTION**

Failure to inspect and verify that the vehicle is in safe operating condition before operating increases the risk of an accident. Always inspect the vehicle before each use to make sure it's in safe operating condition.

ITEM	REMARKS	PAGE
Brake system	Ensure proper operation	See page 121.
Front suspension	Inspect, lubricate if necessary	See page 102.
Rear suspension	Inspect, lubricate if necessary	See page 102.
Steering	Ensure free operation, lubricate if necessary	See page 124.
Tires	Inspect condition and pressure	See page 40 for label locations and page 134 for tires.

## OPERATION

ITEM	REMARKS	PAGE
Wheels/fasteners	Inspect, ensure fastener tightness; check that axle nuts are secured by cotter pins	See page 134.
Frame nuts, bolts, fasteners	Inspect, ensure tightness	-
Fuel and oil	Ensure proper levels	See page 40 for label locations and page 64 for fuel system.
Grass and debris	Remove grass and debris from the vehicle, especially on the underside and near the exhaust system	-
Throttle	Ensure proper operation	See page 51 and page 59.
Engine Stop Switch	Ensure proper operation	See page 58.
Air filter, pre-filter	Inspect and clean, or replace	See page 131.

---

ITEM	REMARKS	PAGE
Running lights	Ensure proper operation	See page 138.
Brake light	Ensure proper operation	See page 140.
Drive Chain	Check condition and slack; refer to drive chain adjustment	See page 127.
Loose or Damaged components	Visually inspect for any damaged components or loose fasteners	-
Riding Gear	Wear helmet, goggles, protective clothing	See page 37.

### **SAFE OPERATION PRACTICES**

1. Complete the recommended safety training before operating this vehicle. See page 35.
2. Do not allow anyone under age 6 to operate the vehicle.
3. Never carry a passenger on this ATV.
4. Engine exhaust fumes are poisonous. Never start the engine or let it run in an enclosed area. Never allow a child to handle gasoline.
5. Never exceed the maximum weight capacity of the vehicle. When determining the weight you are adding to the vehicle, include the weight of the operator, accessories and loads on the racks (if equipped). The combined weight of these items must not exceed the maximum weight capacity.
6. Ride this vehicle only in areas permitted by a supervising adult. Never operate the vehicle on pavement or on any public street, road or highway, including dirt and gravel roads.
7. Drive in a manner appropriate for your skills and operating conditions. Never operate at excessive speeds. DO NOT attempt to do power slides, “donuts”, jumps or other driving stunts. Keep both hands on the steering wheel at all times.
8. Never consume alcohol or drugs before or while operating this vehicle.



9. Always use the size and type of tires specified for your vehicle. Always maintain proper tire pressure.
10. Never operate a damaged vehicle. After any rollover or accident, have a qualified service dealer inspect the entire machine for possible damage.
11. Never operate the vehicle on a frozen body of water.
12. Do not touch hot exhaust system components. Always keep combustible materials away from the exhaust system.
13. Always remove the ignition key when the vehicle is not in use to prevent unauthorized use.

# STARTING THE ENGINE

### *NOTICE*

Operating the vehicle immediately after starting could cause engine damage. Allow the engine to warm up for several minutes before operating the vehicle.

Follow the steps below for proper engine start procedure:

1. Sit on the vehicle. Attach the tether cord to the ATV and clip to your clothing.
2. Push the engine stop switch to the ON position.
3. Set the parking brake or engage the brake lever. The brake lever must be engaged or the engine won't start.
4. Do not press the throttle while starting the engine. Turn key clockwise to start engine. Immediately release ignition key when the engine starts.

## STOPPING THE ENGINE

1. Release the throttle completely.
2. Apply the brakes until the vehicle stops moving.
3. Stop the engine. There are three ways to stop the engine:
  - Turn the key off.
  - Push the engine stop switch down.
  - Pull the tether cord off the ATV.
4. Lock the parking brake.
5. To avoid draining the battery, always turn the key to the OFF position when the engine is not running.

## OPERATION

---

### **DRIVING PROCEDURE**

1. Sit upright with both feet on the footrests and both hands on the handlebars.
2. Start the engine and allow it to warm up.
3. Check your surroundings and determine your path of travel.
4. Slowly press the throttle with your right thumb and begin driving.
5. Drive slowly at first. Practice turning and using the throttle and brakes on level surfaces.

---

## MAKING TURNS

Your ATV is equipped with a solid rear axle, which drives both rear wheels equally at all times. This means that the wheel on the outside of the turn must travel a greater distance than the inside wheel when turning and the inside tire must slip traction slightly.

To turn, steer in the direction of the turn, leaning your upper body to the inside of the turn while supporting your weight on the outer footrest. This technique alters the balance of traction between the rear wheels, allowing the turn to be made smoothly.

Practice making turns at slow speeds.



Turning improperly can result in vehicle overturn. Never turn abruptly or at sharp angles. Never turn at high speeds.

## OPERATION

---

### **DRIVING UPHILL**

Braking and handling are greatly affected when operating in hilly terrain. Improper procedure could cause loss of control or overturn. Whenever traveling uphill, follow these precautions:

1. Drive straight uphill.
2. Avoid steep hills (15° maximum).
3. Always check the terrain carefully before ascending any hill.
4. Never climb hills with excessively slippery or loose surfaces.
5. Keep both feet on the footrests.
6. Shift body weight uphill.
7. Proceed at a steady rate of speed and throttle opening. Opening the throttle suddenly could cause the ATV to flip over backwards.
8. Never go over the top of any hill at high speed. An obstacle, a sharp drop, or another vehicle or person could be on the other side of the hill.
9. Remain alert and be prepared to take emergency action. This may include quick dismounting of the vehicle.

## DRIVING ON A SIDEHILL (SIDEHILLING)

Driving on a sidehill is not recommended. Improper procedure could cause loss of control or overturn. Avoid crossing the side of any hill unless absolutely necessary.

If crossing a sidehill is unavoidable, follow these precautions:

1. Slow down.
2. Lean into the hill, transferring your upper body weight uphill while keeping your feet on the footrests.
3. If the vehicle begins to slide or tip, quickly turn the front wheel downhill, if possible, or dismount on the uphill side *immediately!*

## OPERATION

---

### **DRIVING DOWNHILL**

When driving downhill, follow these precautions:

1. Avoid steep hills (15° maximum).
2. Shift body weight uphill. Transfer your weight to the rear of the vehicle.
3. Drive straight downhill.
4. Slow down. Excessive speed when traveling downhill can cause loss of control.
5. Apply the brakes very slightly to aid in slowing.



---

## TURNING AROUND ON A HILL

If the vehicle stalls while climbing a hill, never back it down the hill! Use the K-turn to turn around.

1. Stop the vehicle and lock the parking brake while keeping body weight uphill.
2. Shut off the engine.
3. Dismount on the uphill side of the vehicle, or on the left if the vehicle is pointing straight uphill.
4. Staying uphill of the ATV, turn the handlebars full left.
6. While holding the brake, release the parking brake lock and slowly release the brake, allowing the ATV to roll around to your right until it's pointing across the hill or slightly downward.
7. Lock the parking brake and remount the ATV from the uphill side, keeping body weight uphill.
8. Restart the engine and squeeze the brake lever.
9. Release the parking brake and drive slowly, controlling speed with the brake, until the ATV is on more level ground.



## OPERATION

---

### **PARKING ON A HILL OR INCLINE**

Avoid parking on a hill or incline if possible. If it's unavoidable, follow these precautions:

1. Stop the engine.
2. Lock the parking brake.
3. Always block the rear wheels on the downhill side as shown in the illustration.

#### *NOTICE*

Do not employ parking brake for extended periods of time.

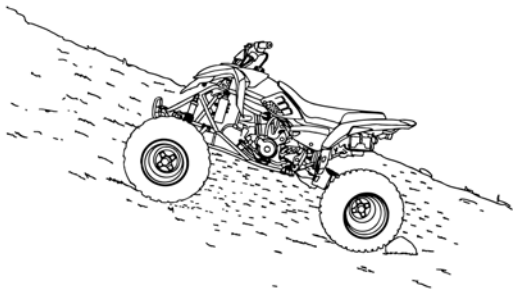

---

## DRIVING ON SLIPPERY SURFACES

Whenever riding on slippery surfaces such as wet trails or loose gravel, or during freezing weather, follow these precautions:

1. Do not operate on excessively rough, slippery or loose terrain.
2. Slow down when entering slippery areas.
3. Maintain a high level of alertness, reading the trail and avoiding quick, sharp turns, which can cause skids.
4. Never apply the brakes during a skid. Correct a skid by turning the handlebars *in the direction of the skid* and shifting your body weight forward.

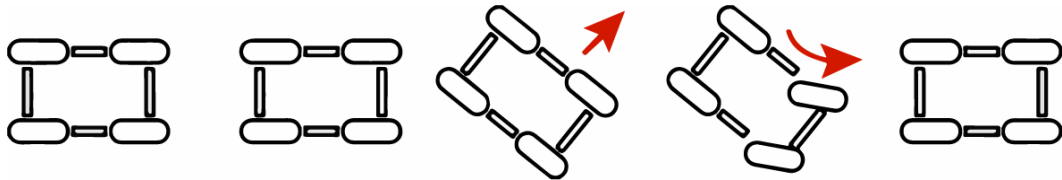

### **DRIVING OVER OBSTACLES**

Follow these precautions when operating over obstacles:

1. Always check for obstacles before operating in a new area.
2. Look ahead and learn to read the terrain. Be constantly alert for hazards such as logs, rocks and low hanging branches.
3. Travel slowly and use extra caution when operating on unfamiliar terrain. Not all obstacles are immediately visible.
4. Never attempt to operate over large obstacles, such as rocks or fallen trees.

---

## DRIVING THROUGH WATER

Your ATV can safely operate through shallow water. The recommended maximum depth for your ATV is below the bottom of the footrests. Follow these precautions when operating through water:

1. Determine water depth and current before entering water.
2. If crossing a stream, choose a crossing where both banks have gradual inclines.
3. Avoid operating through deep or fast-flowing water.
4. After driving through water, dry the brakes by applying light pressure to the levers (while moving) until braking action is normal. If you do not perform this procedure, your brakes may be ineffective.



## OPERATION

---

### *NOTICE*

Serious engine damage can result if the vehicle is not thoroughly inspected after operating in water deeper than the footrest level. As soon as possible, perform the inspections and maintenance services outlined in the Periodic Maintenance Chart section. Engine oil, gear case oil and all grease fittings need special attention.

If the vehicle tips or overturns in water, or if the engine stops during or after operating in water, service is required before starting the engine. Your POLARIS dealer can provide this service. If it's impossible to bring the vehicle in before starting the engine, perform the service outlined in the Vehicle Immersion section, and take the vehicle in for service at the first opportunity.

## **HAULING CARGO**

The OUTLAW 70 is equipped with a rear rack designed to carry small loads. Read and follow all instructions for hauling cargo on the following pages.

 **WARNING**

Overloading the vehicle or carrying cargo improperly can alter vehicle handling and may cause loss of control, resulting in serious injury or death. Always follow these precautions when hauling cargo:

- Slow down. Allow more space for stopping the ATV when hauling cargo.
- Never exceed weight capacities for the vehicle. See the Rack Warning label specifications on page 43.
- Secure all cargo before driving. Loose cargo may move or shift, causing loss of control or tipover. Use suitable tie-downs or rope to secure cargo. Do not allow cargo or tie straps to hang over the edges of the racks.
- Carry only small loads that fit on the rack. Tall loads raise the vehicle's center of gravity and may cause loss of control or tipover.
- Never allow a person to ride on the rack.
- Never tow or pull an object behind the ATV. A wagon, sled or other object towed behind an ATV does not have brakes or steering. The object may overturn or collide with other objects and cause serious injuries.





# EMISSION CONTROL SYSTEMS

## POLLUTANT EMISSIONS

Engine exempt from NRMM pollutant emissions Regulation (EU) 2016/1628.

Engine used in reduced-scale vehicle model for recreational purposes, net power < 19 kW.

## NOISE EMISSION CONTROL SYSTEM

Do not modify the engine, intake or exhaust components, as doing so may affect compliance with U.S.

A. EPA noise control requirements (40 CFR 205) and local noise level requirements.

## OPERATION ON PUBLIC LANDS IN THE U.S.A.

Your vehicle has a spark arrestor that was tested and qualified to be in accordance with the USFS standard 5100-1a. Federal law requires that this spark arrestor be installed and functional when the vehicle is operated on public lands.

Operation of off-road vehicles on public lands in the U.S.A. is regulated by 43 CFR 420. Violations are subject to monetary penalties. Federal regulations can be viewed online at <https://ecfr.federalregister.gov/current/title-43/subtitle-B/chapter-1/part-420>.

## EMISSION CONTROL SYSTEMS

---

### **CRANKCASE EMISSION CONTROL SYSTEM**

This engine is equipped with a closed crankcase system. Blow-by gases are forced back to the combustion chamber by the intake system. All exhaust gases exit through the exhaust system.

### **EXHAUST EMISSION CONTROL SYSTEM**

Exhaust emissions are controlled by engine design. An electronic fuel injection (EFI) system controls fuel delivery. The engine and EFI components are set at the factory for optimal performance and are not adjustable.

The emissions label is located on the inside of the lower left frame tube (below driver's foot area).

### **ELECTROMAGNETIC INTERFERENCE**

This spark ignition system complies with Canadian ICES-002.

This vehicle complies with the EMC requirements of UN ECE Regulation 10.

**Non-ionizing Radiation:** This vehicle emits some electromagnetic energy. People with active or non-active implantable medical devices (such as heart monitoring or controlling devices) should review the limitations of their device and the applicable electromagnetic standards and directives that apply to this vehicle.

# MAINTENANCE

## PERIODIC MAINTENANCE

Any qualified repair shop or person may maintain, replace or repair the emission control devices or systems on your vehicle. An authorized POLARIS dealer can perform any service that may be necessary for your vehicle. POLARIS also recommends POLARIS parts for emissions-related service, however equivalent parts can be used.

It is a potential violation of the Clean Air Act if a part supplied by an aftermarket parts manufacturer reduces the effectiveness of the vehicle's emission controls. Tampering with emission controls is prohibited by federal law.

Owners are responsible for performing the scheduled maintenance identified in this owner's manual. Careful periodic maintenance will help keep your vehicle in safe, reliable condition. Inspect, clean, lubricate, adjust and replace parts as necessary. When inspection reveals the need for replacement parts, genuine POLARIS parts are available from your POLARIS dealer. Equivalent parts may be used for emissions-related service.

# MAINTENANCE

---

## TOOL KIT

To help you perform routine maintenance, a tool kit ① is provided in the storage compartment under the seat. Maintenance intervals in the following charts are based upon average riding conditions and an average vehicle speed of approximately 8 miles per hour.

Vehicles subjected to severe use must be inspected and serviced more frequently.

Record maintenance and service in the Maintenance Log beginning on page 189.



---

## CHART KEY

SYMBOL	DESCRIPTION
XU	Perform these procedures more often for vehicles subjected to severe use.
D	Have an authorized Polaris dealer or other qualified person perform these services.

## SEVERE USE DEFINITION

- Frequent immersion in mud, water or sand
- Frequent or prolonged operation in dusty environments
- Short trip cold weather operation
- Racing or race-style high RPM use
- Prolonged low speed, heavy load operation
- Extended idle

## MAINTENANCE

---

Pay special attention to the oil level. A rise in oil level during cold weather can indicate contaminants collecting in the oil sump or crankcase. Change oil immediately if the oil level begins to rise. Monitor the oil level, and if it continues to rise, discontinue use and determine the cause. Your dealer can assist.

## MAINTENANCE CHART



Improperly performing the procedures marked with a **D** could result in component failure and lead to serious injury or death. Have an authorized Polaris dealer or other qualified person perform these services.

Perform all services at whichever maintenance interval is reached first. Record maintenance and service in the Maintenance Log.

## MAINTENANCE

ITEM		MAINTENANCE INTERVAL (WHICHEVER COMES FIRST)			REMARKS
		HOURS	CALENDAR	MILES (KM)	
	Steering	-	Daily	-	Check each day before driving the vehicle. Make adjustments as needed. See the Pre-Ride Checklist.
	Front Suspension				
	Rear Suspension	-	Daily	-	Check each day before driving the vehicle. Make adjustments as needed. See the Pre-Ride Checklist.
	Tires				
	Brake Lever Travel				
	Brake System				

## MAINTENANCE

ITEM		MAINTENANCE INTERVAL (WHICHEVER COMES FIRST)			REMARKS
		HOURS	CALENDAR	MILES (KM)	
	Wheels / Fasteners				
	Frame Fasteners				
	Engine Oil Level	-	Daily	-	Check each day before driving the vehicle. Make adjustments as needed. See the Pre-Ride Checklist.
	Air Filter	-	Daily	-	Inspect; clean often; replace as needed.
	Air Box Sediment Tube	-	Daily	-	Drain deposits when visible.



## MAINTENANCE

ITEM		MAINTENANCE INTERVAL (WHICHEVER COMES FIRST)			REMARKS
		HOURS	CALENDAR	MILES (KM)	
	Running Lights / Taillight	-	Daily	-	Check operation; apply dielectric grease if replacing.
	Drive Chain and Sprockets	-	Daily	-	Inspect daily, adjust as needed, check often if driving in wet conditions.
	CVT Housing	-	Daily	-	Drain water as needed, check often if driving in wet conditions.
	Break-In Maintenance	After first 10 hours of operation			Perform break-in maintenance.

## MAINTENANCE

ITEM		MAINTENANCE INTERVAL (WHICHEVER COMES FIRST)			REMARKS
		HOURS	CALENDAR	MILES (KM)	
<b>XU D</b>	Brake Lever Travel / Brake Freeplay	10	Monthly	100 (160)	Inspect periodically.
	Spark Plug	10	Monthly	100 (160)	Clean; check condition; adjust gap; replace as needed.
	Fuel System	20	Monthly	-	Inspect; cycle key to pressurize fuel pump; check lines and fittings for leaks and abrasion.
	Battery	20	Monthly	200 (320)	Check terminals; clean; test.

## MAINTENANCE

ITEM		MAINTENANCE INTERVAL (WHICHEVER COMES FIRST)			REMARKS
		HOURS	CALENDAR	MILES (KM)	
<b>XU</b>	Engine Oil Change	30	6 Mo	300 (480)	Change oil and oil filter.
<b>XU</b>	Transmission Oil	40	12 Mo	400 (640)	Drain and change oil.
<b>XU</b>	Oil Pre-Filter Screen	40	12 Mo	400 (640)	Clean filter at every oil change; clean annually if ATV is operated less than 10 hours.
<b>XU</b>	General Lubrication	50	3 Mo	500 (800)	Lubricate all fittings, pivots, cables, etc.
<b>D</b>	Valve Clearance	50	3 Mo	500 (800)	Check clearance; see your dealer for adjustments.

## MAINTENANCE

ITEM		MAINTENANCE INTERVAL (WHICHEVER COMES FIRST)			REMARKS
		HOURS	CALENDAR	MILES (KM)	
<b>D</b>	Throttle Cable / Release Switch	50	6 Mo	500 (800)	Inspect, adjust, lubricate; replace if necessary.
	Throttle Body Intake Duct	50	6 Mo	500 (800)	Inspect duct for proper sealing/air leaks.
<b>D</b>	Drive Belt	50	6 Mo	500 (800)	See your POLARIS dealer.
<b>XU D</b>	Brake Pad Wear	50	6 Mo	500 (800)	See your POLARIS dealer.

## MAINTENANCE

ITEM		MAINTENANCE INTERVAL (WHICHEVER COMES FIRST)			REMARKS
		HOURS	CALENDAR	MILES (KM)	
<b>D</b>	Fuel System	100	12 Mo	600 (1000)	Cycle key to pressurize fuel pump; check fuel line, vent line, fuel pump, and fill cap for leaks or signs of abrasion. Replace as needed.
<b>XU</b>	Engine Mounts	100	12 Mo	1000 (1600)	Inspect.
	Exhaust System	100	12 Mo	1000 (1600)	Inspect.
<b>D</b>	Ignition Timing	100	12 Mo	1000 (1600)	Inspect.

## MAINTENANCE

ITEM		MAINTENANCE INTERVAL (WHICHEVER COMES FIRST)			REMARKS
		HOURS	CALENDAR	MILES (KM)	
<b>XU</b>	Wiring	100	12 Mo	1000 (1600)	Inspect for wear, routing, security; apply dielectric grease to connectors subjected to water, mud, etc.
<b>D</b>	Clutches (Drive / Driven)	100	12 Mo	1000 (1600)	Inspect; clean; replace worn parts.
<b>D</b>	Front Hub Bearings / Rear Axle Bearings	100	12 Mo	1000 (1600)	Inspect; replace as needed.

# MAINTENANCE

ITEM		MAINTENANCE INTERVAL (WHICHEVER COMES FIRST)			REMARKS
		HOURS	CALENDAR	MILES (KM)	
	Spark Arrester	300	36 Mo	3000 (4800)	Clean out.
<b>D</b>	Toe Adjustment	-			Inspect periodically; adjust as needed.

## MAINTENANCE

---

### LUBRICATION RECOMMENDATIONS

ITEM	LUBE	METHOD
Engine Oil	PS-4 10W-50 4-Cycle Oil	See page 104.
Transmission Oil (Main Gearcase)	AGL Gearcase Lubricant & Transmission Fluid	See page 111.
Drive Chain	POLARIS Chain Lube or SAE 80/90	See page 126.
Front Arm Suspension (A-Arm Pivots)	POLARIS All Season Grease or grease conforming to NLGI No. 2	Inspect; tighten fasteners; grease (also after washing ATV or driving in water).
Steering Post	POLARIS All Season Grease or grease conforming to NLGI No. 2	Inspect; tighten fasteners; grease.

Perform these procedures more often for vehicles subjected to severe use.



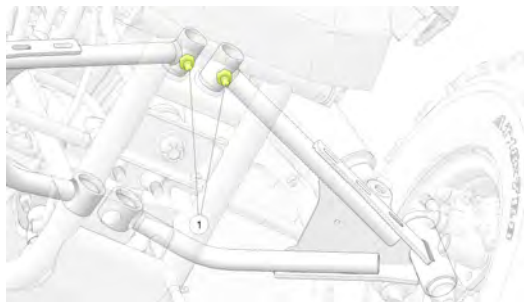

① A-Arm Pivot Grease Points

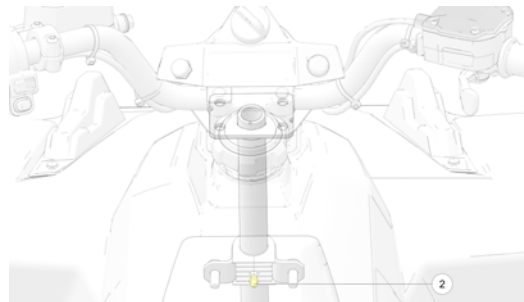

② Steering Post Grease Point

# MAINTENANCE

## ENGINE OIL

### OIL RECOMMENDATIONS

Always check and change the engine oil at the intervals outlined in the Periodic Maintenance Chart section. POLARIS recommends the use of POLARIS PS-4 Extreme Duty 10W-50 4-Cycle Oil for this vehicle. Oil may need to be changed more frequently if POLARIS oil is not used. Do not use automotive oil. See page 159 for the part numbers of POLARIS products.

#### NOTICE

Mixing brands or using a non-recommended oil may cause serious engine damage. Always use the recommended oil. Never substitute or mix oil brands.

## OIL CHECK

Maintain oil level within safe range on the dipstick. Do not overfill.

1. Position vehicle on a level surface and remove oil access cover.
2. Remove dipstick ①. Wipe dry with a clean cloth.
3. Reinsert dipstick completely.
4. Remove dipstick and check oil level.
5. Add recommended oil as needed.
6. Reinsert the dipstick.

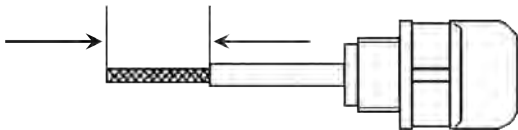

## TIP

A rising oil level between checks in cool weather driving may indicate contaminants, such as gas or moisture, collecting in the crankcase. If oil level is over the full/safe mark, change the oil immediately.

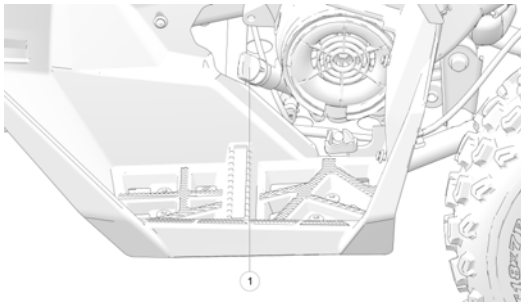

# MAINTENANCE

## OIL CHANGE

1. Position the vehicle on a level surface. Set the parking brake.
2. Start the engine. Allow it to idle for two to three minutes. Then stop the engine.
3. Place a drain pan under the engine crankcase.
4. Open the oil access door.
5. Clean the area around the drain plug.
6. Remove the oil drain plug and allow the oil to drain completely.

### WARNING

Hot oil can cause burns to skin. Do not allow hot oil to contact skin.

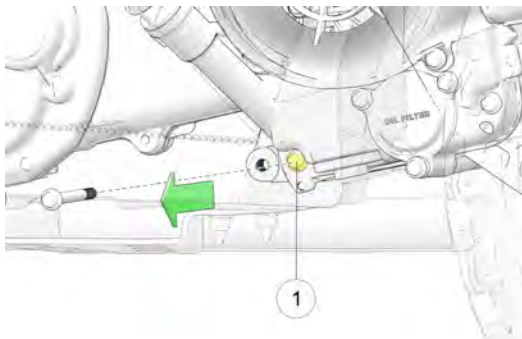

7. Re-install oil drain plug and torque to specification.

### TORQUE

Oil Drain Plug  
**10 ft-lbs (13 N·m)**

8. Remove the oil spring-loaded screen plug ② through the bottom of the chassis.

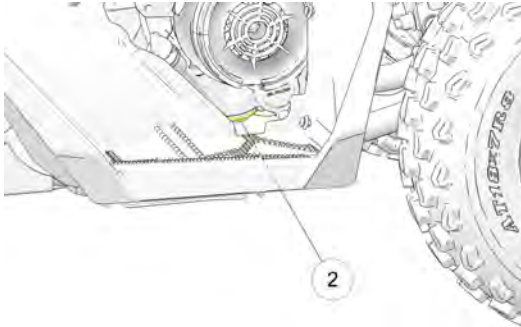

9. Wash the screen ③ with solvent to remove any debris. Allow the screen to air dry.
10. Inspect the O-ring ④ on the plug and replace if needed.

## NOTICE

The sealing surfaces on the spring plug and the engine crankcase should be clean and free of burrs, nicks, or scratches.



## MAINTENANCE

---

11. Reassemble the screen and spring back into the plug.
12. Reinstall the plug through the bottom of the chassis and torque to specification

### TORQUE

Oil Spring-Loaded Screen Plug  
**10 ft-lbs (13 N·m)**

13. Remove the oil fill cap / dipstick. Add Polaris-recommended lubricant. Do NOT overfill.

### FLUID CAPACITY

**Recommended Lubricant**  
Polaris PS-4 Extreme Duty Synthetic 4-Cycle  
Engine Oil  
**Capacity**  
27 fl oz (800 mL)

14. Reinstall the dipstick.
15. Start the engine. Allow it to idle for one to two minutes.
16. Stop the engine and inspect for leaks.
17. Check the oil level. Add oil as needed to bring the level to the upper mark on the dipstick.
18. Dispose of used oil properly.

### IMPORTANT

Always inspect the oil filter immediately following an oil change. See page 108.

## OIL FILTER CHANGE

1. Position the vehicle on a flat surface.
2. Clean area around the drain plug.

3. Run engine for two to three minutes until warm.
4. Stop the engine.

**⚠ CAUTION**

Hot oil can cause burns to skin. Do not allow hot oil to contact skin.

5. Place a drain pan beneath the engine crankcase.
6. Remove the oil access panel and locate the oil filter cap on the crankcase.
7. Loosen the bottom screw ① until free from threading. Pull outward until flush with the footwell.

8. Remove the top two screws ② from the top of the oil filter cap.



9. Pull cap ③ outward until spring is free from filter bore, then rotate cap downward.

## MAINTENANCE

---

10. Remove large O-ring, ④ and oil filter ⑤ from filter bore.

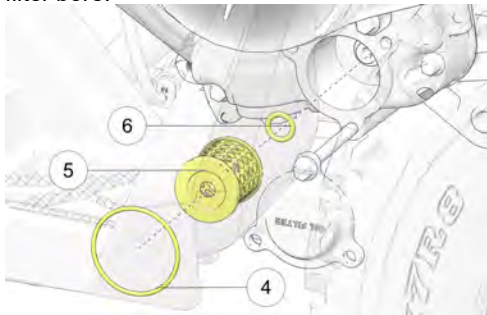

11. Visually inspect the small O-ring ⑥ for damage. Replace if needed.

### *NOTICE*

Do NOT remove the small O-ring unless damage is present. Unnecessary removal may cause damage to the O-ring and prevent a proper seal.

12. Verify the oil filter is clean. If needed, clean the oil filter with brake cleaner to remove any debris. Allow the oil filter to air dry.
13. Check the outer screen of the oil filter and large O-ring for damage. Replace if needed.



14. Reinstall the O-ring and oil filter back into the filter bore.
15. Install the engine oil filter cap and torque bolts to specification.

**TORQUE**

Engine Oil Filter Cap Bolts  
**80 in-lbs (9 N·m)**

## TRANSMISSION (MAIN GEARCASE)

Always check and change the fluid at the intervals outlined in the Periodic Maintenance Chart beginning on page 92. Polaris recommends the use of AGL Gearcase Lubricant & Transmission Fluid for this vehicle.

## FLUID CHANGE

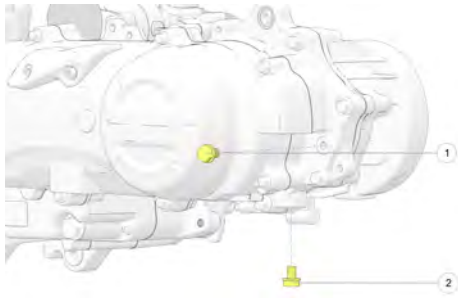

1. Position vehicle on a level surface and remove fill plug ①.
2. Place a drain pan under the drain plug ②.
3. Remove the drain plug. Allow the fluid to drain completely.

## MAINTENANCE

---

4. Clean the drain plug.
5. Reinstall and torque drain plug to specification with new o-ring.
6. Add recommended oil. Maintain oil level at the bottom of the fill plug hole threads.
7. Reinsert fill plug.
8. Check for leaks.
9. Discard used fluid properly.

### TORQUE

Drain Plug  
**14 ft-lbs (19 N·m)**

### FLUID CAPACITY

Main Gearcase  
**4.5 fl oz (133 mL)**

## CYLINDER HEAD TORQUE

Have your dealer or other qualified person check the ATV cylinder head for proper torque at first service — or after 25 hours.

---

## VEHICLE IMMERSION

### NOTICE

If your vehicle becomes immersed, major engine damage can result if the machine is not thoroughly inspected. Take the vehicle in for service before starting the engine. Your POLARIS dealer can provide this service. If it's impossible to take your vehicle to a dealer before starting it, follow the steps outlined below. This procedure will allow for *short-term operation only* to drive the ATV to a trailer or towing vehicle.

1. Move the vehicle to dry land or, at minimum, to water below the footrests.
2. Check the air box for any water and dry if water is present.
3. Remove the spark plug.
4. Turn the engine over several times using the electric start.
5. Dry the spark plug and reinstall it, or install a new plug.
6. Attempt to start the engine. If necessary, repeat the drying procedure.
7. Take the vehicle in for service as soon as possible, whether you succeed in starting it or not. Your POLARIS dealer can provide the required service.
8. If water has been ingested into the transmission follow the procedure on page 116 for drying the CVT.

### SPARK PLUGS

#### SPARK PLUG GAP/TORQUE

Refer to the specifications section for spark plug and gap specifications.

#### NOTICE

Spark plug condition is indicative of engine operation. The spark plug firing end condition should be read after the engine is warmed up and the vehicle is driven at higher speeds. Immediately check the spark plug for correct color. Using non-recommended spark plugs can result in serious engine damage. Always use POLARIS-recommended spark plugs or their equivalent.

#### WARNING

A hot exhaust system and engine can cause burns. Wear protective gloves when removing a spark plug for inspection.

#### SPARK PLUG CONDITION

##### Normal Plug

The tip should not be white. A white insulator tip indicates overheating, caused by use of an improper spark plug or incorrect throttle body adjustments.

##### Wet Fouled Plug

The wet fouled insulator tip is black. A damp oil film covers the firing end. There may be a carbon layer over the entire nose.

Generally, the electrodes are not worn. General causes of fouling are excessive oil, use of non-recommended injection oil or incorrect throttle body adjustments.

## SPARK PLUG REMOVAL AND REPLACEMENT

1. Remove the spark plug cap.
2. Using the spark plug wrench provided in the tool kit, remove the plug by rotating it counter-clockwise.
3. Reverse the procedure for spark plug installation. Torque to specification.

### TORQUE

Spark Plug  
**14 ft-lbs (19 N·m)**

# CONSTANT VARIABLE TRANSMISSION (CVT) SYSTEM

 **WARNING**

Failure to comply with the instructions in this warning can result in severe injury or death. Do not modify any component of the CVT system. Doing so may reduce its strength so that a failure may occur at a high speed. The CVT system has been precision balanced. Any modification will cause the system to be out of balance, creating vibration and additional loads on components.

- Always follow all recommended maintenance procedures. See your POLARIS dealer, or other qualified person, for service and repair assistance.
- This CVT system is intended for use on POLARIS products only. Do not install it in any other product.
- Always make sure the CVT housing is securely in place during operation.

## SPARK ARRESTER

### WARNING

Failure to heed the following warnings while servicing the spark arrester could result in serious injury or death.

- Do not perform service on the spark arrester while the system is hot. Allow components to cool sufficiently before proceeding.
- Wear eye protection and gloves.
- Never operate without the spark arrester.
- Never run the engine in an enclosed area. Exhaust contains poisonous carbon monoxide gas.

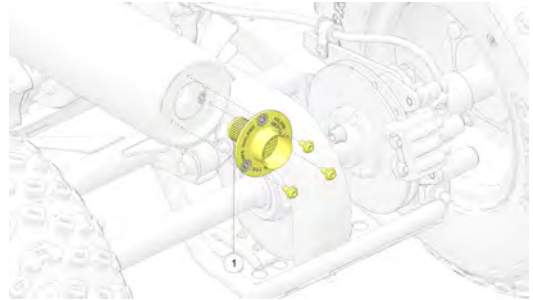

### ① Arrester Screen

To remove accumulated carbon, clean the spark arrester at the intervals recommended in the Periodic Maintenance Chart section.

## MAINTENANCE

---

1. Remove the three bolts and remove the arrester from the end of the muffler.
2. Use a non-synthetic brush to clean the arrester screen. A synthetic brush may melt if components are warm. If necessary, blow debris from the screen with compressed air.
3. Inspect the screen for wear and damage. Replace the arrester if damage is found.
4. Reinstall the arrester.
5. Torque the bolts to specification.

### TORQUE

Spark Arrester Bolts  
**7 ft-lbs (9.5 N·m)**



---

## SPEED CONTROL AND THROTTLE SYSTEM

### NOTICE

Per ANSI® / SVIA<sup>SM</sup>-1-2010 (sec. 6.2) AS DELIVERED TO THE CONSUMER, the speed of youth models is restricted to 10 MPH or less for the Y-6+ models and 15 MPH or less for the Y-10+ models.

*The dealer CANNOT, under any circumstances, either prior to the sale or later, even at the consumer's request, remove or adjust any speed limiting devices.*

This vehicle has an adjustable speed control system that controls engine RPM and speed of the vehicle. The speed limiting device may be adjusted by supervising adults when they determine that the operator is capable of safely handling additional speed.

Per ANSI® / SVIA<sup>SM</sup>-1-2010 (sec. 6.1) the unrestricted top speed is 15 MPH or less for the Y-6+ models and 30 MPH or less for the Y-10+ models.

## MAINTENANCE

### THROTTLE STOP AND SPEED CONTROL SYSTEM

Have an adult use the following procedure to control the speed range of the ATV:

1. Locate throttle adjuster behind front left tire.
2. Loosen throttle adjuster jam nut and turn stud clockwise to increase vehicle speed.
3. Turn stud counterclockwise to reduce vehicle speed.
4. After adjusting stud to desired vehicle speed, torque the jam nut to specification.

#### TORQUE

Throttle Adjuster Jam Nut  
**15 ft-lbs (20 N·m)**

5. Cycle throttle lever several times to verify cable function.

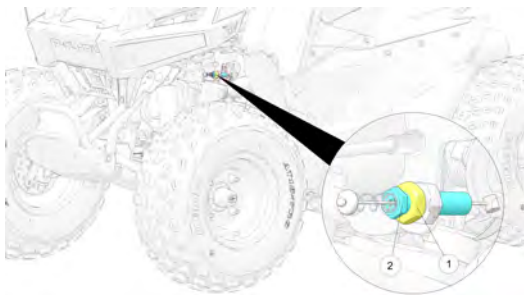

- ① Throttle Adjuster Jam Nut
- ② Throttle Adjuster Stud

## BRAKES

### NOTICE

Should any brake issues be discovered, see your POLARIS dealer or other qualified technician for service.

### BRAKE FREEPLAY

Check (measure) the freeplay of the foot brake at the intervals recommended in the Periodic Maintenance Chart beginning on page 92. If the freeplay isn't at specification, see your POLARIS dealer or other authorized technician for service.

### Brake Freeplay Specifications

Hand Brake	Foot Brake
No measurement necessary.	.12"-.25" (3-6 mm)

### BRAKE LEVER FUNCTION

Check brake lever travel at the intervals recommended in the Periodic Maintenance Chart beginning on page 92.

Always service the brakes when there is no longer sufficient stopping ability at the specified lever travel setting.

## MAINTENANCE

---

### HAND BRAKE

The front and rear brakes are hydraulic disc brakes, activated by moving the single brake lever toward the handlebar. These brakes are self-adjusting.

The following checks are recommended to keep the brake system in good operating condition. Check more often if brakes are used heavily under normal operation.

1. Always keep brake fluid at an adequate level. See the Master Cylinder/Brake Fluid section for details.
2. Check the brake system for fluid leaks.
3. Check the brakes for excessive travel or spongy feel.

4. Check the friction pads for wear, damage and looseness. Replace brake pads when they are worn to .030" (0.762 mm).
5. Check the security and surface condition of the disc. Clean any grease using a recommended brake cleaner or alcohol. Do not use spray lubricants or other petroleum-based products. If you discover any damage (cracks, excessive corrosion, warping) see your dealer for service before operating.

### AUXILIARY FOOT BRAKE

The hydraulic auxiliary brake system requires no adjustment. Check the brake fluid level (under seat) frequently for the auxiliary brake system.

## TOE ALIGNMENT

Polaris recommends zero toe alignment for Outlaw 70. Check using the procedure below.

**⚠ WARNING**

Severe injury or death can result from improper toe alignment and adjustment. Do not attempt to adjust tie rod alignment. All tie rod adjustments should be performed by an authorized POLARIS dealer or other qualified service facility.

1. Position the vehicle on a level surface.
2. Place the handlebars in a straight-ahead position.

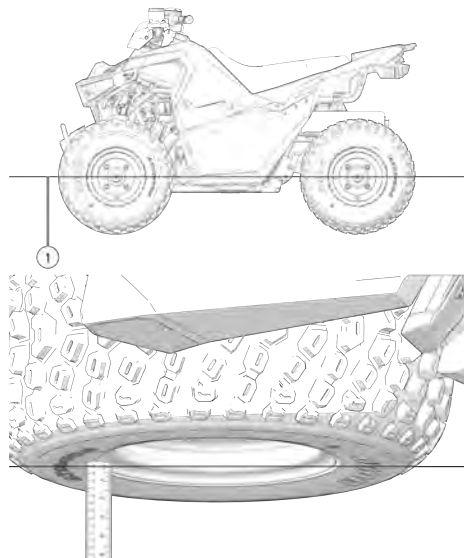

## MAINTENANCE

---

3. Tie a length of string ① between two stands. Position the stands so that the string is flush with the side of the rear tire. If available, you may use a long straightedge instead of string.
4. Measure the distance from the string to the rim at the front and rear of the front rim. The rear measurement should be equal to the front measurement to obtain zero toe alignment.
5. Repeat the measurement procedure on the other side of the vehicle.
6. If you discover improper alignment, see your POLARIS dealer for service.

### MEASUREMENT

Recommended Toe Alignment  
**0.0 in (0.0 mm)**

## STEERING INSPECTION

Check the steering assembly periodically for loose nuts and bolts. If loose nuts and bolts are found, see your POLARIS dealer or other qualified service facility before operating the vehicle.

## CAMBER AND CASTER

The camber and caster are non-adjustable.

## SHOCK SPRING ADJUSTMENT

### WARNING

Uneven adjustment may cause poor handling of the vehicle, which could result in an accident. Always adjust both the left and right spring preloads ① equally or have your POLARIS dealer perform the adjustments.

The front and rear shock absorber springs are adjustable to increase or decrease spring preload. Rotate the adjuster ① either clockwise or counter-clockwise to make adjustments.

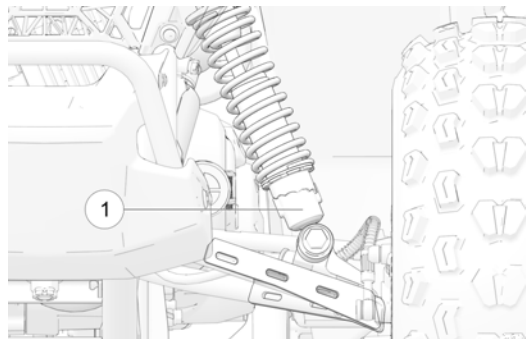

### DRIVE CHAIN

#### DRIVE CHAIN LUBRICATION

Lubricate the drive chain with Polaris chain spray lube or an approved chain lube at the general lubrication interval specified on page 92.

Lubricate more often under severe use, such as dirty or wet conditions. See page 159 for the part numbers of Polaris products.

#### *NOTICE*

Washing the drive chain with a high pressure washer or gasoline can cause premature wear and drive chain failure. Don't use a high pressure washer or gasoline to clean the drive chain.

Adjusting or operating the vehicle with improper rear drive chain slack can result in severe damage to the transmission and drive components. Always make sure the slack is within the stated specifications.



## DRIVE CHAIN SLACK INSPECTION

1. Move the vehicle slightly forward to gain chain deflection.
2. Collapse rear suspension by applying downward force to rear bumper. This will position the rear axle and drive chain in the tightest configuration.
3. If the slack needs adjustment, see page 128.

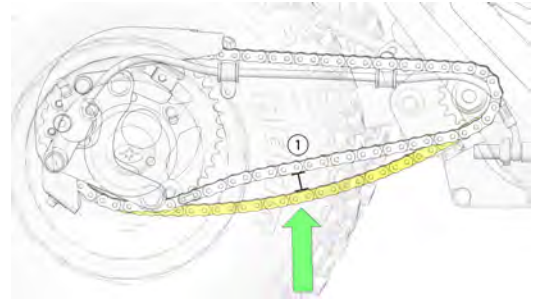

Drive Chain Tension:  
**1/4"-1/2" (6-12 mm) Deflection**

## MAINTENANCE

### DRIVE CHAIN SLACK ADJUSTMENT

1. Lift the vehicle to ensure both rear tires are off the ground.
2. (Optional) Remove both rear tires for ease of access.
3. Loosen the four axle bearing housing fasteners ①.
4. Loosen either the inner or outer eyelet screw jam nuts ② on each side of the vehicle.

#### NOTICE

RH side shown.

#### NOTICE

Make sure you adjust each jam nut equally.

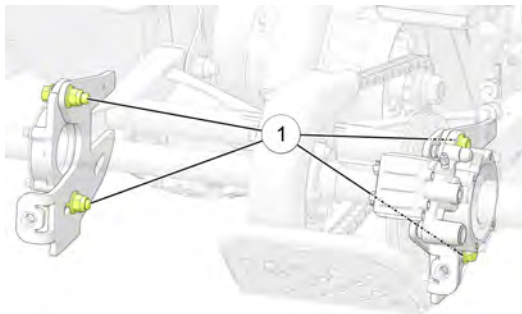

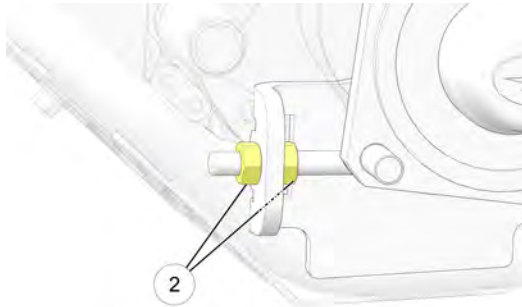

## NOTICE

RH side shown.

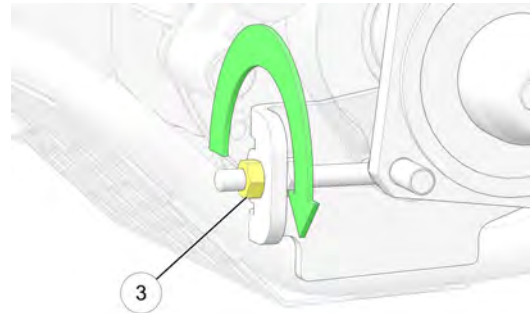

5. To tighten the chain tension slack, turn the outer jam nut ③ clockwise until chain tension is set to specification. Repeat step on other side of the vehicle.

Drive Chain Tension:  
**1/4"-1/2" (6-12 mm) Deflection**

## MAINTENANCE

---

6. Torque the outer jam nuts to specification.

### TORQUE

Eyelet Screw Jam Nuts  
**20 ft-lbs (27 N·m)**

### TORQUE

Wheel Lug Nuts  
**30 ft-lbs (40 N·m)**

7. Torque the four axle bearing housing fasteners to specification.

### TORQUE

Axle Bearing Housing Fasteners  
**37 ft-lbs (50 N·m)**

8. If removed, reinstall both rear tires and torque wheel nuts to specification.

## AIR FILTER

Inspect the air filter at the intervals outlined in the Periodic Maintenance Chart. In extremely dusty conditions, air filter replacement will be required more often. Access the air box under the seat.



1. Remove the seat ①.
2. Remove the two dart fasteners ② and flip open the cover.
3. Disengage the two cover latches ③ from the air box.

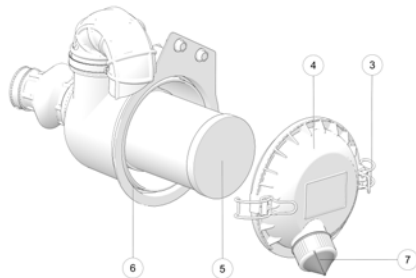

## MAINTENANCE

---

- Carefully remove the cover ④ from the air box.
- Remove the filter ⑤.
- Inspect the air box for oil or water deposits. Wipe away any deposits with a clean shop towel.

### NOTICE

If the filter has been soaked with fuel or oil it must be replaced.

- Inspect the air filter and replace if necessary.

### NOTICE

DO NOT attempt to clean the air filter with compressed air.

- Place the air filter into the air box and reinstall the air box cover with rubber outlet ⑦ turned downward.
- Engage the cover latches.
- Close the cover and re-insert the dart fasteners.
- Re-install the seat securely. See the Know Your ATV section, starting on page 45, for additional instruction on seat installation.

### IMPORTANT

To prevent dirt intrusion, ensure the O-ring ⑥ is installed properly within the rim of the air intake box before closing the hinges.

## HANDLEBAR ADJUSTMENT

### WARNING

Improper adjustment of the handlebars or incorrect torquing of the adjuster block tightening bolts can cause limited steering or loosening of the handlebars, resulting in loss of control and possible serious personal injury or death. Follow the adjustment procedures exactly, or see your POLARIS dealer or other qualified service person for service.

The handlebars can be adjusted for rider preference.

1. Remove the two dart fasteners from the headlight pod.
2. Remove pod to access the handlebar bolts
  - ①. Loosen the four bolts.

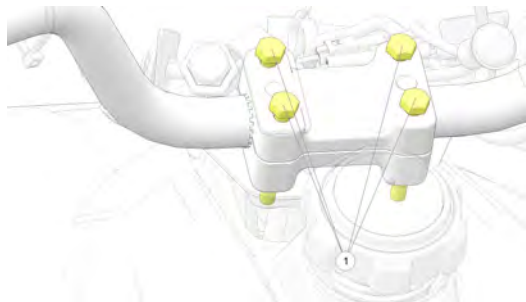

2. Adjust the handlebar to the desired height. Be sure the handlebars do not hit the gas tank or any other part of the vehicle when turned fully to the left or right.
3. Lightly tighten each bolt equally to the specified torque to prevent uneven gaps in the block.

## MAINTENANCE

---

### TORQUE

Handlebar Bolts  
**7.3 ft-lbs (10 N·m)**

## TIRES



### WARNING

Operating your ATV with worn tires, improperly inflated tires, non-standard tires or improperly installed tires will affect vehicle handling and could cause an accident resulting in serious injury or death. Tires age, even if they have not been used or have only been used occasionally. Cracking of the tread and sidewall rubber, sometimes accompanied by carcass deformation, is evidence of aging. Old and aged tires must be checked by tire specialists to ascertain their suitability for further use. Always follow all tire maintenance procedures as outlined in this manual and on the labels on the vehicle. Always use original equipment size and type when replacing tires.



## TIRE TREAD DEPTH

Always replace tires when tread depth is worn to 1/8" (3 mm) ① or less.

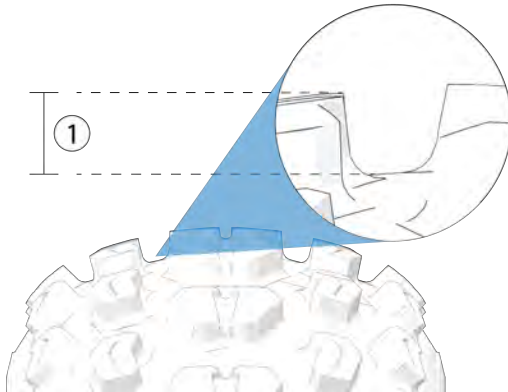

## MAINTENANCE

---

### WHEEL REMOVAL

1. Stop the engine and lock the parking brake.
2. Loosen the wheel bolts ① slightly.
3. Elevate the side of the vehicle by placing a suitable stand under the footrest frame.
4. Remove the wheel nuts and remove the wheel.

### WHEEL INSTALLATION

1. Lock the parking brake.
2. Place the wheel in the correct position on the wheel hub. Be sure the valve stem is toward the outside and rotation arrows on the tire point toward forward rotation.

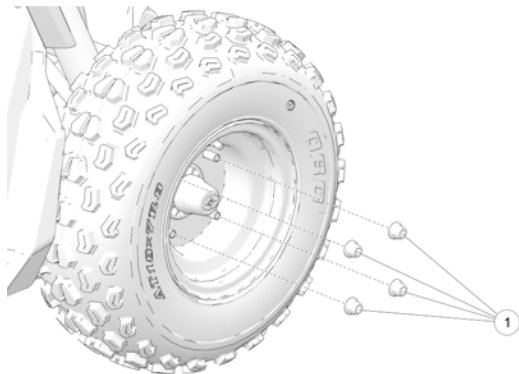

3. Install the lug nuts ① and finger tighten them.
4. Lower the vehicle to the ground.
5. Torque the four wheel lugs to specification.

## TORQUE

Wheel Lug Nuts  
**30 ft-lbs (40 N·m)**

## WHEEL HUB TIGHTENING

Front and rear wheel axle bearing tightness and spindle nut retention are critical component operations. All service must be performed by your authorized Polaris dealer or other qualified service facility.

## AXLE AND WHEEL NUTS

Do not service axle nuts that have a cotter pin installed. Your Polaris dealer can assist.

## MAINTENANCE

---

# LAMP LIGHT REPLACEMENT

## DAYTIME RUNNING LIGHTS

### *NOTICE*

The LED running lights are not serviceable. If the lights do not operate, a replacement headlight assembly is required. See your authorized Polaris dealer for replacement parts and service.

1. Remove the six dart fasteners from the front cover and detach.

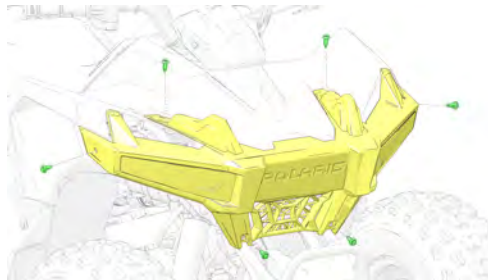

2. Disconnect the lights ① from the harness.

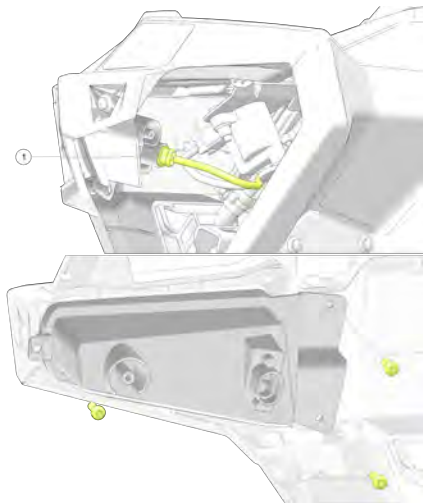

3. Remove the three screws from each headlight.
4. To reinstall the light, repeat these steps in reverse.

### CHECK ENGINE INDICATOR LIGHT

1. Remove the handlebar cover or pod to access the lamp.
2. Remove the indicator wire connections from the harness.
3. Remove the nut from the back side of the indicator lamp.
4. Reverse the steps to reinstall all components.

# MAINTENANCE

---

## TAIL LIGHT

The LED tail light is not serviceable. If the light does not operate, a replacement tail light assembly is required. See your authorized Polaris dealer for replacement parts and service.

1. Disconnect the light ① from the assembly.
2. Remove the two nuts securing the tail light to the frame. The nuts are located under the rear rack.
3. Remove the assembly and replace.
4. Repeat above steps in reverse for installation.
5. Test the light for proper operation.

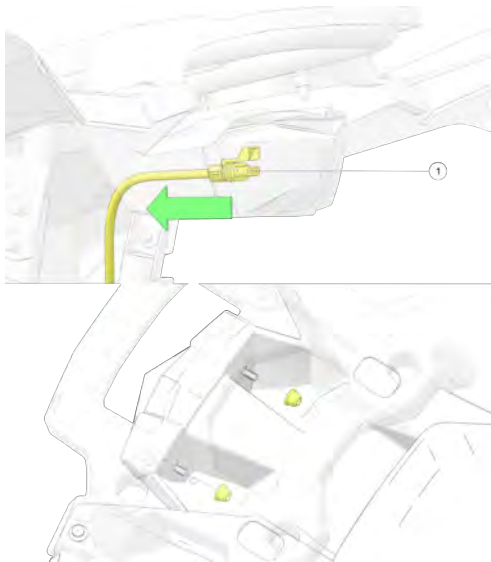

---

## BATTERY

 WARNING

Improperly connecting or disconnecting battery cables can result in an explosion and cause serious injury or death. When removing the battery, always disconnect the negative (black) cable first. When reinstalling the battery, always connect the negative (black) cable last.

## MAINTENANCE

---

The battery ① in your Polaris ATV is a sealed battery. The sealing strip cannot be removed. Never add water to this type of battery.

Keep the battery terminals and connections free of corrosion. If cleaning is necessary, remove the corrosion with a stiff wire brush. Wash with a solution of one tablespoon baking soda and one cup water. Rinse well with tap water and dry off with clean shop towels. Coat the terminals with dielectric grease or petroleum jelly to reduce oxidation and excessive power consumption.

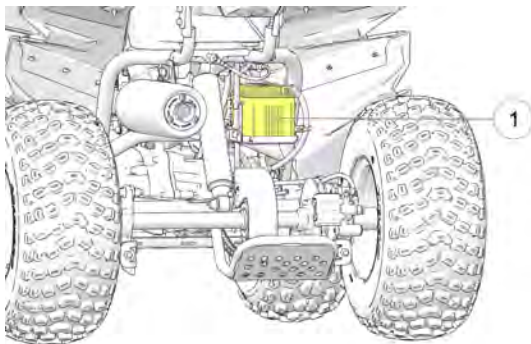

## BATTERY REMOVAL

1. Remove the battery hold-down strap.
2. Remove battery cover.
3. Disconnect the black (negative) battery cable first.



4. Disconnect the red (positive) battery cable next.
5. Lift the battery out of the ATV.

### **BATTERY INSTALLATION AND CONNECTIONS**

Always install a fully charged battery. Using a new battery that has not been fully charged can damage the battery and result in a shorter life. It can also hinder vehicle performance. If recharging is necessary, use a .5 amp battery charger

1. Ensure battery pad is properly installed in the tray.
2. Set the battery in its holder.
3. Coat the terminals with dielectric grease or petroleum jelly.
4. Connect and tighten the red (positive) cable first.
5. Connect and tighten the black (negative) cable last.
6. Install battery cover.

## MAINTENANCE

---

7. Attach hold-down strap.
8. Verify that cables are properly routed.

## AGM BATTERY MAINTENANCE AND CHARGING



### WARNING

An overheated battery may explode, causing severe injury or death. Always watch charging times carefully. Stop charging if the battery becomes very warm to the touch. Allow it to cool before resuming charging.

### **AGM BATTERY MAINTENANCE**

The sealed battery is already filled with electrolyte and has been sealed and *fully charged* at the factory. *Never* pry the sealing strip off or add any other fluid to this battery.

The single most important thing about maintaining a sealed battery is to keep it fully charged. Check the battery voltage with a voltmeter or multimeter. A fully charged battery will register 12.8 V or higher. If the voltage falls below 12.5V, charge it immediately, or the battery runs the risk of sulfation and reduced battery life.

If you do not drive the vehicle for more than TWO WEEKS, Polaris recommends using a BatteryMINDER® 2012 AGM - 2 AMP charger (PN 2830438), which can be ordered through your dealer. During charging, place the charger outside of the vehicle and protect it from moisture.

To connect a trickle charge to your vehicle's battery, perform the following steps:

1. Locate battery charge port ①.
2. Connect port to charger and place charger outside vehicle in a dry location.
3. Allow battery to attain a full charge.
4. Disconnect charger from port. Re-install seat.

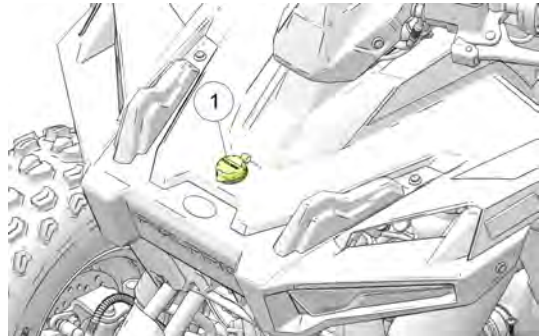

## MAINTENANCE

---

### **AGM BATTERY CHARGING**

If you plan to store the vehicle for ONE MONTH or longer, remove the battery from the vehicle, then store the battery in a cool and dry location.

Continue to maintain the battery with the BatteryMINDER® 2012 AGM - 2 AMP charger. When using an automatic charger other than a BatteryMINDER 2012-AGM - 2 AMP charger, refer to the charger manufacturer's instructions for recharging.

If using a **constant current charger** (instead of BatteryMINDER® 2012 AGM - 2 AMP charger), use the guidelines below. Always verify battery condition before and 1-2 hours after the end of charging.

State of Charge	Voltage (DC)	Action	Charge Time*
100%	12.8-13.0 volts	None, check monthly	None required
75%-100%	12.6-12.8 volts	May need slight charge, if no charge given, check in 2 weeks	3-6 hours
50%-75%	12.3-12.6 volts	Needs charge	5-11 hours
25%-50%	12.0-12.3 volts	Needs charge	At least 13 hours

0%-25%	12.0 volts or less	Needs charge	At least 20 hours
* Using AGM specific charger at standard amps specified on top of battery			

## BATTERY STORAGE

Whenever the vehicle is not used for a period of three months or more, remove the battery from the vehicle, ensure that it's fully charged, and store it out of the sun in a cool, dry place. Check battery voltage each month during storage and recharge as needed to maintain a full charge.

## MAINTENANCE

---

### CLEANING

#### WASHING THE VEHICLE

The best and safest way to clean your POLARIS vehicle is with a garden hose and a pail of mild soap and water.

1. Use a professional-type washing cloth, cleaning the upper body first and the lower parts last.
2. Rinse with clean water frequently.
3. Dry surfaces with a chamois to prevent water spots.

If a high pressure water system is used for cleaning (not recommended), exercise extreme caution. The water may damage components and could remove paint and decals. Avoid directing the water stream at the following items:

- Wheel bearings
- Radiator
- Transmission seals
- Brakes
- Cab and body panels
- Labels and decals

If warning and safety labels are damaged, contact your POLARIS dealer for free replacement.

Grease all zerk fittings immediately after washing. Allow the engine to run for a while to evaporate any water that may have entered the engine or exhaust system.

### WASHING TIPS

- Avoid the use of harsh cleaners, which can scratch the finish.
- Do not use a power washer to clean the vehicle.
- Do not use medium to heavy duty compounds on the finish.
- Always use clean cloths and pads for cleaning and polishing. Old or reused cloths and pads may contain dirt particles that will scratch the finish.

### POLISHING

It is recommended to use common household aerosol furniture polish for polishing the finish on your Polaris vehicle. Follow the instructions on the container.

- Avoid the use of automotive products, some of which can scratch the finish of your vehicle.
- Always use clean cloths and pads for cleaning and polishing. Old or reused cloths and pads may contain dirt particles that will scratch the finish.

### STORAGE

#### EXTERIOR

Make necessary repairs and clean the vehicle as recommended. See page 148.

#### BATTERY STORAGE

Remove the battery from the vehicle, ensure that it's fully charged, and store it out of the sun in a cool, dry place. Check battery voltage each month during storage and recharge as needed to maintain a full charge.

## MAINTENANCE

---

### STABILIZE THE FUEL

1. Fill the fuel tank with the recommended fuel.
2. Add Polaris Carbon Clean Fuel Treatment or Polaris Fuel Stabilizer or equivalent fuel treatments or stabilizers. Follow the instructions on the container for the recommended amount. Carbon Clean removes water from fuel systems, stabilizes fuel and removes carbon deposits from pistons, rings, valves and exhaust systems.
3. Allow the engine to run for 15-20 minutes to allow the stabilizer to disperse through the entire fuel delivery system.

### FOG THE ENGINE

1. Treat the fuel system with Polaris Carbon Clean. Follow the instructions on the container. Start the engine. Allow it to idle for several minutes so the Carbon Clean reaches the injectors. Stop the engine.
2. Remove the spark plug and add 2-3 tablespoons of engine oil. To access the plug hole, use a section of clear 1/4" hose and a small plastic squeeze bottle filled with the pre-measured amount of oil.
3. Reinstall the spark plug. Torque to specification. See page 114.
4. Apply dielectric grease to the inside of the spark plug cap. Do not reinstall the cap onto the plug at this step.



5. Turn the engine over several times. Oil will be forced in and around the piston rings and ring lands, coating the cylinder with a protective film of fresh oil.
6. If Polaris fuel system additive is not used, fuel tank, fuel lines, and injectors should be completely drained of gasoline.
7. Reinstall the spark plug cap to the spark plug.

### ENGINE OIL

Change the oil. See page 106.

### AIR FILTER / AIR BOX

Inspect and clean (or replace) the air filter. Clean the air box. Drain the sediment tube. See page 131.

### FLUID LEVELS

Inspect fluid levels. Change fluids as recommended in the Periodic Maintenance Chart beginning on page 92.

- Transmission Oil
- Engine Oil

### LUBRICATE

Inspect all cables and lubricate all areas of the vehicle as recommended in the Periodic Maintenance Chart beginning on page 92.

### STORAGE AREA / COVERS

1. Make sure tire pressure is at specification.
2. Using suitable supports under the frame, raise the vehicle slightly so that the tires are not touching the ground.

## MAINTENANCE

---

3. Be sure the storage area is well ventilated.
4. Cover the vehicle with an appropriate cover. Do not use plastic or coated materials. They do not allow enough ventilation to prevent condensation, and may promote corrosion and oxidation.

## TRANSPORTING THE ATV

1. Stop the engine and lock the parking brake.
2. Secure the fuel cap, oil cap and seat.

### *NOTICE*

Always tie the frame of the ATV to the transporting unit securely with suitable straps or rope. The rack, bumper or handlebars do not offer enough support for tie-down while transporting. For high-speed trailering, it is recommended to remove the safety flag.

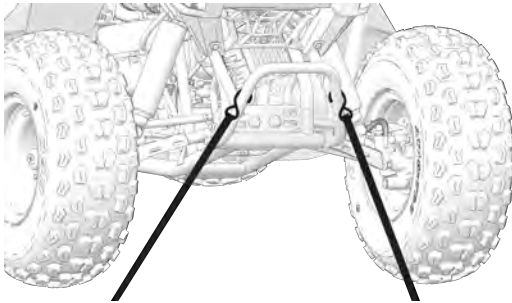

3. Secure the front tie strap to the frame tubes using S-hooks. Do not attach to the plastic bumper.
4. Secure the rear tie strap to the ATV by attaching an S-hook to the slot on each axle bearing.

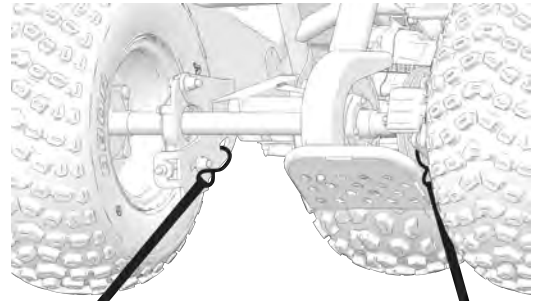

### *NOTICE*

When securing the rear of the ATV, do not cross or overtighten the straps. Crossing and overtightening the rear straps could cause damage to the bearings.



---

# SPECIFICATIONS

## OUTLAW 70

POLARIS OUTLAW 70	
Rider Capacity/Maximum Weight	1 Rider / 52 kg (115 lbs)
Dry Weight	126 kg (278 lbs)
Curb Weight	131.5 kg (290 lbs)
Length/Width/Height	141.4 cm (55.7") / 90.2 cm (35.5") / 89.3 cm (35.2")
Wheel Base	105 cm (41.5 in)
Ground Clearance	10 cm (4 in) at swing arm, 19.5 cm (7.7 in) at frame
Engine type	4-Stroke
Displacement	70cc
Cooling	Air Cooled

---

# SPECIFICATIONS

POLARIS OUTLAW 70	
Bore x Stroke	47 mm x 40.3 mm
Alternator Output	80 watts
Compression Ratio	10.1:1
Lubrication	Wet Sump
Oil Capacity	800 ml (27 oz)
Fuel Capacity	5.6 liters (1.5 gal)
Starting System	Electric
Fuel System	Electronic fuel injection
Throttle Body Size	22 mm
Ignition System	CDI
Ignition Timing	13° +/- 2° @ 1700 RPM

# SPECIFICATIONS

POLARIS OUTLAW 70	
Spark Plug / Gap	NGK® CR7HSA / 0.6-0.7 mm
Drive System Automatic	CVT
Final Drive	Chain
Front Suspension	Single A-arm with 10.2 cm (4 in) of travel
Rear Suspension	Swing arm with 10.2 cm (4 in) of travel
Front/Rear Brakes	Hydraulic Disk
Parking Brake	Mechanical Lock
Front Tires	18 x 7 - 8 (27.6 kPa / 4 psi)
Rear Tires	18 x 7 - 8 (27.6 kPa / 4 psi)
Brake Light	Standard
Daytime Running Lights	Standard





---

**POLARIS PRODUCTS**  
**ENGINE LUBRICANT**

PART NUMBER	DESCRIPTION
2870791	Fogging Oil (12 oz. Aerosol)
2878920	PS-4 Extreme Duty Synthetic 10W-50 4-Cycle Oil (qt./ .95 l)
2878919	PS-4 Extreme Duty Synthetic 10W-50 4-Cycle Oil (gal./ 3.8 l)

## GEARCASE / TRANSMISSION LUBRICANTS

PART NUMBER	DESCRIPTION
2878068	AGL Full Synthetic Gearcase Lubricant & Transmission Fluid (qt./.95 l)
2878069	AGL Full Synthetic Gearcase Lubricant & Transmission Fluid (gal./3.8 l)
2872348	Chain Lube, Aerosol

## GREASE

PART NUMBER	DESCRIPTION
2871322	All Season Grease (3 oz./89 ml cartridge)
2871423	All Season Grease (14 oz./414 ml cartridge)

---

**ADDITIVES / MISCELLANEOUS**

PART NUMBER	DESCRIPTION
2871326	Carbon Clean



---

## TROUBLESHOOTING

### ENGINE DOESN'T TURN OVER

POSSIBLE CAUSE	SOLUTION
Low battery voltage	Recharge the battery to 12.8 VDC.
Loose battery connections	Check all connections and tighten.
Loose solenoid connections	Check all connections and tighten.

### ENGINE TURNS OVER, FAILS TO START

POSSIBLE CAUSE	SOLUTION
Out of fuel	Refuel, cycle key to ON position three times for 5 seconds each, then start.
Water is present in fuel	Drain the fuel system and refuel.
Old or non-recommended fuel	Replace with fresh recommended fuel.

## TROUBLESHOOTING

---

POSSIBLE CAUSE	SOLUTION
Fouled or defective spark plug	Inspect plug and replace if necessary.
No spark to spark plug	Inspect plug and replace if necessary.
Water or fuel in crankcase	Your POLARIS dealer can assist.
Clogged Fuel Filter	Your POLARIS dealer can assist.
Low battery voltage	Recharge the battery to 12.8 VDC.
Mechanical failure	Your POLARIS dealer can assist.

## ENGINE PINGS OR KNOCKS

POSSIBLE CAUSE	SOLUTION
Poor quality or low octane fuel	Replace with recommended fuel.
Incorrect ignition timing	Your authorized dealer can assist.
Incorrect spark plug gap or heat range	Set gap to specs or replace plugs.

---

---

**ENGINE RUNS IRREGULARLY, STALLS OR MISFIRES**

POSSIBLE CAUSE	SOLUTION
Fouled or defective spark plug(s)	Inspect, clean and/or replace spark plugs.
Worn or defective spark plug wires	Your POLARIS dealer can assist.
Incorrect spark plug gap or heat range	Set gap to specs or replace plugs.
Loose ignition connections	Check all connections and tighten.
Water present in fuel	Replace with new fuel.
Low battery voltage	Recharge battery to 12.8 VDC.
Kinked or plugged fuel tank vent line	Inspect and replace.
Incorrect fuel	Replace with recommended fuel.
Clogged air filter	Inspect and clean or replace.

## TROUBLESHOOTING

---

<b>POSSIBLE CAUSE</b>	<b>SOLUTION</b>
Throttle release switch malfunction	Your POLARIS dealer can assist.
Other mechanical failure	Your POLARIS dealer can assist.

<b>POSSIBLE LEAN FUEL CAUSE</b>	<b>SOLUTION</b>
Low or contaminated fuel	Add or change fuel, clean the fuel system.
Kinked or plugged fuel tank vent line	Inspect and replace.
Low octane fuel	Replace with recommended fuel.
Clogged air filter	Your POLARIS dealer can assist.
Incorrect fuel	Replace with recommended fuel.



---

**ENGINE STOPS OR LOSES POWER**

POSSIBLE CAUSE	SOLUTION
Out of fuel	Refuel, cycle key to ON position three times for 5 seconds each, then start.
Kinked or plugged fuel vent line	Inspect and replace.
Water is present in fuel	Replace with new fuel.
Fouled or defective spark plug(s)	Inspect, clean and/or replace spark plugs.
Worn or defective spark plug wires	Your POLARIS dealer can assist.
Incorrect spark plug gap or heat range	Set gap to specs or replace plug.
Loose ignition connections	Check all connections and tighten.
Low battery voltage	Recharge the battery to 12.8 VDC.
Incorrect fuel	Replace with fresh recommended fuel.
Clogged air filter	Inspect and clean or replace.

## TROUBLESHOOTING

---

POSSIBLE CAUSE	SOLUTION
Throttle release switch malfunction	Your POLARIS dealer can assist.
Overheated engine	Clean engine exterior. Your POLARIS dealer can assist.
Other mechanical failure	Your POLARIS dealer can assist.

## WARRANTY

### LIMITED WARRANTY

POLARIS Industries Inc., 2100 Highway 55, Medina, MN 55340 (POLARIS) gives a SIX MONTH LIMITED WARRANTY on all components of your POLARIS vehicle against defects in material or workmanship. POLARIS further warrants that the spark arrester in this product will meet the efficiency requirements of USFS standard 5100-1C for at least 1000 hours when subjected to normal use and when maintenance and installation are in accordance with POLARIS recommendations.

This warranty covers parts and labor charges for repair or replacement of defective parts and begins on the date of purchase by the original retail purchaser. This warranty is transferable to another owner during the warranty period through a POLARIS dealer, or other qualified person, but any such transfer will not extend the original term of the warranty. The duration of this warranty may vary by international region based upon local laws and regulations.

## WARRANTY

---

### REGISTRATION

At the time of sale, the Warranty Registration Form must be completed by your dealer and submitted to POLARIS within ten days of purchase. Upon receipt of this registration, POLARIS will record the registration for warranty. No verification of registration will be sent to the purchaser as the copy of the Warranty Registration Form will be your proof of warranty coverage. If you have not signed the original registration and received the customer copy, please contact your dealer immediately. **NO WARRANTY COVERAGE WILL BE ALLOWED UNLESS YOUR VEHICLE IS REGISTERED WITH POLARIS.** Initial dealer preparation and set-up of your vehicle is very important in ensuring trouble-free operation. Purchasing a machine in the crate or without proper dealer set-up will void your warranty coverage.

### WARRANTY COVERAGE AND EXCLUSIONS

#### LIMITATIONS OF WARRANTIES AND REMEDIES

This POLARIS limited warranty excludes any failures that are not caused by a defect in material or workmanship. **THIS WARRANTY DOES NOT COVER CLAIMS OF DEFECTIVE DESIGN.** This warranty also does not cover acts of God, accidental damage, normal wear and tear, abuse or improper handling. This warranty also does not cover any vehicle, component, or part that has been altered structurally, modified, neglected, improperly maintained or used for racing, competition or purposes other than for which it was designed.

This warranty excludes damages or failures resulting from improper lubrication; improper engine timing; improper fuel; surface imperfections caused by external stress, heat, cold or contamination; operator error or abuse; improper component alignment, tension, adjustment or altitude compensation; snow, water, dirt or other foreign substance ingestion/contamination; improper maintenance; modified components; use of aftermarket or unapproved components, accessories, or attachments; use of unapproved software or calibration; unauthorized repairs; or repairs made after the warranty period expires or by an unauthorized repair center.

This warranty excludes damages or failures caused by abuse, accident, fire, or any other cause other than a defect in materials or workmanship and provides no coverage for consumable components, general wear items, or any parts exposed to friction surfaces, stresses, environmental conditions and/or contamination for which they were not designed or not intended, including but not limited to the following items:

## WARRANTY

---

- Wheels and tires
- Suspension components
- Brake components
- Seat components
- Clutches and components
- Steering components
- Batteries
- Light bulbs/Sealed beam lamps
- Filters
- Lubricants
- Bushings
- Finished and unfinished surfaces
- Carburetor/Throttle body components
- Engine components
- Drive belts
- Hydraulic components and fluids
- Circuit breakers/Fuses
- Electronic components
- Spark plugs
- Sealants
- Coolants
- Bearings

## LUBRICANTS AND FLUIDS

1. Mixing oil brands or using non-recommended oil may cause engine damage. We recommend the use of POLARIS engine oil.
2. Damage or failure resulting from the use of non-recommended lubricants or fluids is not covered by this warranty.

This warranty provides no coverage for personal loss or expense, including mileage, transportation costs, hotels, meals, shipping or handling fees, product pick-up or delivery, replacement rentals, loss of product use, loss of profits, or loss of vacation or personal time.

THE EXCLUSIVE REMEDY FOR BREACH OF THIS WARRANTY SHALL BE, AT POLARIS' OPTION, REPAIR OR REPLACEMENT OF ANY DEFECTIVE MATERIALS, COMPONENTS, OR PRODUCTS. THE REMEDIES SET FORTH IN THIS WARRANTY ARE THE ONLY REMEDIES AVAILABLE TO ANY PERSON FOR BREACH OF THIS WARRANTY. POLARIS SHALL HAVE NO LIABILITY TO ANY PERSON FOR INCIDENTAL, CONSEQUENTIAL OR SPECIAL DAMAGES OF ANY DESCRIPTION, WHETHER ARISING OUT OF EXPRESS OR IMPLIED WARRANTY OR ANY OTHER CONTRACT, NEGLIGENCE, OR OTHER TORT OR OTHERWISE. THIS EXCLUSION OF CONSEQUENTIAL, INCIDENTAL, AND SPECIAL DAMAGES IS INDEPENDENT FROM AND SHALL SURVIVE ANY FINDING THAT THE EXCLUSIVE REMEDY FAILED OF ITS ESSENTIAL PURPOSE.

## WARRANTY

---

THE IMPLIED WARRANTY OF FITNESS FOR A PARTICULAR PURPOSE IS EXCLUDED FROM THIS LIMITED WARRANTY. ALL OTHER IMPLIED WARRANTIES (INCLUDING BUT NOT LIMITED TO THE IMPLIED WARRANTY OF MERCHANTABILITY) ARE LIMITED IN DURATION TO THE ABOVE SIX MONTH WARRANTY PERIOD. POLARIS DISCLAIMS ALL EXPRESS WARRANTIES NOT STATED IN THIS WARRANTY. SOME STATES DO NOT PERMIT THE EXCLUSION OR LIMITATION OF INCIDENTAL OR CONSEQUENTIAL DAMAGES OR ALLOW LIMITATIONS ON THE DURATION OF IMPLIED WARRANTIES, SO THE ABOVE LIMITATIONS MAY NOT APPLY TO YOU IF INCONSISTENT WITH CONTROLLING STATE LAW.

## HOW TO OBTAIN WARRANTY SERVICE

If your vehicle requires warranty service, you must take it to a POLARIS Servicing Dealer. When requesting warranty service you must present your copy of the Warranty Registration Form to the dealer. (THE COST OF TRANSPORTATION TO AND FROM THE DEALER IS YOUR RESPONSIBILITY.) POLARIS suggests that you use your original selling dealer; however, you may use any POLARIS Servicing Dealer to perform warranty service.

*In the Country where your product was purchased:*



Warranty or Service Bulletin repairs must be done by an authorized POLARIS dealer. If you move or are traveling within the country where your product was purchased, Warranty and Service Bulletin repairs may be requested from any authorized POLARIS dealer that sells the same line as your product.

*Outside the Country where your product was purchased:*

If you are traveling temporarily outside the country where your product was purchased, you should take your product to an authorized POLARIS dealer. You must show the dealer photo identification from the country of the selling dealer's authorized location as proof of residence. Upon residence verification, the servicing dealer will be authorized to perform the warranty repair.

*If you move:*

If you move to another country, be sure to contact POLARIS Customer Assistance and the customs department of the destination country before you move. Product importation rules vary considerably from country to country. You may be required to present documentation of your move to POLARIS in order to continue your warranty coverage. You may also be required to obtain documentation from POLARIS in order to register your product in your new country. You should warranty register your product at a local POLARIS dealer in your new country immediately after you move to continue your warranty coverage and to ensure that you receive information and notices regarding your vehicle.

## WARRANTY

---

*If you purchase from a private party:*

If you purchase a POLARIS product from a private party, to be kept and used outside of the country in which the product was originally purchased, all warranty coverage will be denied. You must nonetheless register your product under your name and address with a local POLARIS dealer in your country to ensure that you receive safety information and notices regarding your product.

## EXPORTED PRODUCTS

EXCEPT WHERE SPECIFICALLY REQUIRED BY LAW, THERE IS NO WARRANTY OR SERVICE BULLETIN COVERAGE ON THIS PRODUCT IF IT IS SOLD OUTSIDE THE COUNTRY OF THE SELLING DEALER'S AUTHORIZED LOCATION. This policy does not apply to products that have received authorization for export from POLARIS. Dealers may not give authorization for export. You should consult an authorized dealer to determine this product's warranty or service coverage if you have any questions. This policy does not apply to products registered to government officials or military personnel on assignment outside the country of the selling dealer's authorized location. This policy does not apply to Safety Bulletins.

## NOTICE

If your product is registered outside of the country where it was purchased and you have not followed the procedure set above, your product will no longer be eligible for warranty or service bulletin coverage of any kind, other than safety bulletins. Products registered to government officials or military personnel on assignment outside of the country where the product was purchased will continue to be covered by the Limited Warranty.

Please work with your dealer to resolve any warranty issues. Dealership contacts can be found via this website, if needed:

**[www.polaris.com/en-us/contact](http://www.polaris.com/en-us/contact)**

Should your dealer require any additional assistance, they will contact the appropriate person at POLARIS.

This warranty gives you specific legal rights, and you may also have other rights which vary from state to state or in different countries. If any of the above terms are void because of federal, state, local law, all other warranty terms will remain in effect.

***For questions call POLARIS Customer Assistance:***

United States & Canada: 1-800-POLARIS (1-800-765-2747)

## WARRANTY

---

French: 1-800-268-6334

To report a safety defect to Transport Canada, you may either fill out an online defect complaint form at their website:

English: <http://www.tc.gc.ca/recalls>

French: <http://www.tc.gc.ca/rappels>

Or contact their Defect Investigations and Recalls Division by calling toll-free 1- 800-333-0510 (Canada) or 819-994-3328 (Ottawa-Gatineau area / International).

## **U.S.A. EPA EMISSIONS LIMITED WARRANTY**

This emissions limited warranty is in addition to the POLARIS standard limited warranty for your vehicle. POLARIS Industries Inc. warrants that at the time it is first purchased, this emissions-certified vehicle is designed, built and equipped so it conforms with applicable U.S. Environmental Protection Agency emission regulations. POLARIS warrants that the vehicle is free from defects in materials and workmanship that would cause it to fail to meet these regulations.

The warranty period for off road vehicles 100cc or greater emissions-certified vehicles starts on the date of purchase by original retail purchaser and continues for a period of 500 hours of engine operation, 5000 kilometers (3100 miles) of vehicle travel, or 30 calendar months from the date of purchase, whichever comes first. The warranty period for ATVs less than 100cc emissions-certified vehicles starts on the date of purchase by original retail purchaser and continues for a period of 250 hours of engine operation, 2500 kilometers (1550 miles) of vehicle travel, or 30 calendar months from the date of purchase, whichever comes first. This EPA emissions warranty period is extended for at least as long as the standard factory warranty that Polaris provides on the vehicle as a whole. The EPA emissions warranty period does not further extend if you purchase additional warranty coverage in the form of a service contract or other paid warranty extension, but emission-related parts may be covered subject to the terms of any such paid service contract or paid warranty extension.

This emissions limited warranty covers components whose failure increases the vehicle's regulated emissions, and it covers components of systems whose only purpose is to control emissions. Repairing or replacing other components not covered by this warranty is the responsibility of the vehicle owner. This emissions limited warranty does not cover components whose failure does not increase the vehicle's regulated emissions.

For exhaust emissions, emission-related components include any engine parts related to the following systems:

## WARRANTY

---

- Air-induction system
- Fuel system
- Ignition system
- Exhaust gas recirculation systems

The following parts are also considered emission-related components for exhaust emissions:

- Aftertreatment devices
- Crankcase ventilation valves
- Sensors
- Electronic control units

The following parts are considered emission-related components for evaporative emissions:

- Fuel Tank
- Fuel Cap
- Fuel Line
- Fuel Line Fittings
- Clamps\*
- Pressure Relief Valves\*
- Control Valves\*
- Control Solenoids\*
- Electronic Controls\*
- Vacuum Control Diaphragms\*
- Control Cables\*
- Control Linkages\*
- Purge Valves
- Vapor Hoses
- Liquid/Vapor Separator
- Carbon Canister
- Canister Mounting Brackets
- EFI Purge Port Connector

\*As related to the evaporative emission control system.

## WARRANTY

---

Emission-related components also include any other part whose only purpose is to reduce emissions or whose failure will increase emissions without significantly degrading engine/equipment performance. The exclusive remedy for breach of this limited warranty shall be, at the exclusive option of POLARIS, repair or replacement of any defective materials, components or products. THE REMEDIES SET FORTH IN THIS LIMITED WARRANTY ARE THE ONLY REMEDIES AVAILABLE TO ANY PERSON FOR BREACH OF THIS WARRANTY. POLARIS SHALL HAVE NO LIABILITY TO ANY PERSON FOR INCIDENTAL, CONSEQUENTIAL OR SPECIAL DAMAGES OF ANY DESCRIPTION, WHETHER ARISING OUT OF EXPRESS OR IMPLIED WARRANTY OR ANY OTHER CONTRACT, NEGLIGENCE OR OTHER TORT OR OTHERWISE. THIS EXCLUSION OF CONSEQUENTIAL, INCIDENTAL, AND SPECIAL DAMAGES IS INDEPENDENT FROM AND SHALL SURVIVE ANY FINDING THAT THE EXCLUSIVE REMEDY FAILED OF ITS ESSENTIAL PURPOSE.

ALL IMPLIED WARRANTIES (INCLUDING BUT NOT LIMITED TO ANY IMPLIED WARRANTIES OF MERCHANTABILITY AND FITNESS FOR A PARTICULAR PURPOSE) ARE LIMITED IN DURATION TO THE WARRANTY PERIOD DESCRIBED HEREIN. POLARIS DISCLAIMS ALL EXPRESS WARRANTIES NOT STATED IN THIS WARRANTY. Some states do not allow limitations on how long an implied warranty lasts, so the above limitation may not apply if it is inconsistent with the controlling state law.



This limited warranty excludes failures not caused by a defect in material or workmanship. This limited warranty does not cover damage due to accidents, abuse or improper handling, maintenance or use. This limited warranty also does not cover any engine that has been structurally altered, or when the vehicle has been used in racing competition. This limited warranty also does not cover physical damage, corrosion or defects caused by fire, explosions or other similar causes beyond the control of POLARIS.

Owners are responsible for performing the scheduled maintenance identified in the owner's manual. POLARIS may deny warranty claims for failures that have been caused by the owner's or operator's improper maintenance or use, by accidents for which POLARIS has no responsibility, or by acts of God.

Any qualified repair shop or person may maintain, replace, or repair the emission control devices or systems on your vehicle. An authorized POLARIS dealer, or other qualified person, can perform any service that may be necessary for your vehicle. POLARIS also recommends POLARIS parts, however equivalent parts may be used for such service. It is a potential violation of the Clean Air Act if a part supplied by an aftermarket parts manufacturer reduces the effectiveness of the vehicle's emission controls. Tampering with emission controls is prohibited by federal law.

## WARRANTY

---

### **CALIFORNIA RESIDENTS**

Certain POLARIS Off-Road Vehicles are available in 49-state and 50-state versions. Only the 50-state models are certified for sale in California. The 50-state models available for sale in California are identified by the letter “B” in the ninth position of the model number (e.g., R16RTE87B). The POLARIS 50-state models are designed and built with features such as a reduced cargo box capacity. Any modifications to these features may be a violation of the applicable California regulations and may void this limited emissions warranty offered by the manufacturer.

The California evaporative emissions control system limited warranty statement below applies to your Off Highway Recreational Vehicle in California if the vehicle is equipped with an evaporative emission control system and is labeled with a Vehicle Evaporative Emissions Control Information label indicating that the vehicle conforms to California evaporative emissions regulations applicable to new off-road sport vehicles, all-terrain vehicles, or off-road utility vehicles. These vehicles are referred to as “OHRV-EVAP” below.

### **CALIFORNIA EMISSION CONTROL WARRANTY STATEMENT YOUR WARRANTY RIGHTS AND OBLIGATIONS**

The California Air Resources Board and Polaris Industries Inc. is pleased to explain the emission control system warranty on your model year 2018 and newer Off Highway Recreational Vehicle. In California, new off-highway recreational vehicles must be designed, built and equipped to meet the State's stringent anti-smog standards. Polaris must warrant the emission control system on your OHRV-EVAP for the periods of time listed below provided there has been no abuse, neglect or improper maintenance of your OHRV-EVAP.

Your emission control system may include parts such as the carburetor or fuel injection system, fuel tank, fuel hoses, carbon canister, engine computer and Evaporative Emissions Control System parts listed in the U.S.A. EPA Emissions Limited Warranty. Also included may be hoses, belts, connectors and other emission-related assemblies. Where a warrantable condition exists, Polaris will repair your OHRV-EVAP at no cost to you including diagnosis, parts and labor.

### **MANUFACTURER'S WARRANTY COVERAGE:**

For model year 2018 and newer OHRV-EVAP models.

For 30 months, or 2500 miles, or 250 hours, whichever comes first, except for evaporative components over the OHRV high-priced warranty value, which is covered for 60 months, or 5000 miles, or 500 hours, whichever comes first. If any emission-related part on your OHRV-EVAP is defective, the part will be repaired or replaced by Polaris.

### **OWNER'S WARRANTY RESPONSIBILITIES:**

---

## WARRANTY

---

As the OHRV-EVAP owner, you are responsible for the performance of the required maintenance listed in your owner's manual. Polaris recommends that you retain all receipts covering maintenance on your OHRV-EVAP, but Polaris cannot deny warranty solely for the lack of receipts or for your failure to ensure the performance of a scheduled maintenance.

As an owner you are responsible for presenting your OHRV-EVAP to a Polaris dealer as soon as a problem exists. The warranty repairs should be completed in a reasonable amount of time, not to exceed 30 days.

As an OHRV-EVAP owner, you should also be aware that Polaris may deny you warranty coverage if your OHRV-EVAP or a part has failed due to abuse, neglect, improper maintenance or unapproved modifications.

### **ADD-ON OR MODIFIED PARTS**

An add-on or modified part must be compliant with applicable CARB emission control standards. A violation of this requirement is punishable by civil and/or criminal punishment.

If you have any questions regarding your warranty rights and responsibilities, you should contact Polaris Customer Assistance at 1-800-POLARIS (1-800-765-2747) or the California Air Resources Board at 9528 Telstar Avenue, El Monte, CA 91731.

United States & Canada: 1-800-POLARIS (1-800-765-2747)

---

French: 1-800-268-6334



---

**MAINTENANCE LOG****MAINTENANCE LOG**

Use the following chart to record periodic maintenance.

DATE	MILES (KM) OR HOURS	TECHNICIAN	SERVICE PERFORMED / COMMENTS





# MAINTENANCE LOG

---

DATE	MILES (KM) OR HOURS	TECHNICIAN	SERVICE PERFORMED / COMMENTS



---

## A

Additives /	
Miscellaneous.....	161
Age Restrictions .....	20
AGM Battery	
Maintenance and	
Charging .....	144
Air Filter .....	131
Alerts	
General .....	41
Auxiliary Foot Brake .....	122
Axle and Wheel Nuts .....	137

## B

Battery.....	141
Connections .....	143
Installation.....	143
Battery Removal .....	142

Battery Storage .....	147
Boots .....	39
Brake .....	61
Foot Brake .....	61
Hand Brake .....	61
Brake Freeplay.....	121
Brakes.....	121
Hand Brake .....	122
Lever Travel.....	121

## C

California Residents .....	184
Camber and Caster .....	124
Carrying a Passenger .....	23
Check Engine Indicator	
Light.....	139
Clothing .....	39
Clutch Cover Warning.....	44

Constant Variable	
Transmission (CVT)	
System.....	116
Crankcase Emission	
Control System .....	88
Crossing Hillsides .....	28
Cylinder Head Torque .....	112

## D

Daytime Running Lights ...	138
Declaration of Conformity ...	15
Descending Hills	
Improperly .....	27
Drive Chain .....	127
Drive Chain Lubrication ...	126
Driving Downhill.....	78
Driving on a Sidehill	
(Sidehilling).....	77

---

Driving on Slippery Surfaces.....	81
Driving Over Obstacles .....	82
Driving Procedure .....	74
Driving Through Water .....	83
Driving Uphill .....	76

## E

Electromagnetic Interference.....	88
Emissions Pollutants.....	87
Emissions Limited Warranty .....	178
Engine Doesn't Turn Over .....	163
Engine Loses Power.....	167
Engine Lubricant.....	159

Engine Oil Filter .....	108
Engine Pings or Knocks ...	164
Engine Runs Irregularly, Stalls or Misfires.....	165
Engine Stop Switch .....	58
Engine Stops .....	167
Engine Turns Over, Fails to Start .....	163
Equipment Modifications ...	17, 36
Exhaust Emission Control System .....	88
Exported Products .....	176
Exposure to Exhaust.....	21
Eye Protection.....	38

## F

Failure to Inspect Before Operating .....	22
Fuel System .....	64

## G

Gearcase / Transmission Lubricants.....	160
Gloves.....	39
Grease .....	160

## H

Handlebar Adjustment .....	133
Handling Gasoline.....	21
Hauling Cargo .....	84
Helmet.....	38

---

---

Horn.....	58
Hot Exhaust Systems.....	34
How To Obtain Warranty Service.....	174

## I

Ignition Switch.....	57
Improper Cargo Loading.....	33
Improper Hill Climbing.....	28
Improper Tires and Maintenance .....	31
Improper Vehicle Modifications .....	31
Indicator Light .....	63

## J

Jumps and Stunts .....	26
------------------------	----

## K

Know Your ATV .....	45
---------------------	----

## L

Lamp Light Replacement.....	138
Limited Warranty.....	169
Loss of Control .....	31
Lubrication Recommendations.....	102

## M

Maintenance Drive Chain Slack Adjustment.....	128
Maintenance Chart.....	92
Maintenance Chart Key .....	91
Maintenance Log .....	189
Making Turns .....	75
Messages to Parents, Supervising Adults, and Young Operators .....	7

## N

Noise Emission Control System.....	87
---------------------------------------	----

---

## O

Oil Change .....	106
Oil Check .....	104
Oil Filter .....	106
Operating at Excessive Speeds .....	25
Operating in Unfamiliar Terrain .....	30
Operating on Frozen Bodies of Water .....	32
Operating on Pavement.....	24- 25
Operating on Public Roads .....	24
Operating on Slippery Terrain .....	30
Operating on Steep Hills.....	27
Operating Over Obstacles...	29
Operating Without Instruction.....	20

Operation on Public Lands in the U.S.A. ....	87
Operation Warning .....	65
Outlaw 70 Specifications ..	155

## P

Parking Brake .....	62
Parking on a Hill or Incline...	80
Periodic Maintenance .....	89
Severe Use Definition .....	91
Physical Control of the ATV .....	26
Polishing .....	149
Pre-Ride Check .....	51
Pre-Ride Inspection .....	67
Protective Apparel.....	22

## R

Registration, Warranty .....	170
Riding Gear .....	53
Riding Rules .....	53

## S

Safe Operation Practices ....	70
Safe Riding Gear .....	37
Safety Labels Age / Tire Pressure / Load.....	42
Rack Alert .....	43
Safety Labels and Locations.....	40
Safety Training .....	35
Safety Warnings .....	19
Shock Spring Adjustment.....	125

---

Skidding.....	31
Sliding .....	31
Spark Arrester.....	117
Spark Plug .....	114
Speed Control .....	119
Speed Control System .....	120
Stalling While Climbing a Hill .....	29
Starting the Engine.....	72
Steering Inspection .....	124
Stopping the Engine .....	73
Storage.....	149

## T

Tail Light Replacement.....	140
Throttle Controls .....	59
Throttle Lever.....	60
Throttle Stop .....	120

Throttle System .....	119
Tire Tread Depth.....	135
Tires .....	134
Toe Alignment .....	123
Trademarks .....	3
Transmission (Main Gearcase).....	111
Transporting the ATV .....	152
Turning Around on a Hill .....	79

## U

Using Alcohol or Drugs.....	23
-----------------------------	----

## V

Vehicle Break-in Period .....	65
-------------------------------	----

Vehicle Identification Numbers .....	12
Vehicle Immersion.....	113

## W

Washing the Vehicle .....	148
Washing Tips .....	149
Wheel Hub Tightening.....	137
Wheel Removal .....	136
Wheels Installation.....	136





# **⚠️ WARNING**

**Improper vehicle use can result in  
SEVERE INJURY or DEATH.**



**ALWAYS USE  
AN APPROVED  
HELMET AND  
PROTECTIVE  
GEAR**



**NEVER USE  
ON PUBLIC  
ROADS**



**NEVER CARRY  
PASSENGERS**



**NEVER USE  
WITH DRUGS  
OR ALCOHOL**

**READ OWNER'S MANUAL.  
FOLLOW ALL INSTRUCTIONS AND WARNINGS.**

**NEVER** operate:

- without proper training or instruction
- at speeds too fast for your skills or the conditions
- on public roads - a collision can occur with another vehicle
- with a passenger - passengers affect balance and steering and increase risk of losing control

**ALWAYS:**

- use proper riding techniques to avoid vehicle overturns on hills and rough terrain and in turns
- avoid paved surfaces - pavement may seriously affect handling and control

**FOR YOUR NEAREST POLARIS DEALER,  
CALL 1-800-POLARIS (765-2747)  
OR VISIT [WWW.POLARIS.COM](http://WWW.POLARIS.COM)**

**POLARIS INDUSTRIES INC.  
2100 HIGHWAY 55  
MEDINA, MN 55340**

**POLARIS SALES EUROPE SARL  
PLACE DE L'INDUSTRIE 2  
1180 ROLLE, SWITZERLAND**

**PART NO. 9940367 REV 01  
PRINTED IN CHINA**

